



NORTH



TAKE WALL AWAY  
LAST HOUSE, IT  
NO FRONT SPAC

Nº98 AND Nº96  
HAVE 4/5 FT

NICE EVEN FENCE LINE IN THIS STREET  
NOT SO

MARKED IN RED BELOW AN 8FT  
ENCROACHMENT

Nº2

WHY

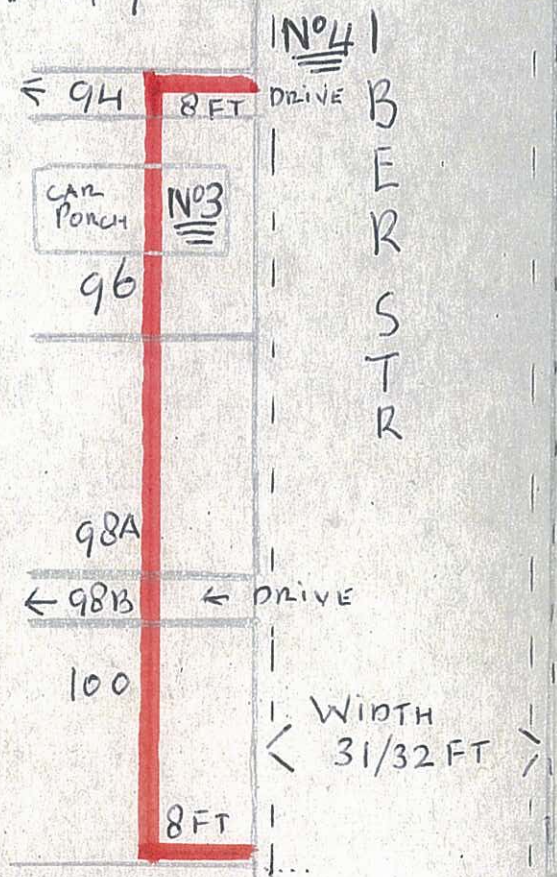

SOUTH  
Nº4

FOOT  
9 FT

LIFFEY STR  
CORNER  
SECTION

Nº2 ↑

Nº1 SIN SOUTH