

LA CLOCHE KAI

Wellington City Council Received:
09/06/2022

THESE DOCUMENTS MUST BE
KEPT ON SITE AND READ IN
CONJUNCTION WITH THE
CONSENT ADDENDA.

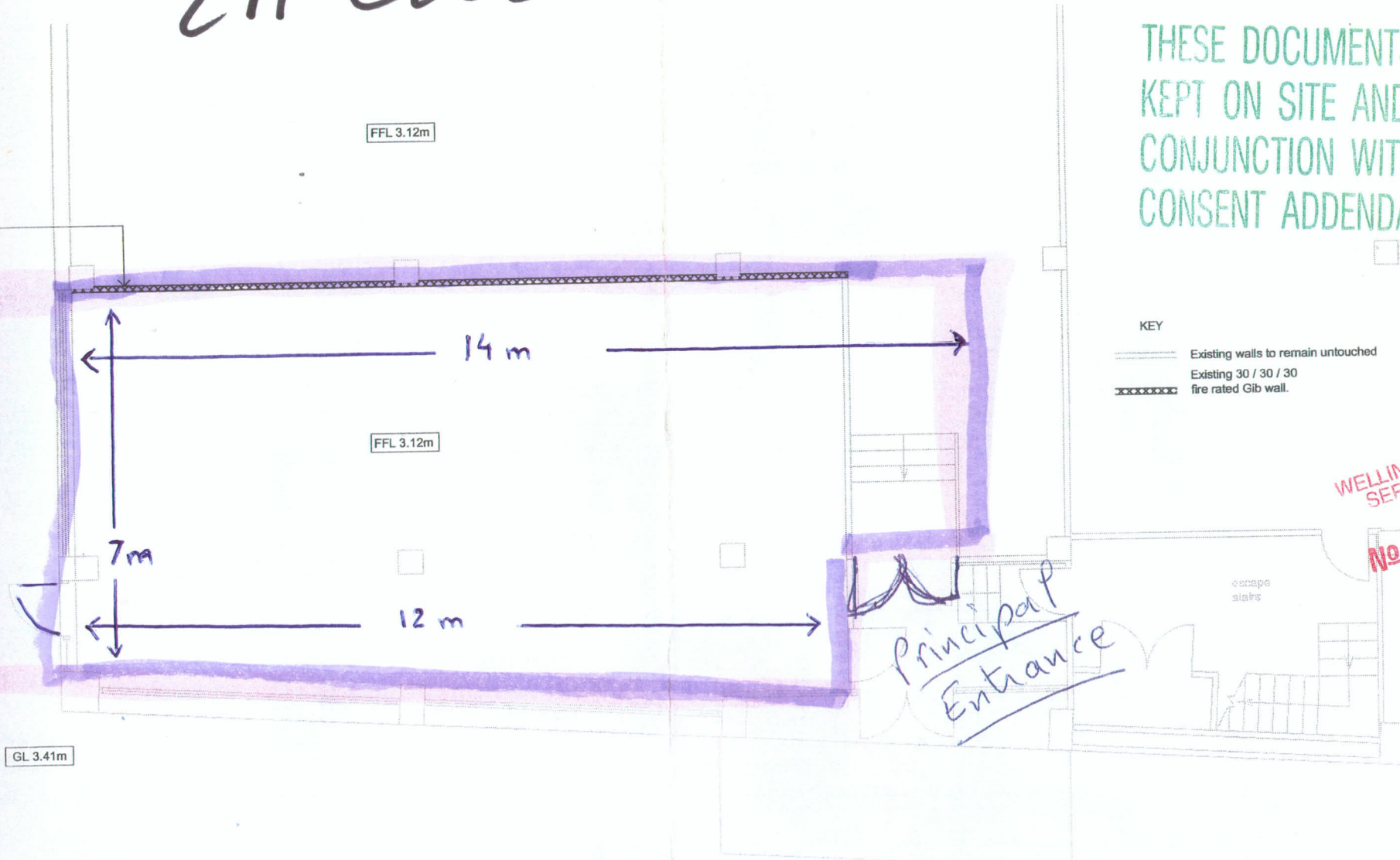

KEY
— Existing walls to remain untouched
- - - Existing 30 / 30 / 30
XXXXXX fire rated Gib wall.

WELLINGTON CITY COUNCIL
SERVICE REQUEST No.

No 142799

APPROVED BUILDING
CONSENT DOCUMENTS

EXISTING / DEMO PLAN 1:100

W
V
www
P.O.
Tel.
PRC
Pr
13/
We
DR/
Exi
Lc
Sc
DR/
for
for
for
for
as
—
JOE
DEL
DR/
CHE
DAT
—
Con
Opp

Wellington City Council Received:
03/06/2022

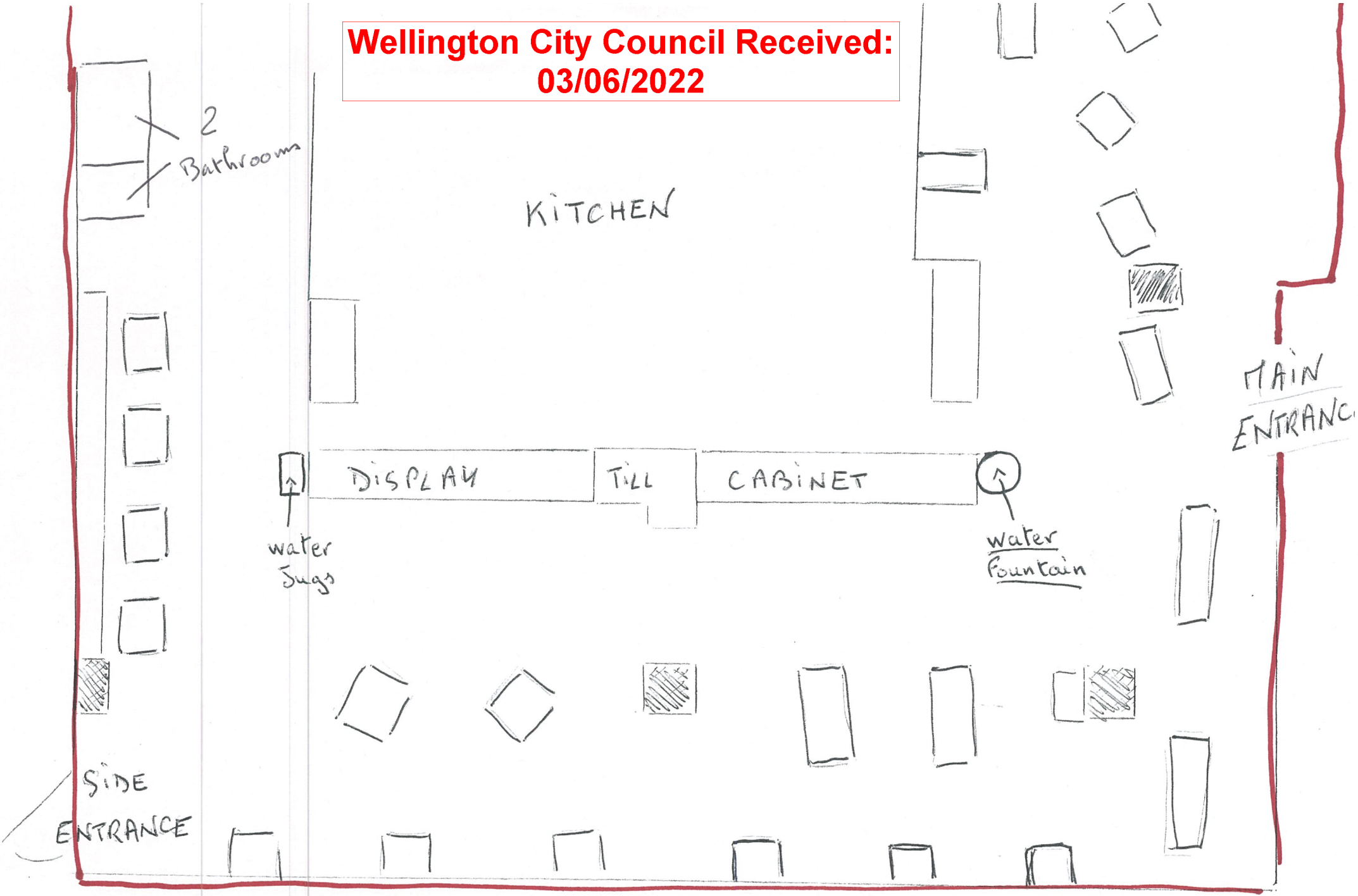

SIDE
ENTRANCE

MAIN
ENTRANCE

134 OLD HUTT RD KAIWHARAWHARA