TRAFFIC RESOLUTIONS

1. Purpose of Report

This report presents the proposed traffic resolutions (due for public consultation) for the Board's information. Copies of the proposed resolutions are attached to this report (appendices one to five).

2. Executive Summary

Council officers intend to submit for public consultation a number of alterations to current parking restrictions within Tawa. These proposed alterations have been notified to the Board's Officer/Member Rooding Working Group, and the proposed resolutions reflect the majority of its recommendations.

It is intended that the four proposed resolutions will go to public consultation for two weeks from 5 October 2010. Affected residents and businesses, along with the local residents' association, will be notified of the proposed resolutions from 20 September 2010 onwards.

Council officers will report back to the Board at its November meeting, with the results of the public consultation and any amendments or revocations to the proposed resolutions that have resulted from the consultation process. These resolutions will be scheduled to be heard by the Council's Strategy and Policy Committee in late November or December 2010.

3. Recommendations

Officers recommend that the Tawa Community Board:

- 1. Receive the information.*
- 2. Note that affected residents, businesses and local residents' and business associations will be notified of the public consultation on the proposed traffic resolutions during the week beginning 20 September 2010.*
- 3. Note that public consultation on the proposed traffic resolutions will commence on 5 October 2010.*
- 4. Note that Council officers will report back to the Tawa Community Board on the outcome of the public consultation on the proposed traffic resolutions, prior to the resolutions going to Council.*

Appendix One

5. *Note that the Council will make a final decision on the proposed traffic resolutions in November or December 2010.*

4. Background

Council officers have received requests from two businesses and a community group to review the current parking restrictions on sections of Main Road, Collins Avenue and Hinau Street in Tawa. These requests have been considered by the Officer/Member Roding Working Group and officers have prepared four 'proposed traffic resolution reports' reflecting the majority of the Working Group's recommendations.

4.1 *Hinau Street / Collins Avenue*

Council officers received a request for a review of parking restrictions from Board members on behalf of St Christopher's & St Peter's Anglican Church. The Church has a playgroup known as "Pop in", which provides free preschool education and a chance for parents and children to meet. The playgroup is very well supported and has operated for over 20 years. The playgroup meets in the church on the corner of Collins Avenue and Hinau Street. The current P60 restriction causes a lot of difficulty for parents and their children trying to find a place to park for the two hour playgroup sessions.

The request is for the current P60 restrictions to be increased to P120. Appendices one and two show the proposed traffic resolution reports for Hinau Street and Collins Avenue.

4.2 *199-209 Main Road*

Council officers received a request from the owners of the Skipping Bull Bar and Steakhouse to review the current parking restrictions within the vicinity of their business. The owners believe that the current restrictions do not meet the needs of the Tawa community or the businesses serving them.

The Board members on the Working Group have recommended that the current P60 restriction along the western kerbline between Essex Street and Lincoln Avenue be increased to P120. The officer on the Working Group does not support the entire change as other businesses' activities may require shorter parking time limits.

Appendix three shows the proposed traffic resolution report for this section of Main Road, Tawa.

4.3 *78-82 Main Road*

Council officers received a request from the building owners of 78-82 Main Road to look at some time restrictions on parking spaces in front of their premises given their recent alteration to retail spaces. Currently there is no restriction on parking in this area and employees of the surrounding businesses park their vehicles in front of the shop entrances all day.

Appendix One

The Working Group raised concerns that if the entire length of the building was to be restricted then the all day parkers would end up in Redwood Avenue and surrounding residential streets, thereby causing increased congestion. The Working Group has recommended two parking spaces outside the liquor store and three parking spaces outside the carpet store.

Appendix four shows the proposed traffic resolution report for this section of Main Road, Tawa.

5. Conclusion

Council Officers have prepared four proposed traffic resolution reports reflecting the majority of recommendations made by the Working Group for public consultation.

Report prepared by: *Charles Agate, Traffic Engineer, Transport Network Operations*

Appendix One

Appendix I

Proposed Traffic Resolution:

Hinau Street (Linden)

Time restricted P60, P120 and reconfirmation.

Reference Number: 110-10

Location: Hinau Street - Linden

Proposal: Time restricted P60 (at all times), P120 (at all times), and reconfirmation of existing restrictions.

Legal Description:

Delete from Schedule A (Time Limited Parking) of the Traffic Restrictions Schedule

<i>Column One</i>	<i>Column Two</i>	<i>Column Three</i>
<i>Hinau Street</i>	<i>P60, at all times.</i>	<i>East side, commencing 29 metres south of its intersection with Collins Avenue and extending in a southerly direction following the kerbline for 45 metres.</i>

Delete from Schedule B (Restricted Parking) of the Traffic Restrictions Schedule

<i>Column One</i>	<i>Column Two</i>	<i>Column Three</i>
<i>Hinau Street</i>	<i>Mobility parking – displaying an operation mobility permit only, at all times.</i>	<i>West side, commencing 59.5 metres south of its intersection with Collins Avenue (Grid Coordinates $x= 1753809.363274$ m, $y= 5442104.410136$ m), and extending in a southerly direction following the kerbline for 7.5 metres</i>

Delete from Schedule D (No Stopping Restrictions) of the Traffic Restrictions Schedule

<i>Column One</i>	<i>Column Two</i>	<i>Column Three</i>
<i>Hinau Street</i>	<i>No stopping, at all times.</i>	<i>West side, commencing from its intersection with Collins Avenue and extending in a southerly direction following the kerbline for 13 metres.</i>
<i>Hinau Street</i>	<i>No stopping, at all times.</i>	<i>East side, commencing from its intersection with Collins Avenue and extending in a southerly direction following the kerbline for 19 metres.</i>

Appendix One

Add to Schedule A (Time Limited Parking) of the Traffic Restrictions Schedule

<i>Column One</i>	<i>Column Two</i>	<i>Column Three</i>
<i>Hinau Street</i>	<i>P120, at all times.</i>	<i>West side, commencing 495 metres northeast of its intersection with McLellan Street (Grid Coordinates $x= 1753642.9$ m, $y= 5441575.1$ m), and extending in a north-easterly direction following the western kerbline for 44.5 metres.</i>
<i>Hinau Street</i>	<i>P60, at all times.</i>	<i>East side, commencing 22 metres south of its intersection with Collins Avenue (Grid Coordinates $x= 1753820.8$ m, $y= 5442100.3$ m), and extending in a southerly direction following the eastern kerbline for 46 metres.</i>

Add to Schedule B (Restricted Parking) of the Traffic Restrictions Schedule

<i>Column One</i>	<i>Column Two</i>	<i>Column Three</i>
<i>Hinau Street</i>	<i>Mobility parking – displaying an operation mobility permit only, at all times.</i>	<i>West side, commencing 487.5 metres northeast of its intersection with McLellan Street (Grid Coordinates $x= 1753642.9$ m, $y= 5441575.1$ m), and extending in a north-easterly direction following the western kerbline for 7.5 metres.</i>

Add to Schedule D (No Stopping Restrictions) of the Traffic Restrictions Schedule

<i>Column One</i>	<i>Column Two</i>	<i>Column Three</i>
<i>Hinau Street</i>	<i>No stopping, at all times.</i>	<i>West side, commencing 481.5 metres northeast of its intersection with McLellan Street (Grid Coordinates $x= 1753642.9$ m, $y= 5441575.1$ m), and extending in a north-easterly direction following the western kerbline for 6 metres.</i>
<i>Hinau Street</i>	<i>No stopping, at all times.</i>	<i>West side, commencing 539.5 metres northeast of its intersection with McLellan Street (Grid Coordinates $x= 1753642.9$ m, $y= 5441575.1$ m), and extending in a north-easterly direction following the western kerbline for 8.5 metres.</i>

Appendix One

<i>Hinau Street</i>	<i>No stopping, at all times.</i>	<i>East side, commencing from its intersection with Collins Avenue (Grid Coordinates x= 1753820.8 m, y= 5442100.3 m), and extending in a southerly direction following the eastern kerbline for 3.5 metres.</i>
----------------------------	-----------------------------------	---

<i>Hinau Street</i>	<i>No stopping, at all times.</i>	<i>East side, commencing 6.5 metres south of its intersection with Collins Avenue (Grid Coordinates x= 1753820.8 m, y= 5442100.3 m), and extending in a southerly direction following the eastern kerbline for 15.5 metres.</i>
----------------------------	-----------------------------------	---

Add to Schedule H (Pedestrian Crossing) of the Traffic Restrictions Schedule

<i>Column One</i>	<i>Column Two</i>	<i>Column Three</i>
<i>Hinau Street</i>	<i>Pedestrian crossing.</i>	<i>3.5 metres south of its intersection with Collins Avenue.</i>

x= 1753809.9 m
y= 5442104.4 m

x= 1753820.8 m
y= 5442100.3 m

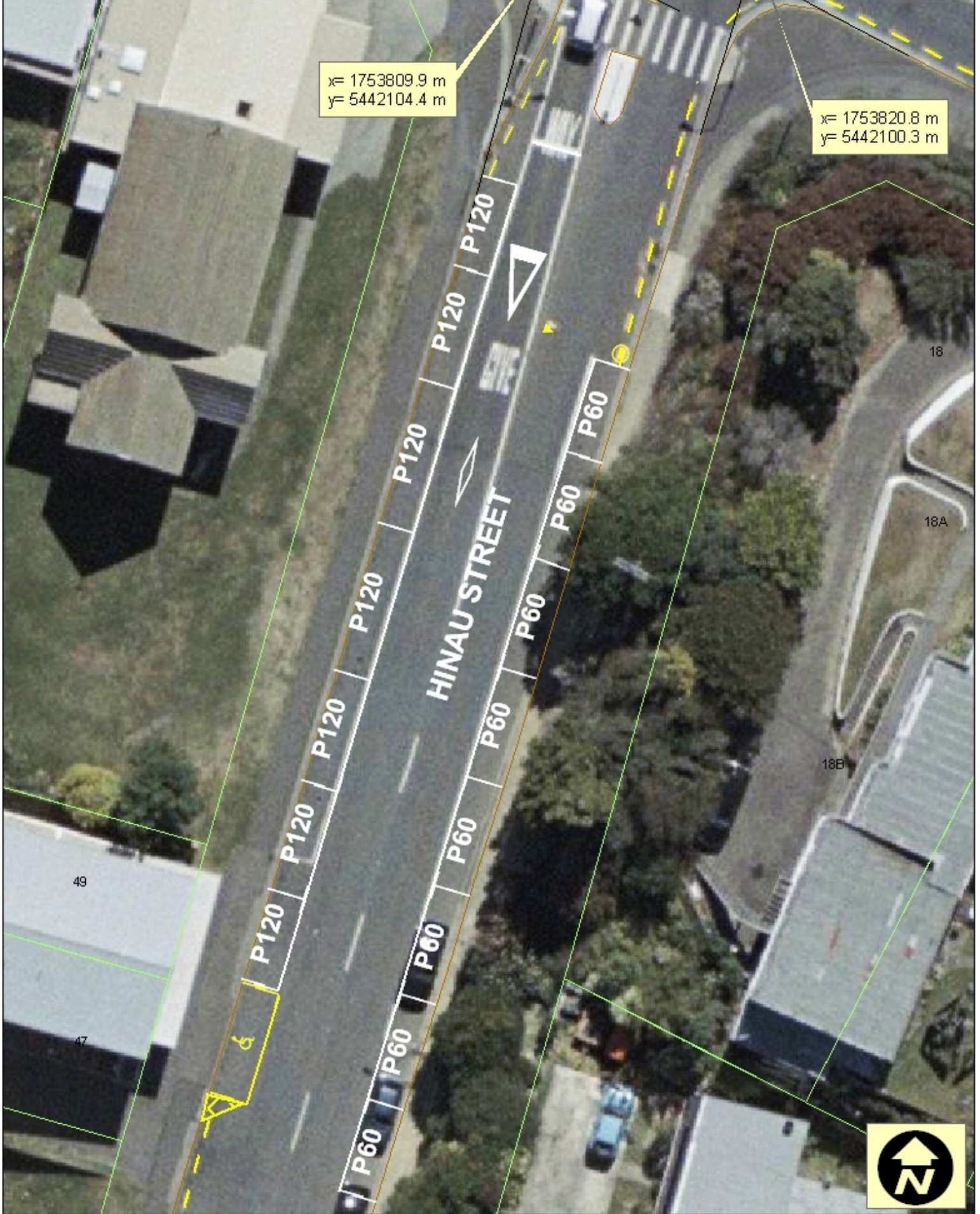

DATA STATEMENT
Property boundaries
Landed information has
been checked and
accuracy is as shown
Accuracy in urban areas: +/- 1m
Accuracy in rural areas: +/- 50m

Topographic data
Wellington City Council
© 2010 copyright reserved
Accuracy +/- 50mm

Other data has been
compiled from a
variety of sources and
its accuracy may vary

Any contours displayed
are only approximate
and must not be used for
structural engineering design

Hinau Street (Linden)

Proposed Time restricted P60&P 120 (at all times)

TR110-10



1:250

Absolutely
POSITIVELY
NO MORE AT POINTS
WELLINGTON CITY COUNCIL **Wellington**

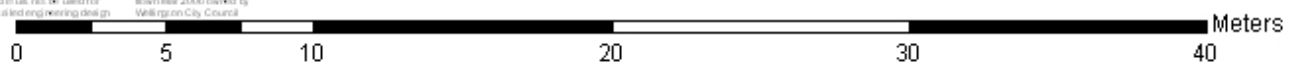

Appendix One

Appendix One

Appendix II

Proposed Traffic Resolution:
Collins Avenue (Linden)
Time restricted P120 and reconfirmation.

Reference Number: 112-10

Location: Collins Avenue - Linden

Proposal: Time restricted P120 (Monday to Saturday 8:00am – 6:00pm), and reconfirmation of existing restrictions.

Legal Description:

Delete from Schedule A (Time Limited Parking) of the Traffic Restrictions Schedule.

<i>Column One</i>	<i>Column Two</i>	<i>Column Three</i>
<i>Collins Avenue</i>	<i>P60, Monday to Saturday 8:00am – 6:00pm.</i>	<i>North side, commencing 92.5 metres north of its intersection with Findlay Street and extending in a easterly direction following the northern kerbline for 34.5 metres.</i>
<i>Collins Avenue</i>	<i>P60, Monday to Saturday 8:00am – 6:00pm.</i>	<i>South side, commencing 18.5 metres south of its intersection with Hinau Street and extending in a westerly direction following the southern kerbline.</i>

Delete from Schedule D (No Stopping Restrictions) of the Traffic Restrictions Schedule.

<i>Column One</i>	<i>Column Two</i>	<i>Column Three</i>
<i>Collins Avenue</i>	<i>No stopping, at all times.</i>	<i>South side, commencing from its intersection with Hinau Street and extending in a westerly direction following the southern kerbline for 2 metres.</i>
<i>Collins Avenue</i>	<i>No stopping, at all times.</i>	<i>South side, commencing 4 metres south of its intersection with Hinau Street and extending in a westerly direction following the southern kerbline for 6 metres.</i>
<i>Collins Avenue</i>	<i>No stopping, at all times.</i>	<i>South side, commencing 12.5 metres south of its intersection with Hinau Street and extending in a westerly direction following the southern kerbline for 5.5 metres.</i>

Appendix One

Add to Schedule A (Time Limited Parking) of the Traffic Restrictions Schedule.

Column One	Column Two	Column Three
Collins Avenue	<i>P120, Monday to Saturday 8:00am – 6:00pm.</i>	<i>North side, commencing 88 metres east of its intersection with Findlay Street (Grid Coordinates x= 1753691.9 m, y= 5442174.2 m), and extending in an easterly direction following the northern kerbline for 32 metres.</i>
Collins Avenue	<i>P120, Monday to Saturday 8:00am – 6:00pm</i>	<i>South side, commencing 18.5 metres west of its intersection with Hinau Street (Grid coordinates x= 1753809.9 m, y= 5442101.8 m), and extending in a westerly direction following the southern kerbline for 16.5 metres.</i>
Collins Avenue	<i>P120, Monday to Saturday 8:00am – 6:00pm</i>	<i>South side, commencing 40 metres west of its intersection with Hinau Street (Grid coordinates x= 1753809.9 m, y= 5442101.8 m), and extending in a westerly direction following the southern kerbline for 5 metres.</i>

Add to Schedule D (No Stopping Restrictions) of the Traffic Restrictions Schedule.

Column One	Column Two	Column Three
Collins Avenue	<i>No stopping, at all times.</i>	<i>North side, commencing 120 metres east of its intersection with Findlay Street (Grid Coordinates x= 1753691.9 m, y= 5442174.2 m), and extending in an easterly direction following the northern kerbline for 8.5 metres.</i>
Collins Avenue	<i>No stopping, at all times.</i>	<i>South side, commencing from its intersection with Hinau Street (Grid coordinates x= 1753809.9 m, y= 5442101.8 m), and extending in a westerly direction following the southern kerbline for 6 metres.</i>

Appendix One

<i>Collins Avenue</i>	<i>No stopping, at all times.</i>	<i>South side, commencing 9 metres west of its intersection with Hinau Street (Grid coordinates x= 1753809.9 m, y= 5442101.8 m), and extending in a westerly direction following the southern kerbline for 9.5 metres.</i>
-----------------------	-----------------------------------	--

<i>Collins Avenue</i>	<i>No stopping, at all times.</i>	<i>South side, commencing 35 metres west of its intersection with Hinau Street (Grid coordinates x= 1753809.9 m, y= 5442101.8 m), and extending in a westerly direction following the southern kerbline for 5 metres.</i>
-----------------------	-----------------------------------	---

Add to Schedule H (Pedestrian Crossing) of the Traffic Restrictions Schedule.

<i>Column One</i>	<i>Column Two</i>	<i>Column Three</i>
<i>Collins Avenue</i>	<i>Pedestrian crossing.</i>	<i>128.5 metres south of its intersection with Findlay Street.</i>

Appendix One

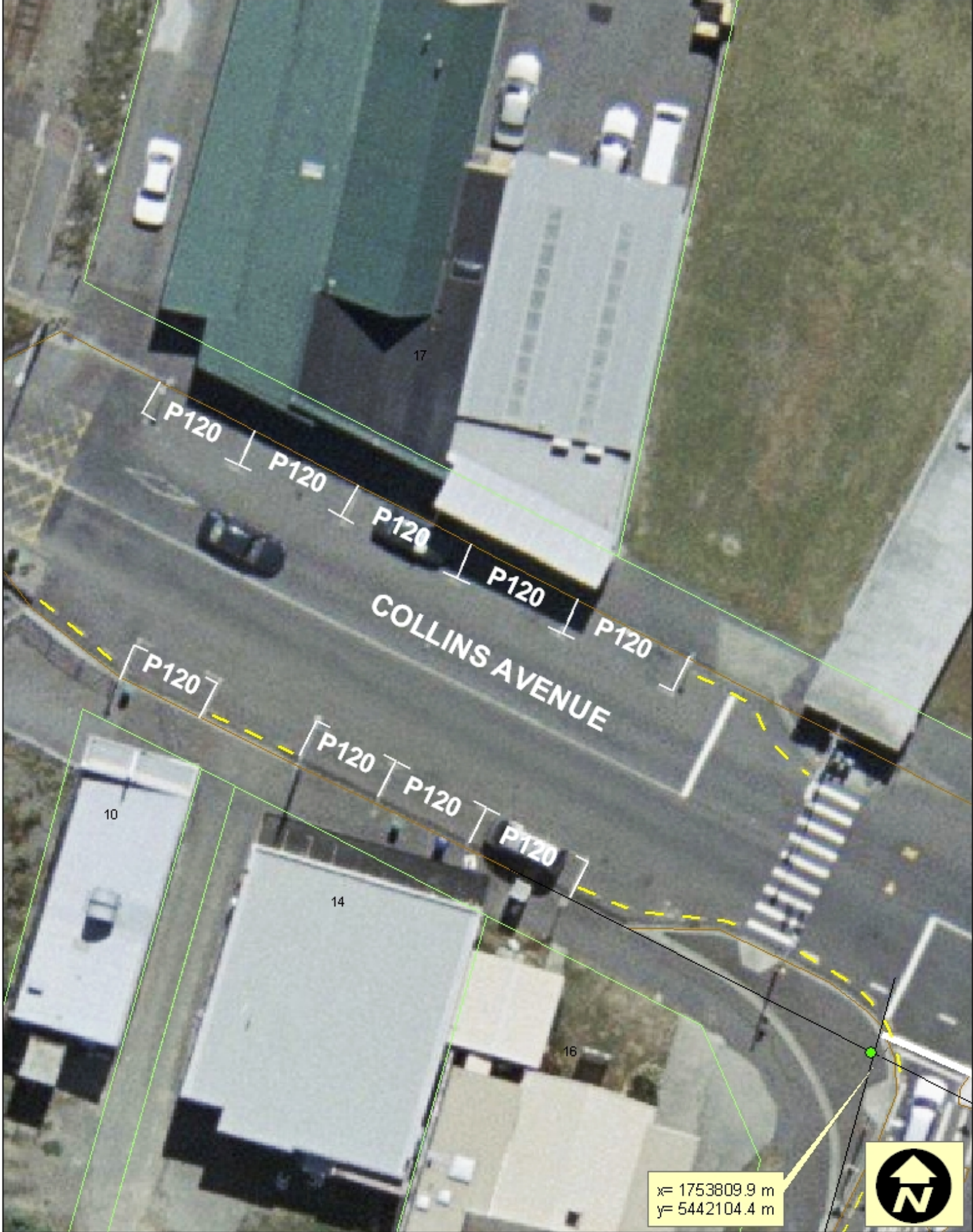

DATA STATEMENT
 Property boundaries
 Land Information NZ
 License W000004712
 Crown Copyright reserved
 Accuracy in urban areas: +/- 1m
 Accuracy in rural areas: +/- 30m

Other data has been
 compiled from a
 variety of sources and
 its accuracy may vary

Any contours displayed
 are only approximate
 and must not be used for
 detailed engineering design

Colour Orthophoto copyright 1:2500
 Born later 2000 owned by
 Wellington City Council

Collins Ave (Linden)

Proposed Time restricted P120 (Mon -Sat 8am-6pm)
 TR112-10

Absolutely

POSITIVELY

FOR MORE BY PHONE
 WELLINGTON CITY COUNCIL

Wellington

1:250

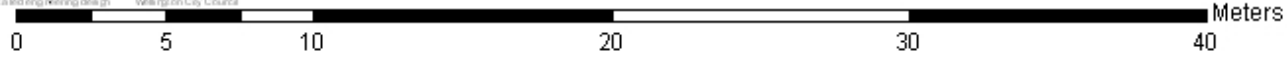

Appendix One

Appendix One

Appendix III

Proposed Traffic Resolution:
Main Road (Tawa)
Time restricted P30, P120 and No stopping at all times.

Reference Number: 100-10

Location: Main Road - Tawa

Proposal: Time restricted
P30 (Monday to Friday 8:00am – 6:00pm, Saturday 8:00am – 2:00pm),
P120 (Monday to Friday 8:00am – 6:00pm, Saturday 8:00am – 2:00pm),
No stopping at all times.

Legal Description:

Add to Schedule A (Time Limited Parking) of the Traffic Restrictions Schedule

<i>Column One</i>	<i>Column Two</i>	<i>Column Three</i>
Main Road (Tawa)	P30, Monday to Friday 8:00am – 6:00pm. Saturday 8:00am – 2:00pm.	East side, commencing 178 metres south of its intersection with Tawa Street (Grid Coordinates $x=1753097.3$ m, $y=5440147.1$ m), and extending in a southerly direction following the eastern kerbline for 5 metres. (2 angle parking spaces).
Main Road (Tawa)	P120, Monday to Friday 8:00am – 6:00pm. Saturday 8:00am – 2:00pm.	East side, commencing 221.5 metres south of its intersection with Tawa Street (Grid Coordinates $x=1753097.3$ m, $y=5440147.1$ m), and extending in a southerly direction following the eastern kerbline for 7.5 metres. (3 angle parking spaces)

Add to Schedule D (No Stopping Restrictions) of the Traffic Restrictions Schedule

<i>Column One</i>	<i>Column Two</i>	<i>Column Three</i>
Main Road (Tawa)	No stopping, at all times.	East side, commencing 196 metres south of its intersection with Tawa Street (Grid Coordinates $x=1753097.3$ m, $y=5440147.1$ m), and extending in a southerly direction following the eastern kerbline for 10 metres.

Appendix One

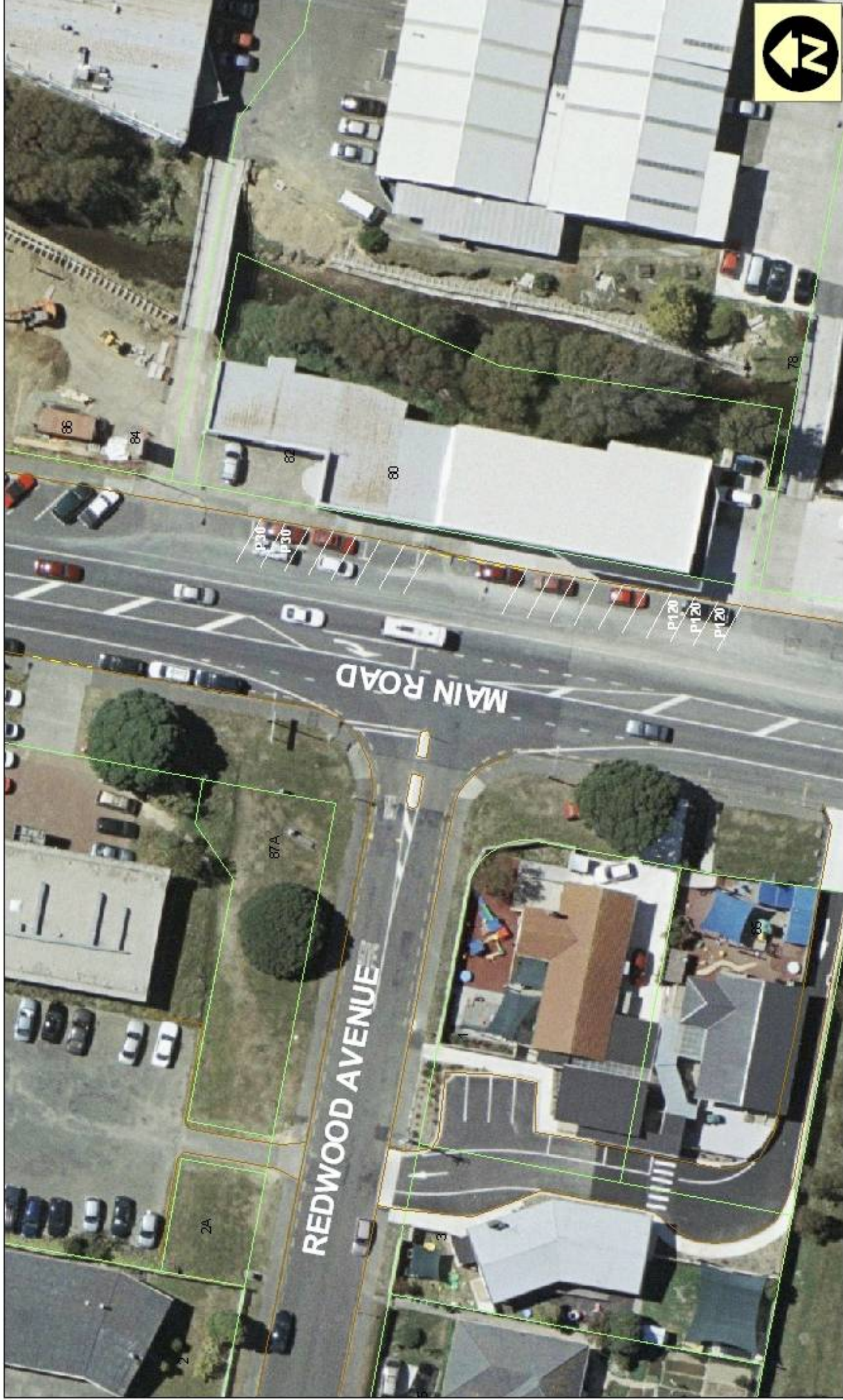

24-16-016 (PUBLIC)
 City of Wellington
 Planning Department
 2024-01-16 10:00 AM
 Accuracy: ± 0.5m (Horizontal)
 Accuracy: ± 0.5m (Vertical)

Other services from:
 City of Wellington
 Accuracy: ± 0.5m (Horizontal)
 Accuracy: ± 0.5m (Vertical)

Proposed P30 (Monday to Friday 8:00am – 6:00pm, Saturday 8:00am – 2:00pm),
 Proposed P120 (Monday to Friday 8:00am – 6:00pm, Saturday 8:00am – 2:00pm),
 TR100-10

Absolutely Positively
 ASK ABOUT OUR PLANS AT WELLINGTON CITY COUNCIL

1:500

Meters

0 5 10 20 30 40

Appendix One

Appendix One

Appendix IV

Proposed Traffic Resolution:
Main Road (Tawa)
Time restricted P120

Reference Number: 111-10

Location: Main Road - Tawa

Proposal: P120 (Monday to Saturday 8:00am – 6:00pm).

Legal Description:

Delete from Schedule A (Time Limited Parking) Schedule B (Restricted Parking) Schedule C (Turning and One Way Restrictions) Schedule D (No Stopping Restrictions) Schedule E (Residents Parking) Schedule F (Metered Parking) Schedule G (Give Way and Stop Controls) Schedule H (Pedestrian Crossings) of the Traffic Restrictions Schedule.

All current restrictions on Main Road, (Tawa) along the western kerbline between Essex Street and Lincoln Avenue.

Add to Schedule A (Time Limited Parking) of the Traffic Restrictions Schedule

Column One	Column Two	Column Three
Main Road (Tawa)	<i>P120, Monday to Saturday 8:00am – 6:00pm.</i>	<i>West side, commencing 12 metres north of its intersection with Essex Street (Grid Coordinates x= 1753087.9 m, y= 5440808.2 m), and extending in a northerly direction following the western kerbline for 75 metres. (23 angle parking spaces)</i>

Add to Schedule B (Restricted Parking) of the Traffic Restrictions Schedule.

Column One	Column Two	Column Three
Main Road (Tawa)	<i>Bus stop, at all times.</i>	<i>West side, commencing 97 metres north of its intersection with Essex Street (Grid Coordinates x= 1753087.9 m, y= 5440808.2 m), and extending in a northerly direction following the western kerbline for 13 metres.</i>

Appendix One

Add to Schedule D (No Stopping Restrictions) of the Traffic Restrictions Schedule

<i>Column One</i>	<i>Column Two</i>	<i>Column Three</i>
<i>Main Road (Tawa)</i>	<i>No stopping, at all times</i>	<i>West side, commencing from its intersection with Essex Street (Grid Coordinates x= 1753087.9 m, y= 5440808.2 m), and extending in a northerly direction following the western kerbline for 4 metres.</i>
<i>Main Road (Tawa)</i>	<i>No stopping, at all times</i>	<i>West side, commencing 8 metres north of its intersection with Essex Street (Grid Coordinates x= 1753087.9 m, y= 5440808.2 m), and extending in a northerly direction following the western kerbline for 4 metres.</i>
<i>Main Road (Tawa)</i>	<i>No stopping, at all times</i>	<i>West side, commencing 87 metres north of its intersection with Essex Street (Grid Coordinates x= 1753087.9 m, y= 5440808.2 m), and extending in a northerly direction following the western kerbline for 10 metres.</i>
<i>Main Road (Tawa)</i>	<i>No stopping, at all times</i>	<i>West side, commencing 110 metres north of its intersection with Essex Street (Grid Coordinates x= 1753087.9 m, y= 5440808.2 m), and extending in a northerly direction following the western kerbline to its intersection with Lincoln Avenue.</i>



DATA STATEMENT
 Property boundaries
 Land Information NZ
 License W001006112
 Crown Copyright reserved
 Accuracy in urban areas: +/-1m
 Accuracy in rural areas: +/-50m

Other data has been
 compiled from a
 variety of sources and
 its accuracy may vary

Any contours displayed
 are only approximate
 and in use not be used for
 detailed engineering design

Colour Orthophoto copyright: 1:2500
 from file 2000 owned by
 Wellington City Council

Main Road (Tawa)
Proposed Time restricted
P120 (Mon to Sat 8am - 6pm)
TR111-10

Absolutely 1:500
POSITIVELY
 He Kōwhiri o Pōhaki
Wellington
 WELLINGTON CITY COUNCIL

