









## Legend

	BOUNDARY OF THE URBAN TRAFFIC AREA THAT HAS A SPEED LIMIT OF 50km/h, EXCEPT FOR THOSE ROADS MARKED WITH A DIFFERENT SPEED LIMIT.
	BOUNDARY OF AN AREA THAT HAS A SPEED LIMIT OF 30km/h.
	BOUNDARY OF AN AREA THAT HAS A SPEED LIMIT OF 40km/h.
	BOUNDARY OF AN AREA THAT HAS A SPEED LIMIT OF 60km/h.
	BOUNDARY OF AN AREA THAT HAS A SPEED LIMIT OF 70km/h.
	BOUNDARY OF AN AREA THAT HAS A SPEED LIMIT OF 80km/h.
	BOUNDARY OF AN AREA THAT HAS A SPEED LIMIT OF 100km/h.
	BOUNDARY OF AN AREA THAT IS SUBJECT TO A VARIABLE SPEED ZONE.
	DISTANCE IN METERS FROM A SIDE ROAD OR GEOGRAPHICAL FEATURE TO THE SPEED RESTRICTION BOUNDARY.

1. SCALES GIVEN ON THE PLANS ARE APPROXIMATE FOR THE PURPOSE OF LEGAL DESCRIPTION. DIMENSIONS GIVEN ARE THE EXTENT OF THE BYLAW SPEED LIMIT FOR THE PURPOSE OF THE BYLAW.
2. ALL LEGEND MARKINGS CROSSING A ROAD ARE DEEMED TO CROSS THE ROAD AT RIGHT ANGLES FROM ONE SIDE OF THE ROAD TO THE OPPOSITE SIDE AT ITS SHORTEST DISTANCE.
3. WHERE NO DIMENSIONS OR DISTANCE ARE GIVEN OR SHOWN WHERE LEGAL MARKINGS CROSS A ROAD AT A SIDE ROAD, THE MARKINGS ARE DEEMED TO CROSS THE ROAD AT THE PROLONGATION OF THE SIDE ROAD CARRIAGEWAY EDGE.
4. ALL LEGEND MARKINGS ALONG A ROAD ARE DEEMED TO RUN ALONG THE CARRIAGEWAY EDGE OF THE MARKED ROAD UNLESS OTHERWISE DIMENSIONED OR SHOWN.
5. WHERE ROADS CROSS UNDER OR OVER THE STATE HIGHWAY No. 1 THE SPEED RESTRICTION AT THESE LOCATIONS IS DEEMED TO BE THE SAME AS THAT FOR THE ADJOINING SECTIONS OF THE ROAD ON EITHER SIDE OF THE STATE HIGHWAY No. 1.
6. ALL DISTANCES SHOWN ARE IN METERS.
7. SPEED LIMITS ON THE STATE HIGHWAYS ARE NOT PART OF THE WELLINGTON CITY COUNCIL SPEED LIMIT BYLAW 2009. THEY ARE SHOWN FOR INFORMATION ONLY. REFER TO LAND TRANSPORT NEW ZEALAND SPEED LIMITS BYLAW FOR SPEED LIMITS ON STATE HIGHWAYS.

1:80,000

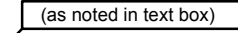
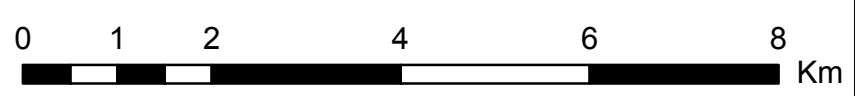

# Wellington City Speed Limits SL 1

# Wellington City Speed Limits SL 2

Map Legend  
Refer to SL 1 for

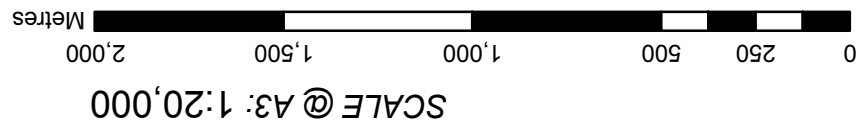

Property boundaries Land Information NZ Licence WN0853547/2. CROWN COPYRIGHT RESERVED. Accuracy in urban areas: +/-1m. Accuracy in rural areas: +/-30m. Topographic data. Wellington City Council. WCC copyright reserved. Colour displayed are only approximate and must not be used for detailed engineering design. Colour Orthophotography 1:500 flown March 2006 or Feb 2008 owned by Wellington City Council. Other data has been compiled from a variety of sources and its accuracy may vary.

Absolutely  
Positively  
Wellington  
The Heart of the Bay

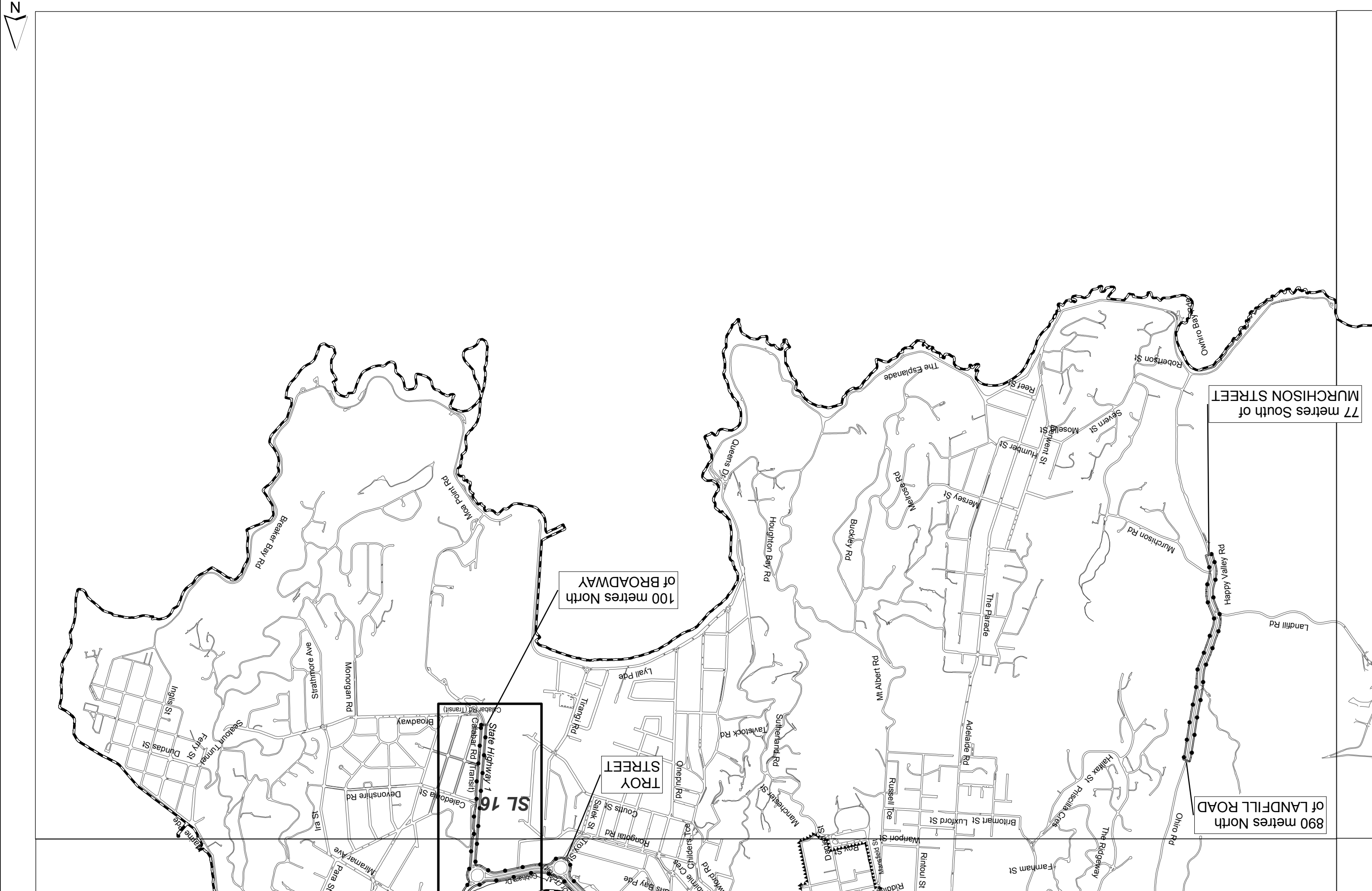

77 metres South of MURCHISON STREET

100 metres North of BROADWAY

890 metres North of LANDFILL ROAD

TROY STREET

SL 16

# Wellington City Speed Limits

## SL 3

Refer to SL 1 for Map Legend

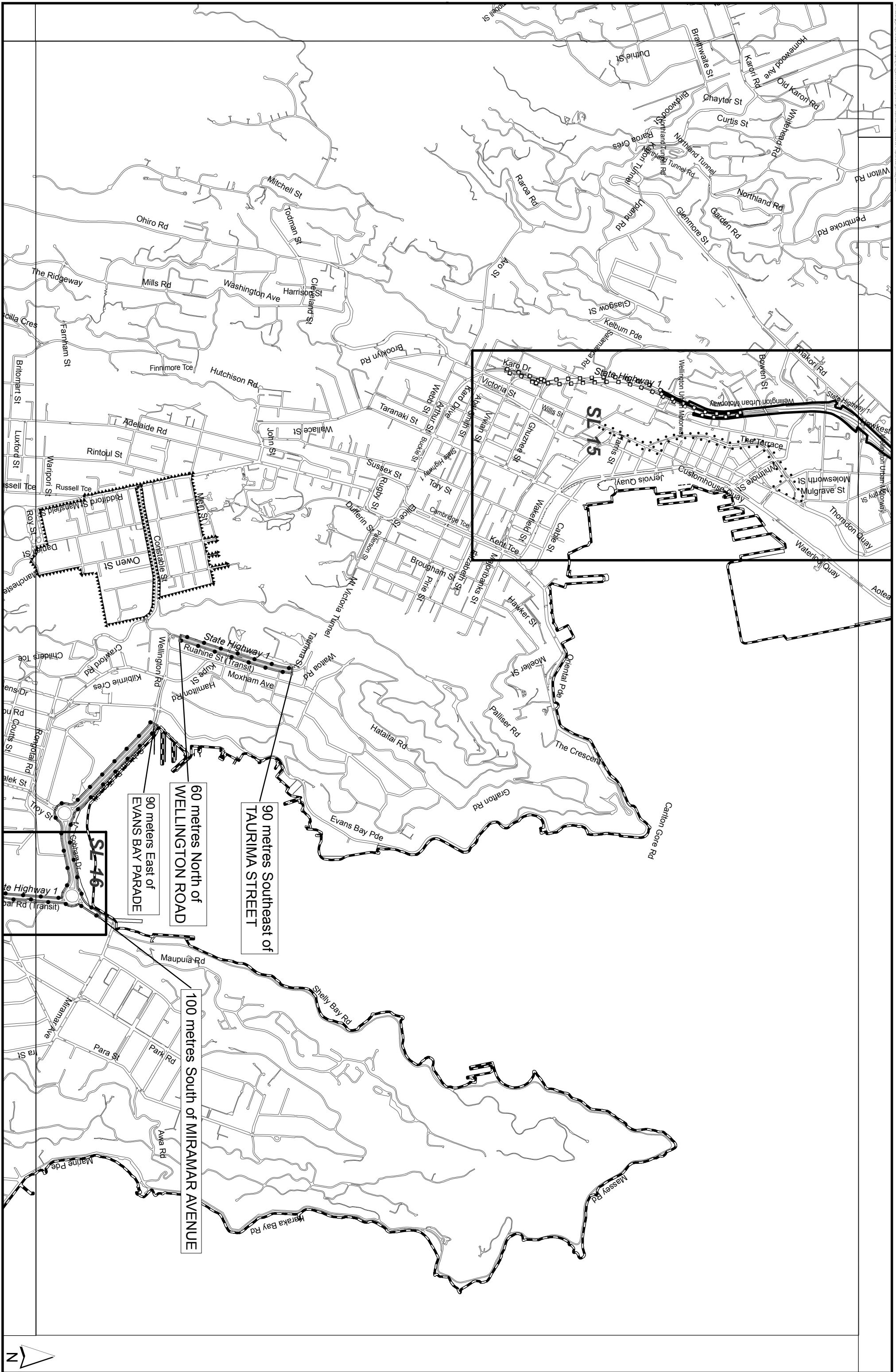
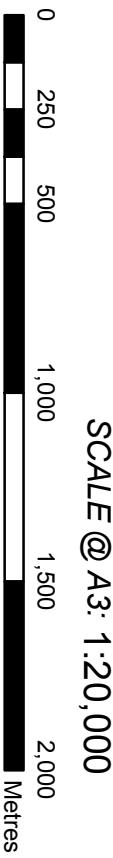

Property boundaries. Land Information NZ. Licence: WIN0855472. ©CROWN COPYRIGHT  
 RESERVED. Accuracy: ±4.1m. Vertical Accuracy: ±4.3m. Any contours  
 displayed are only approximate and must not be used for detailed engineering design. Colour  
 Orthorectification: 1:500 from March 2006 or Feb 2008 owned by Wellington City Council.  
 Other data has been compiled from a variety of sources and its accuracy may vary.



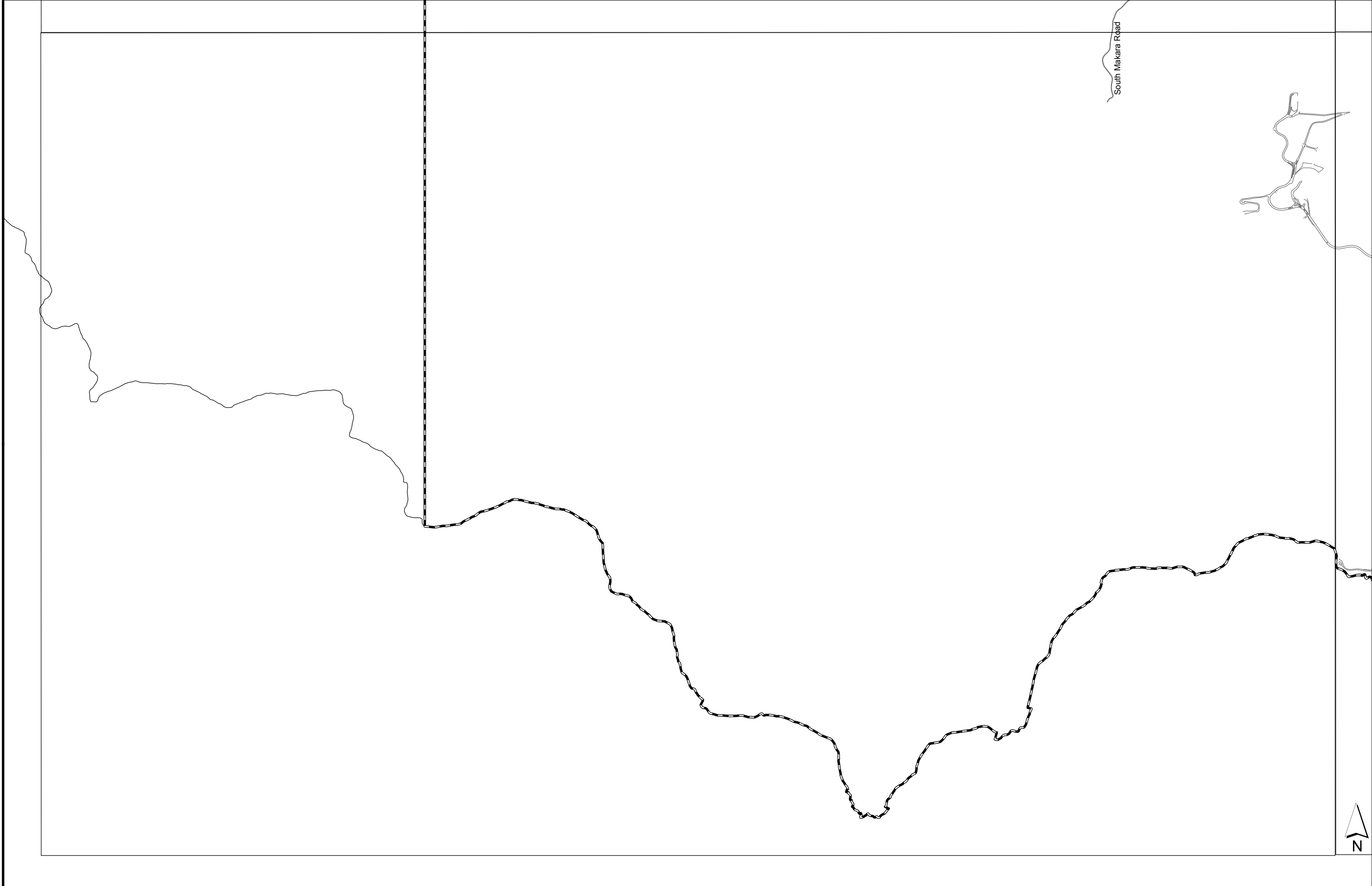

# Wellington City Speed Limits

## SL 4

Refer to SL 1 for  
Map Legend

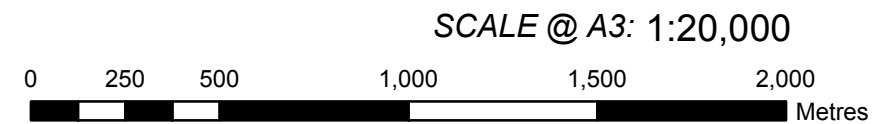

Property boundaries Land Information NZ Licence WN0853547/2 CROWN COPYRIGHT RESERVED. Accuracy in urban areas: +/-1m. Accuracy in rural areas: +/-30m. Topographic data: Wellington City Council WCC copyright reserved Accuracy: +/- 30cm. Any contours displayed are only approximate and must not be used for detailed engineering design. Colour Orthophotography 1:500 flown March 2006 or Feb 2008 owned by Wellington City Council. Other data has been compiled from a variety of sources and its accuracy may vary.



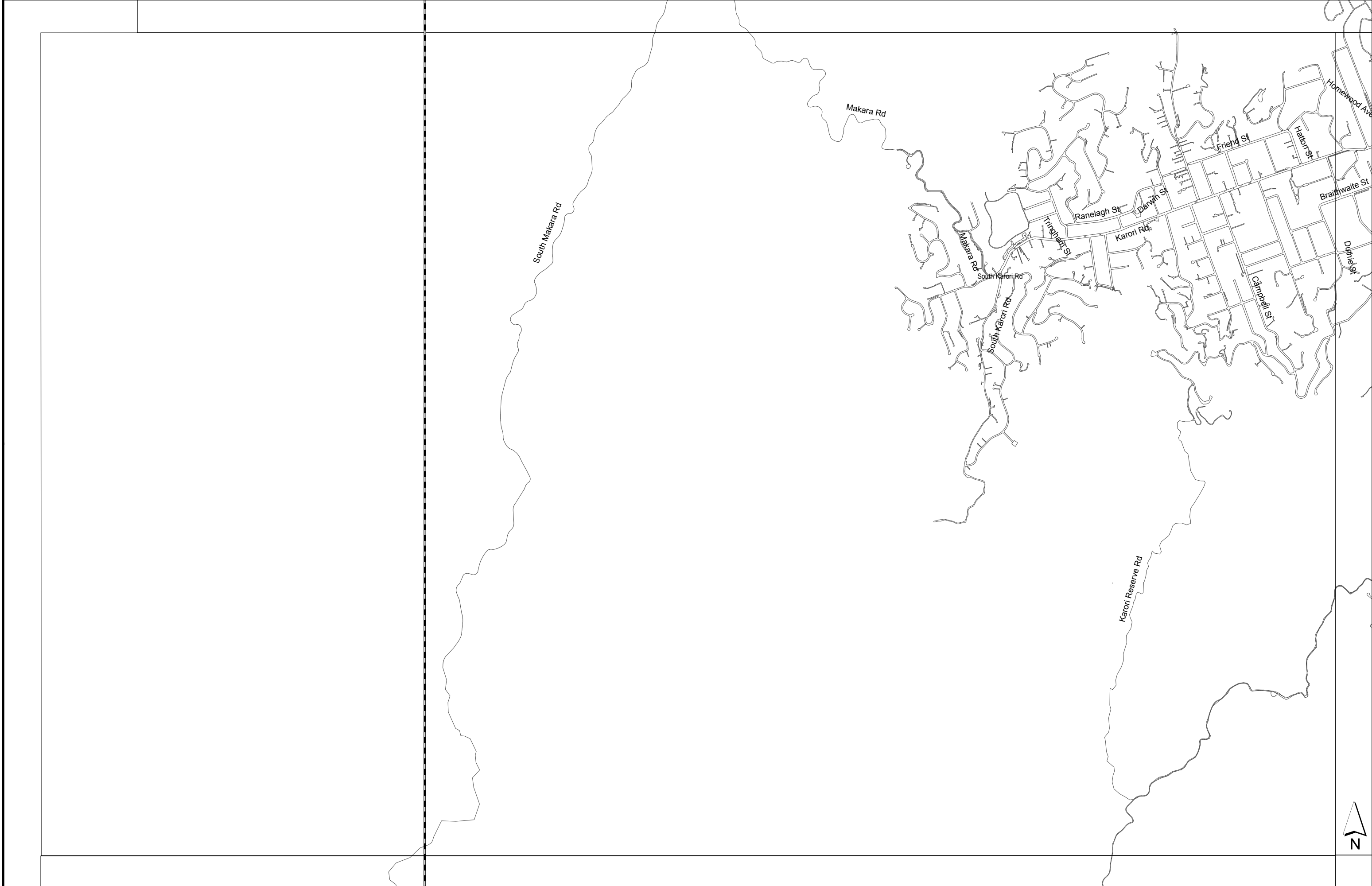

# Wellington City Speed Limits

## SL 5

Refer to SL 1 for Map Legend

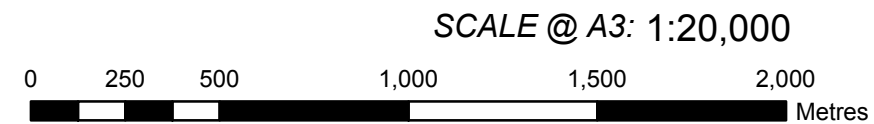

Property boundaries Land Information NZ Licence WN0853547/2 CROWN COPYRIGHT RESERVED. Accuracy in urban areas: +/-1m. Accuracy in rural areas: +/-30m. Topographic data: Wellington City Council WCC copyright reserved Accuracy: +/- 30cm. Any contours displayed are only approximate and must not be used for detailed engineering design. Colour Orthophotography 1:500 flown March 2006 or Feb 2008 owned by Wellington City Council. Other data has been compiled from a variety of sources and its accuracy may vary.



Refer to SL 1 for Map Legend

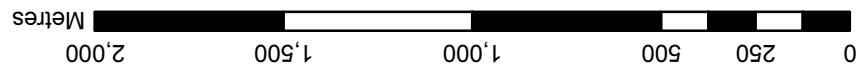

SCALE @ A3: 1:20,000

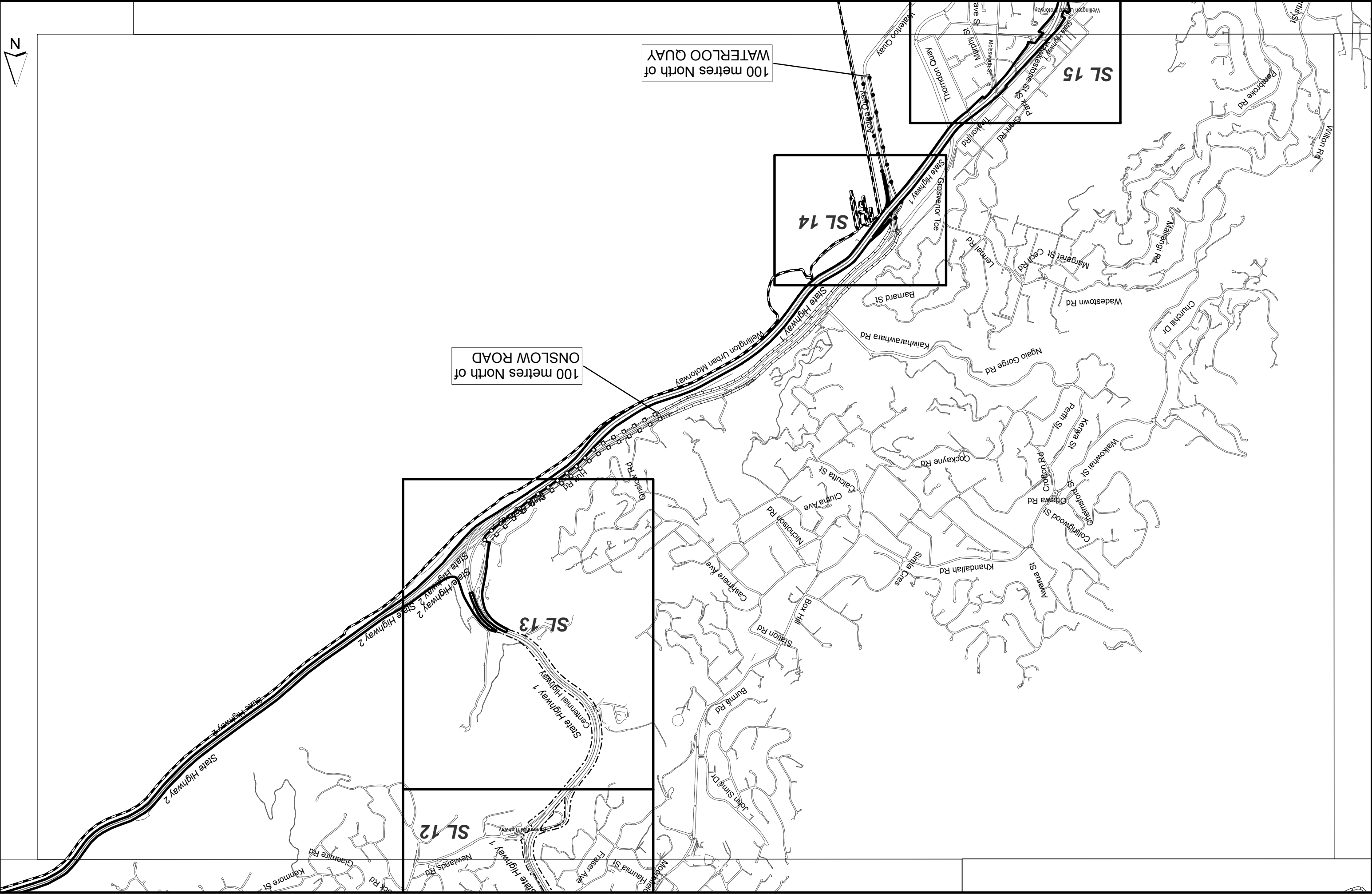

Property boundaries Land Information NZ Licence WN08534712. CROWN COPYRIGHT RESERVED. Accuracy in urban areas: +/-1m. Accuracy in rural areas: +/-30m. Topographic data. Wellington City Council WCC copyright reserved. Accuracy: +/-30cm. Any contours displayed are only approximate and must not be used for detailed engineering design. Colour Orthophotography 1:500 flown March 2006 or Feb 2008 owned by Wellington City Council. Other data has been compiled from a variety of sources and its accuracy may vary.

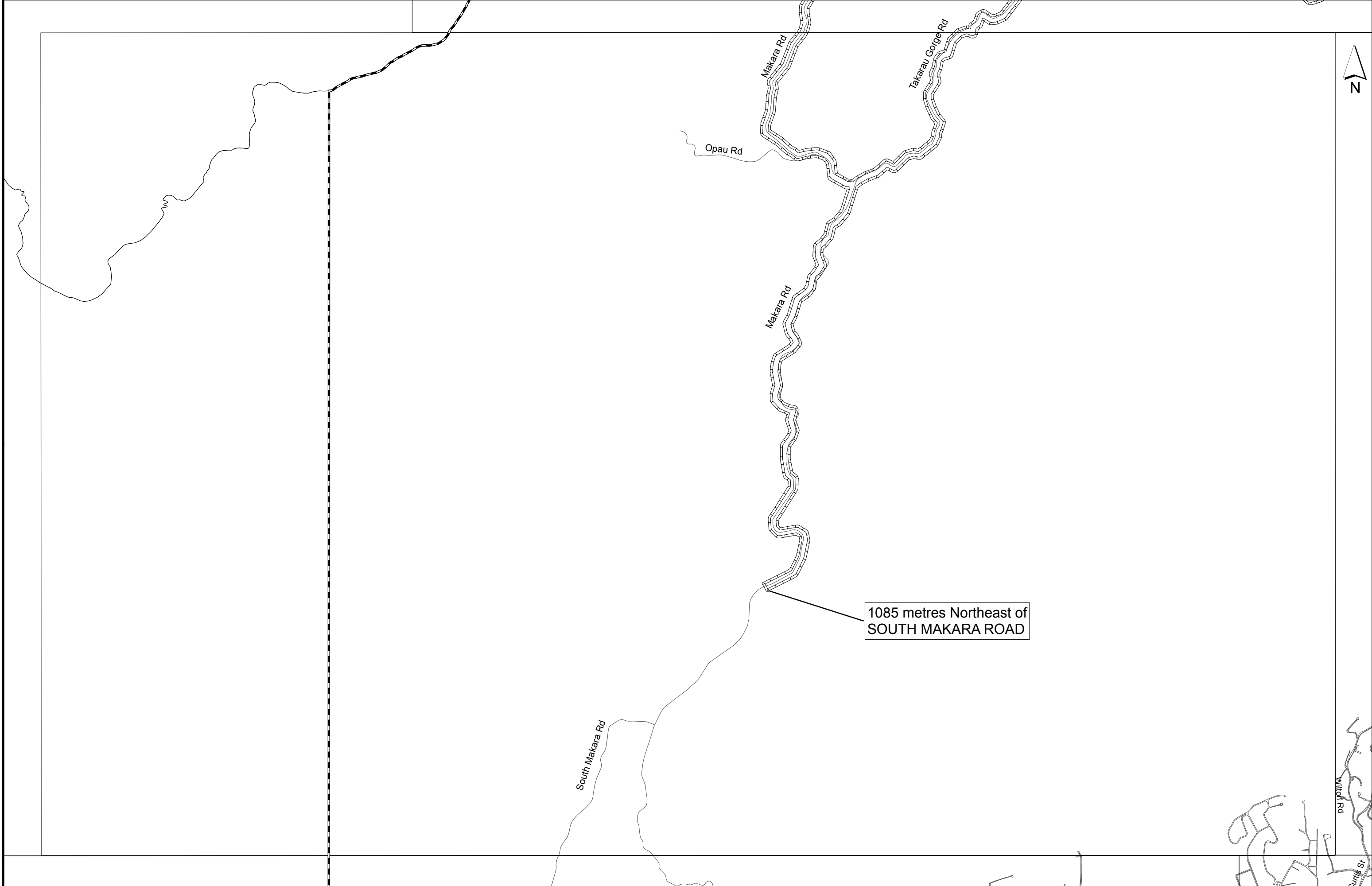

# Wellington City Speed Limits

## SL 7

Refer to SL 1 for Map Legend

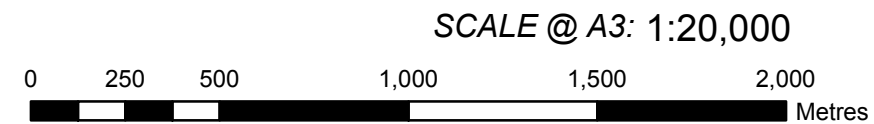

Property boundaries Land Information NZ Licence WN0853547/2 CROWN COPYRIGHT RESERVED. Accuracy in urban areas: +/-1m. Accuracy in rural areas: +/-30m. Topographic data: Wellington City Council WCC copyright reserved Accuracy: +/- 30cm. Any contours displayed are only approximate and must not be used for detailed engineering design. Colour Orthophotography 1:500 flown March 2006 or Feb 2008 owned by Wellington City Council. Other data has been compiled from a variety of sources and its accuracy may vary.



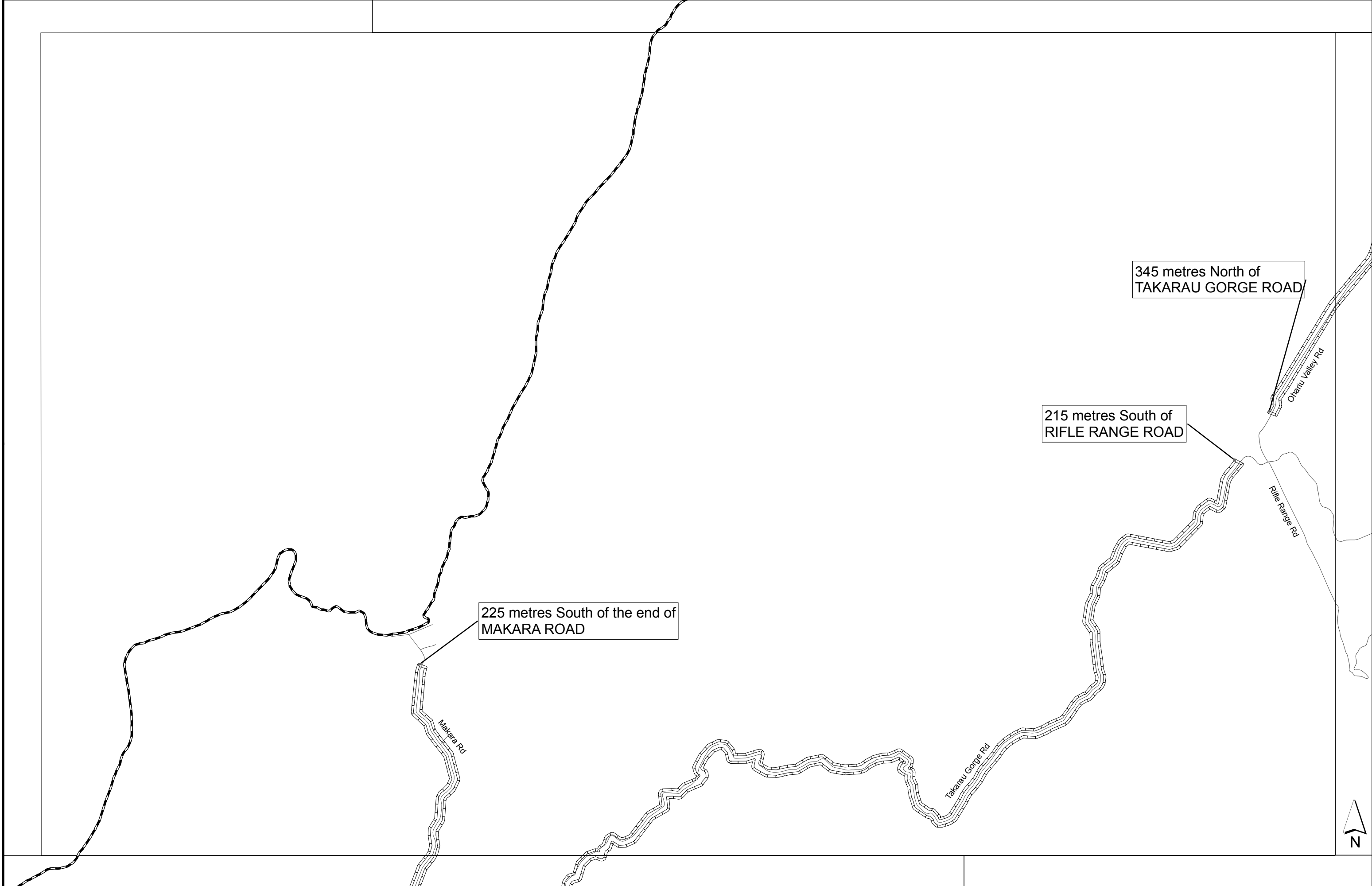

# Wellington City Speed Limits

## SL 8

Refer to SL 1 for  
Map Legend

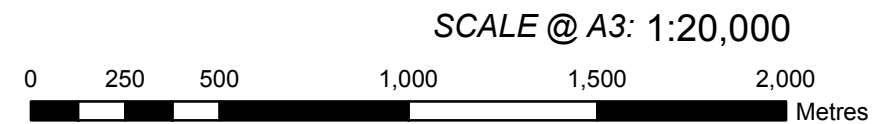

Property boundaries Land Information NZ Licence WN0853547/2 CROWN COPYRIGHT RESERVED. Accuracy in urban areas: +/-1m. Accuracy in rural areas: +/-30m. Topographic data: Wellington City Council WCC copyright reserved Accuracy: +/- 30cm. Any contours displayed are only approximate and must not be used for detailed engineering design. Colour Orthophotography 1:500 flown March 2006 or Feb 2008 owned by Wellington City Council. Other data has been compiled from a variety of sources and its accuracy may vary.





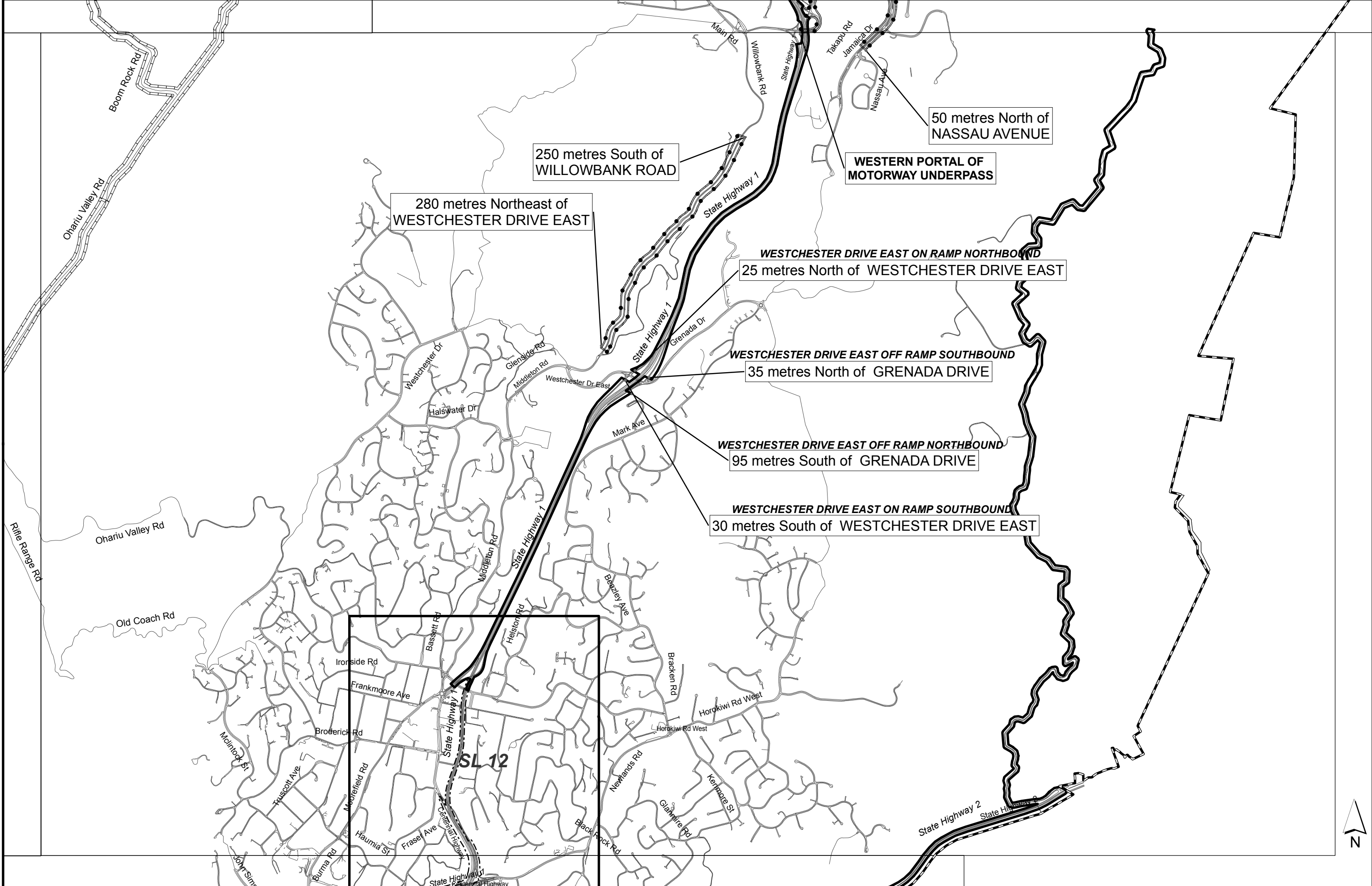

# Wellington City Speed Limits

## SL 9

Refer to SL 1 for Map Legend

Property boundaries Land Information NZ Licence WN0853547/2 CROWN COPYRIGHT RESERVED. Accuracy in urban areas: +/-1m. Accuracy in rural areas: +/-30m. Topographic data: Wellington City Council WCC copyright reserved Accuracy: +/- 30cm. Any contours displayed are only approximate and must not be used for detailed engineering design. Colour Orthophotography 1:500 flown March 2006 or Feb 2008 owned by Wellington City Council. Other data has been compiled from a variety of sources and its accuracy may vary.



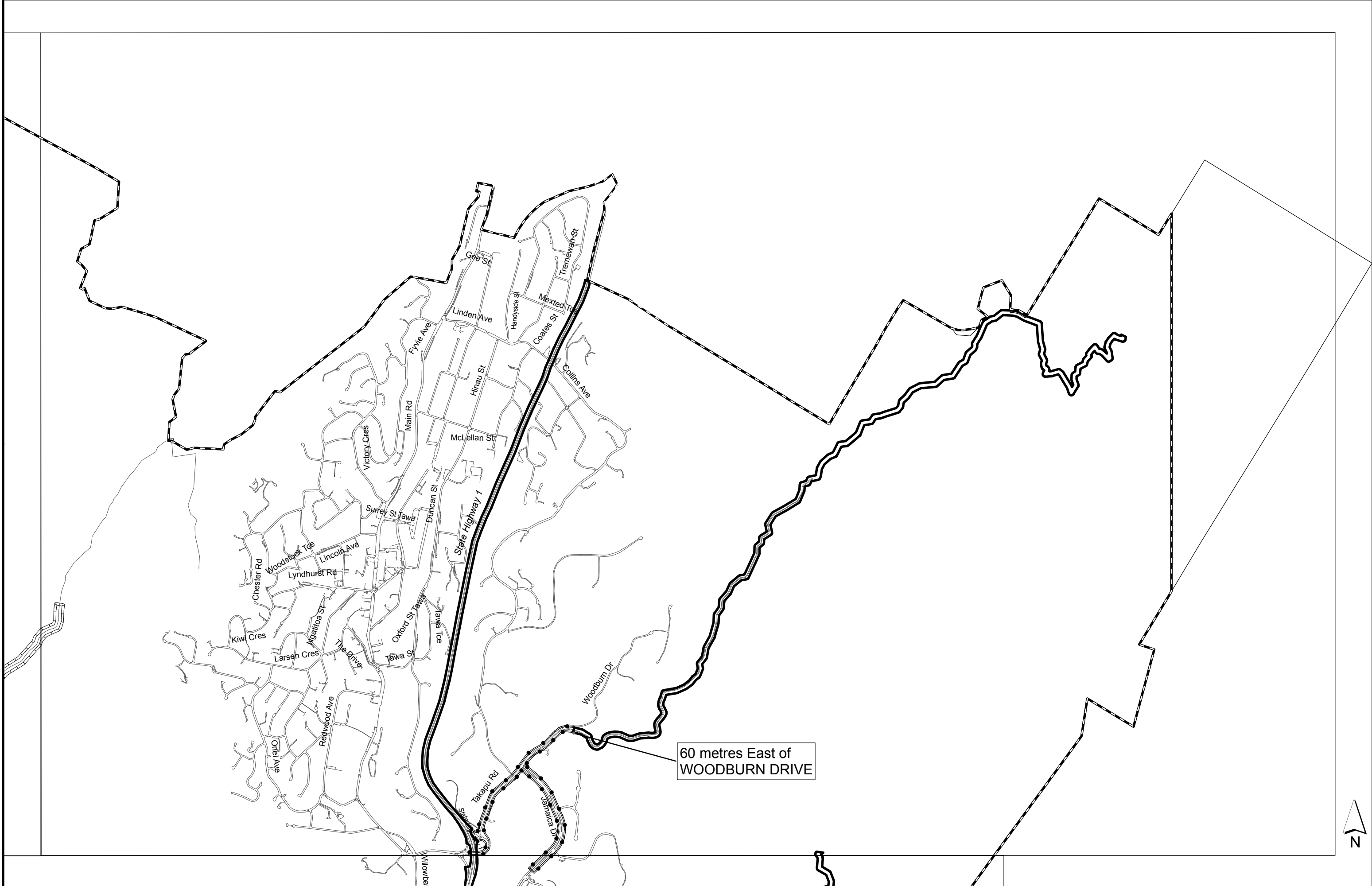

# Wellington City Speed Limits

## SL 10

Refer to SL 1 for  
Map Legend

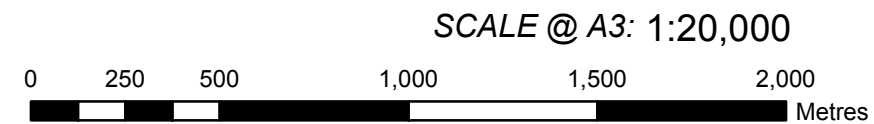

Property boundaries Land Information NZ Licence WN0853547/2 CROWN COPYRIGHT RESERVED. Accuracy in urban areas: +/-1m. Accuracy in rural areas: +/-30m. Topographic data: Wellington City Council WCC copyright reserved Accuracy: +/- 30cm. Any contours displayed are only approximate and must not be used for detailed engineering design. Colour Orthophotography 1:500 flown March 2006 or Feb 2008 owned by Wellington City Council. Other data has been compiled from a variety of sources and its accuracy may vary.

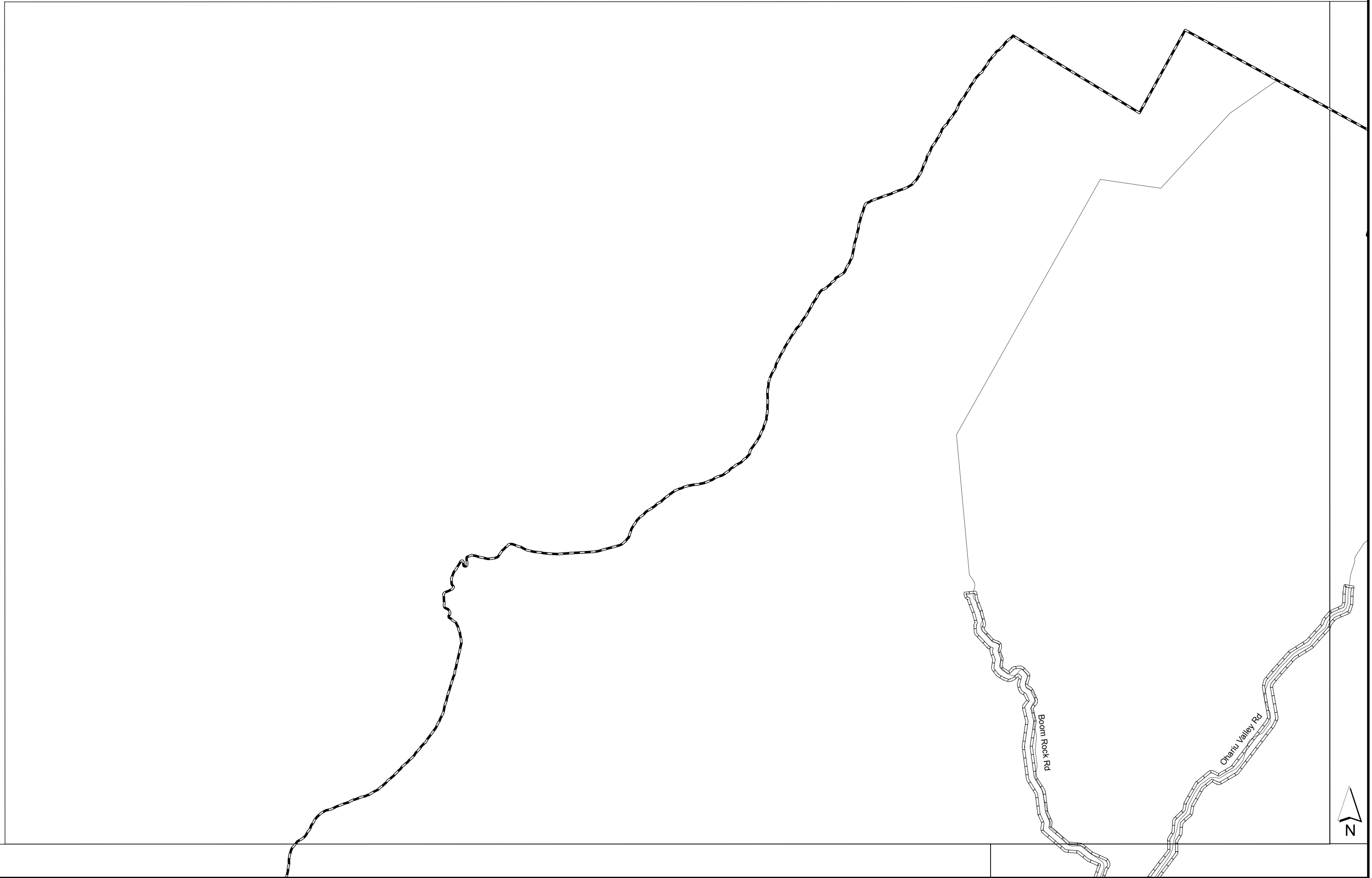

# Wellington City Speed Limits

## SL 11

Refer to SL 1 for  
Map Legend

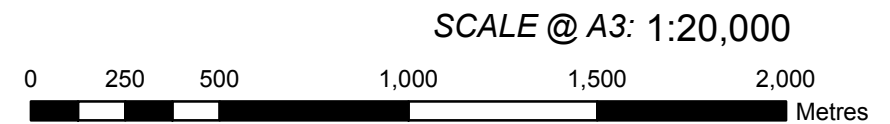

Property boundaries Land Information NZ Licence WN0853547/2 CROWN COPYRIGHT RESERVED. Accuracy in urban areas: +/-1m. Accuracy in rural areas: +/-30m. Topographic data: Wellington City Council WCC copyright reserved Accuracy: +/- 30cm. Any contours displayed are only approximate and must not be used for detailed engineering design. Colour Orthophotography 1:500 flown March 2006 or Feb 2008 owned by Wellington City Council. Other data has been compiled from a variety of sources and its accuracy may vary.



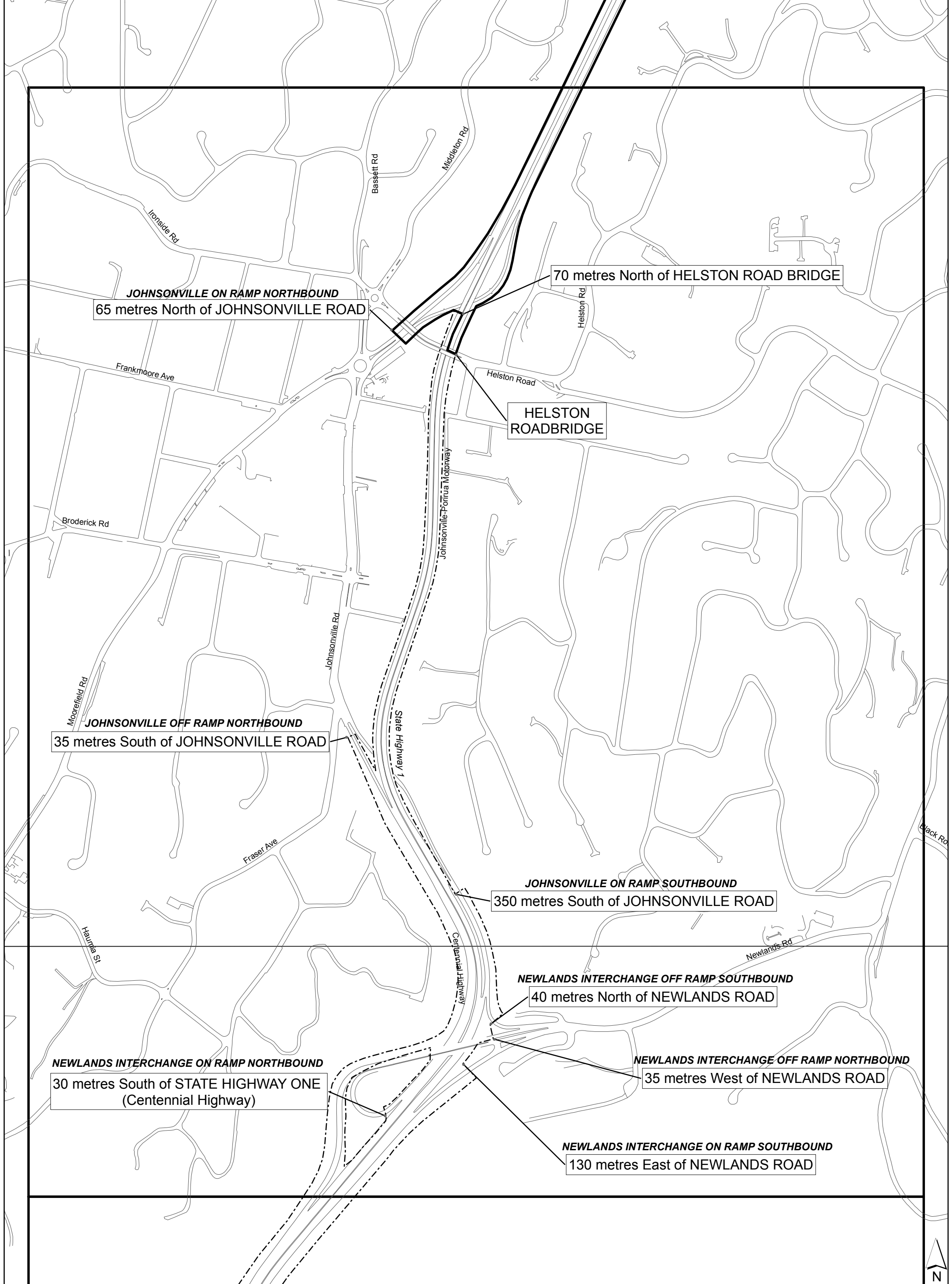

# Wellington City Speed Limits

## SL 12

SCALE @ A3: 1:5,500

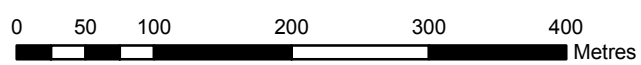

Refer to SL 1 for Map Legend

Property boundaries Land Information NZ Licence WN085347/2 CROWN COPYRIGHT RESERVED. Accuracy in urban areas: +/-1m, Accuracy in rural areas: +/-30m. Topographic data: Wellington City Council WCC copyright reserved Accuracy: +/- 30cm. Any contours displayed are only approximate and must not be used for detailed engineering design. Colour Orthophotography 1:500 flown March 2006 or Feb 2008 owned by Wellington City Council. Other data has been compiled from a variety of sources and its accuracy may vary.



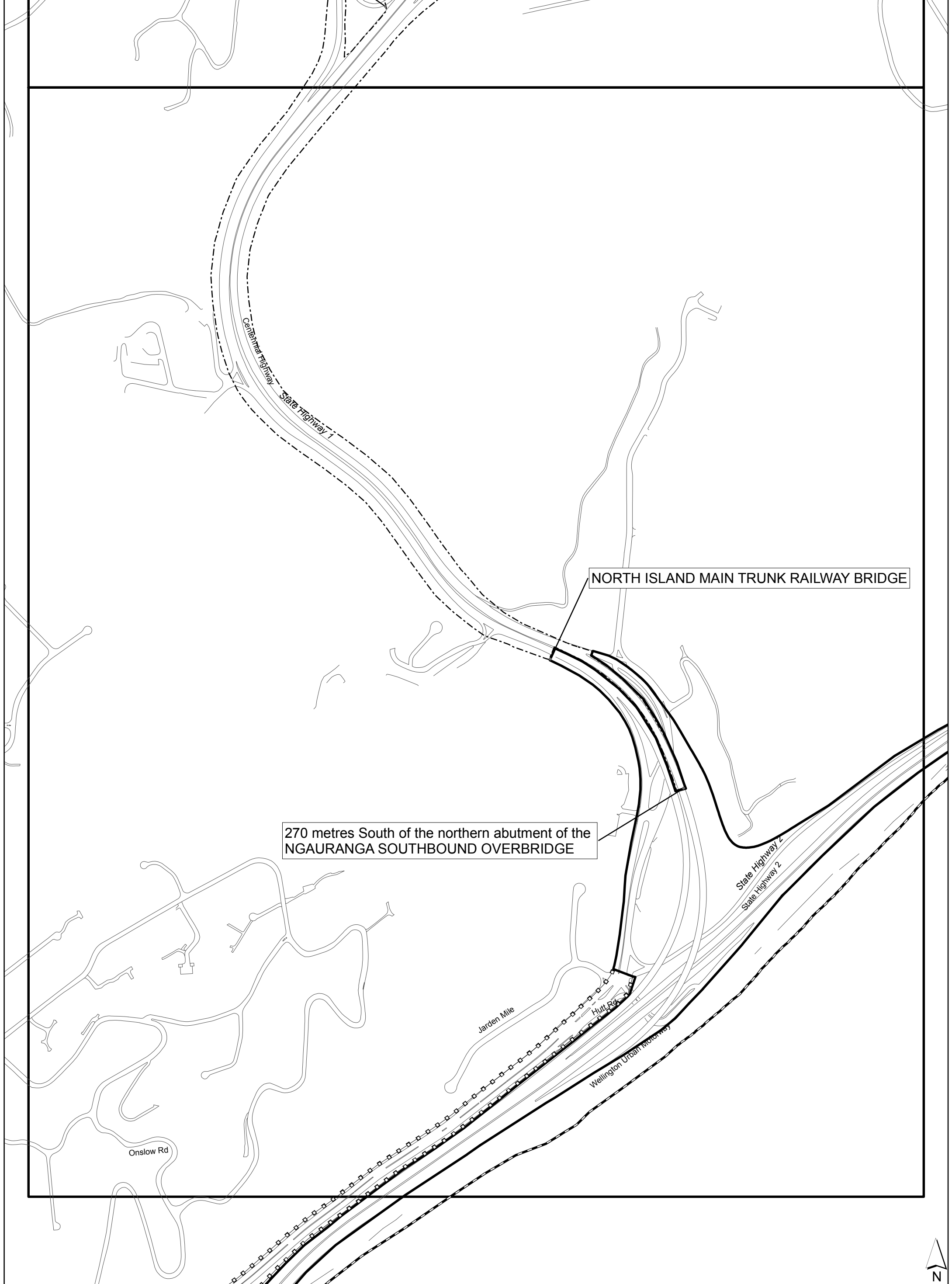

NORTH ISLAND MAIN TRUNK RAILWAY BRIDGE

270 metres South of the northern abutment of the NGAURANGA SOUTHBOUND OVERBRIDGE

Onslow Rd

Jarden Mile

Hutt Rd

Wellington Urban Motorway

State Highway 2  
State Highway 2



# Wellington City Speed Limits

## SL 13

SCALE @ A3: 1:5,500

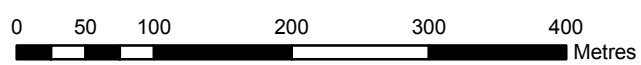

Refer to SL 1 for Map Legend

Property boundaries Land Information NZ Licence WN0853547/2. CROWN COPYRIGHT RESERVED. Accuracy in urban areas: +/-1m, Accuracy in rural areas: +/-30m. Topographic data: Wellington City Council WCC copyright reserved Accuracy: +/- 30cm. Any contours displayed are only approximate and must not be used for detailed engineering design. Colour Orthophotography 1:500 flown March 2006 or Feb 2008 owned by Wellington City Council. Other data has been compiled from a variety of sources and its accuracy may vary.



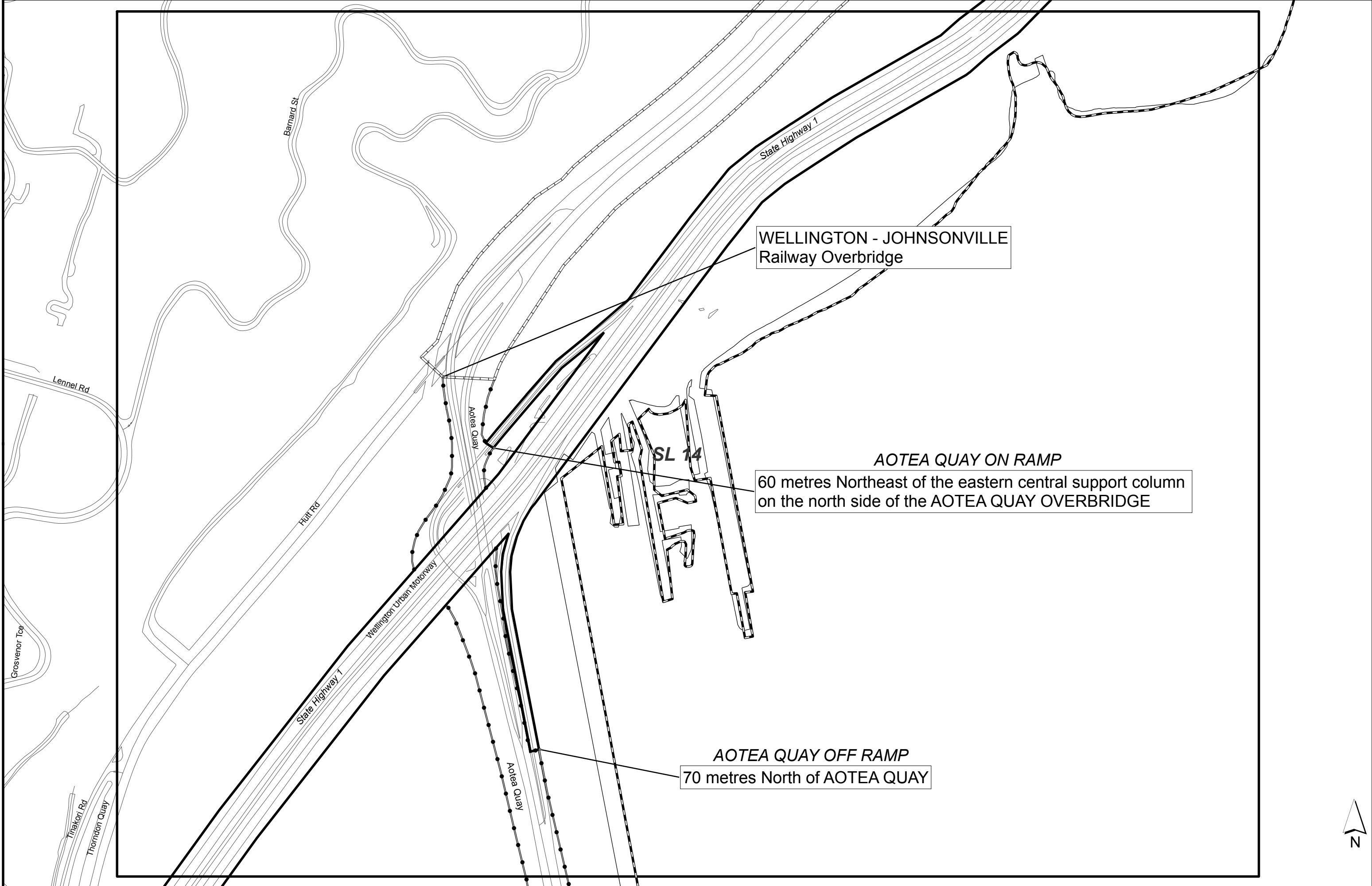

# Wellington City Speed Limits

## SL 14

Refer to SL 1 for Map Legend

SCALE @ A3: 1:3,000

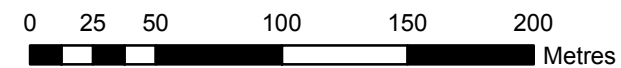

Property boundaries Land Information NZ Licence WN0853547/2 CROWN COPYRIGHT RESERVED. Accuracy in urban areas: +/-1m, Accuracy in rural areas: +/-30m. Topographic data: Wellington City Council WCC copyright reserved Accuracy: +/- 30cm. Any contours displayed are only approximate and must not be used for detailed engineering design. Colour Orthophotography 1:500 flown March 2006 or Feb 2008 owned by Wellington City Council. Other data has been compiled from a variety of sources and its accuracy may vary.

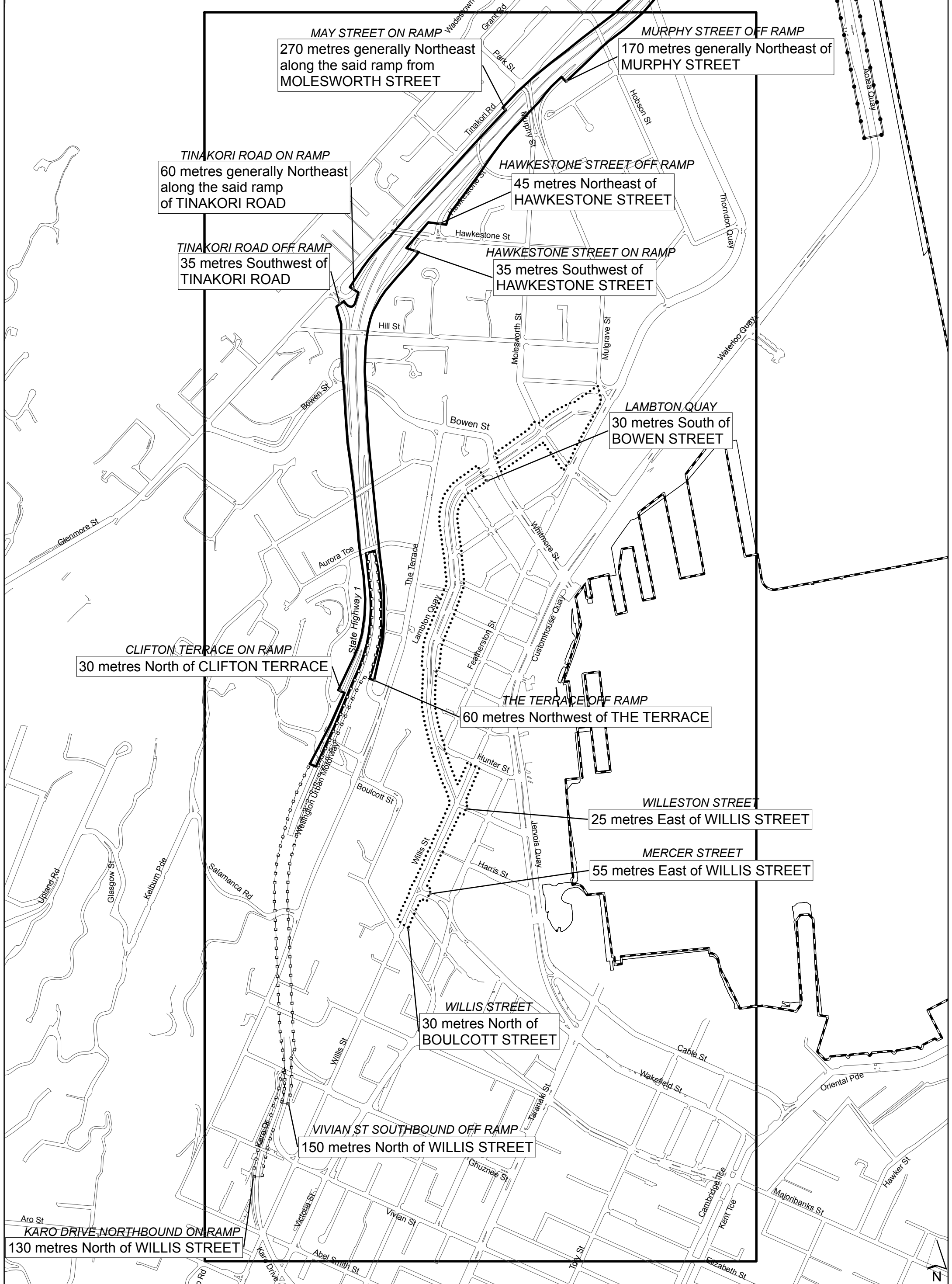

# Wellington City Speed Limits

## SL 15

SCALE @ A3: 1:7,500

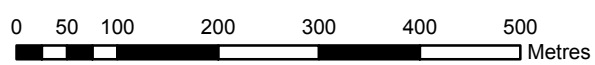

Refer to SL 1 for Map Legend

Property boundaries Land Information NZ Licence WN085347/2 CROWN COPYRIGHT RESERVED. Accuracy in urban areas: +/-1m, Accuracy in rural areas: +/-30m. Topographic data: Wellington City Council WCC copyright reserved Accuracy: +/-30cm. Any contours displayed are only approximate and must not be used for detailed engineering design. Colour Orthophotography 1:500 flown March 2006 or Feb 2008 owned by Wellington City Council. Other data has been compiled from a variety of sources and its accuracy may vary.



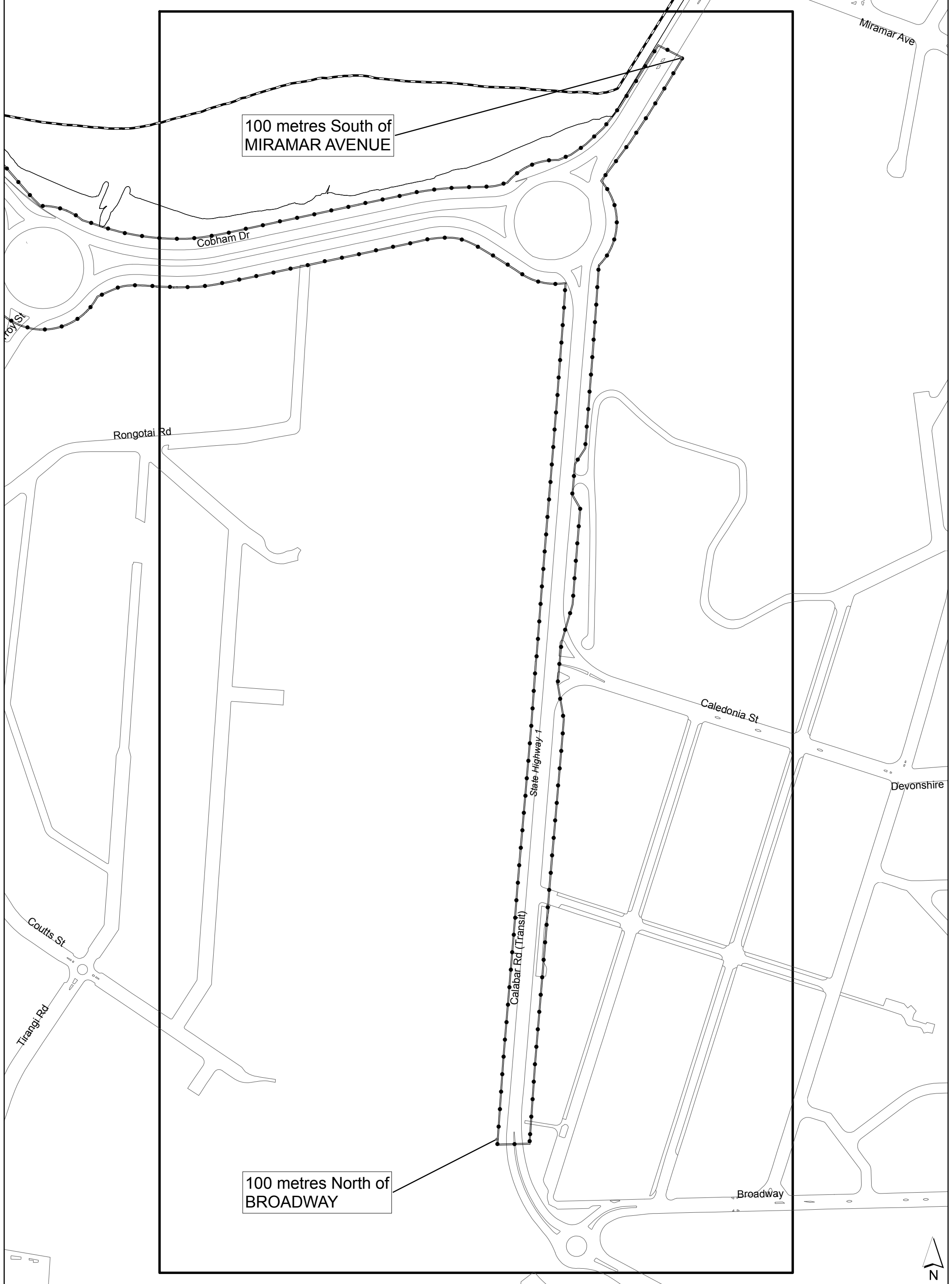

# Wellington City Speed Limits

## SL 16

SCALE @ A3: 1:3,200

Refer to SL 1 for Map Legend



Property boundaries Land Information NZ Licence WN0853547/2. CROWN COPYRIGHT RESERVED. Accuracy in urban areas: +/-1m, Accuracy in rural areas: +/-30m. Topographic data: Wellington City Council WCC copyright reserved Accuracy: +/- 30cm. Any contours displayed are only approximate and must not be used for detailed engineering design. Colour Orthophotography 1:500 flown March 2006 or Feb 2008 owned by Wellington City Council. Other data has been compiled from a variety of sources and its accuracy may vary.

