

Application for On-Licence Renewal or On-Licence Variation

Section 120 or 127, Sale and Supply of Alcohol Act 2012

To: The Secretary
District Licensing Committee
PO Box 2199
Wellington 6140

Please PRINT clearly.

1. Details of application

Type of application sought (please tick appropriate box/es) Variation of conditions (including redefinition of licensed area) Renewal of licence

2. Endorsements

Type of endorsement sought on the licence if applicable (please tick appropriate box)

- BYO Restaurant - applies to BYO only restaurants
- Caterer - off-site catering, instead of or in addition to food/alcohol supplied on the premises. You will need to provide evidence of catering eg menus, web info, booking agreement.

3. Details of applicant

(a) Full legal name/s of the person/s or company who will receive any proceeds from alcohol sales (include a list of any other names including a maiden name that you may be known by)

1313 LTD

(b) Applicant status

- Individual
- Private company
- Partnership
- Body corporate

- Public company
- Club
- Trustee
- Local Authority

- Licensing trust
- Government Department or other instrument of the Crown
- Manager under the Protection of Personal and Property Rights Act 1988
- Board, organisation or other body

(c) Address

20 RONGOTAI RD, KILBIRNIE.

(d) Occupation

DIRECTOR.

(e) Male Female Other (if individual)

(f) Applicant's date and place of birth (if individual)

14/11/85 LUDHIANA PUNJAB INDIA

(g) Postal address for service documents

120A BURNS STREET LAMINGTON, CAMBRIDGE

(h) Contact details

DEVINDER PAL SINGH

Daytime contact name

0204900001

Fax number

Phone number(s)

0204900001

Email address

J.S1424 @ OUTLOOK.COM

Preferred mode of contact

PHONE

(i) Describe the principal purpose of the business ie what type of premises

SALE & SUPPLY OF ALCOHOL and FOOD.

12

050018
(i) State all criminal convictions (except convictions for offences to which the Criminal Records (Clean Slate) Act 2004 applies)
— NONE —

4. Further details where the applicant is a company or an incorporated society

(a) Where the applicant is a **private company** give full details of each person who holds any shares issued by the company as follows: name, address, date of birth, place of birth, designation, % of shares held (please continue on a separate sheet if necessary).
DEVINDER PAL SINGH, 120A BURNS ST, LEAMINGTON, 14-11-85
INDIA, DIRECTOR, 290 %
JASWINDER KAUR, 120A BURNS ST, LEAMINGTON, INDIA, SHAREHOLDER,
10 %

(b) Where an applicant is a **public company** give full details of each person who holds 20 percent or more of the shares, or of any particular class of shares, issued by the company as follows: name, address, date of birth, place of birth, designation (please continue on a separate sheet if necessary).

5. Further details where the applicant is a partnership

(a) Full details of each partner as follows: name, address, date of birth, place of birth

(b) Signature of each partner

6. Body corporate

Please state the authority under which it is incorporated

7. Details of premises

(a) Address
KILBIRNIE PALAZA
20 LONGTAL RD, KILBIRNIE.

(b) Trading name for the premises
TURBO BAR.

(c) Is the licence sought conditional upon construction or alteration of the premises?

Yes No If yes please provide details

(d) Does the applicant own the licensed premises?

Yes No

If no,

(e) (i) What is the full name, address and contact details (email and phone number) of the owner?

KAN LEOS TRUST

(ii) What form of tenure and term of tenure will the applicant have?

9 YEARS

(f) What part (if any) of the premises does the applicant intend should be designated as:

(i) A supervised area (ie an area where minors must be accompanied by their parent or legal guardian)

ALL BAR AREA

(ii) A restricted area (ie is an area that is R18)

GAMING AREA NONE

If no parts of the premises are to be designated, write 'none' on each line above

8. Details of conveyance

(a) Type of conveyance (plane, boat, train, bus)

(b) Address of home base

(c) Principal route travelled

(d) Trading name used or proposed for the conveyance

(e) Does the applicant own the conveyance?

Yes No

If no,

(i) What is the full name and address of the owner?

(ii) What form of tenure and term of tenure of the conveyance will the applicant have?

1 2052018
(f) Is a current Safe Ship Management Certificate (if a ship, ferry or hovercraft) or a current Certificate of Airworthiness (if a plane) or a Rail Service Licence (if a train) or current warrant of registration (if a car or a bus) in effect for this conveyance?

Yes No Registration number: _____

9. Business details

(a) Is the sale of alcohol the principal purpose of the business?

Yes No

If no, what is the principal purpose of the business?

(c) Is the applicant engaged, or intending to be engaged on the premises, in the sale or supply of any goods other than alcohol and food, or in the provision of any services other than those directly related to the sale and supply of alcohol and food?

Yes No

If yes, what is the nature of those other goods or services?

(d) On which days and during which hours does the applicant propose to sell or supply alcohol under the licence?

(BYO only applicants - fill in days and hours of trading)

Days: MON - SUN

Hours: 8.00 am - 2.00 am the following day.

10. Details of managers

Full name and address of managers to be employed, certificate numbers of managers and expiry date of each certificate.

DEVINDER PAL SINGH.	- 16 / CERT / 16 / 2017	-	2021
PARDUMAN SINGH	- 49C / CERT / 478 / 2017	-	26 / AUG / 2020
KIRANDEE KAUR	- 49C / CERT / 621 / 2018	=	4 / OCT / 19

11. Conditions

(a) Describe experience and training in the sale and supply of alcohol

Have Managed / owned licenced premises for over 5 years with no issues.

(b) Describe in detail how or what is to be available for purchase in respect to:

(i) food (please describe type and range) Note: at least 3 types of substantial food must be available

Food menu attached

(ii) non-alcoholic refreshments (please describe type and range)

DRINK MENU ATTACHED

(iii) low-alcohol beverages (please describe type and range) Note: beverages no more than 2.5% alcohol by volume

DRINK MENU ATTACHED

(iv) How is drinking water intended to be made freely available to patrons (describe)

FREE WATER AVAILABLE AT THE BAR

(c) What steps does the applicant propose to prevent the sale and supply of alcohol to prohibited people? ie minors and intoxicated persons

ALCOHOL WILL NOT BE SERVED TO INTOXICATED PATRONS and MINORS. ALL ID'S WILL BE CHECKED. IF LOOKS UNDER 25. THEY WILL BE ASKED TO VACUATE THE PREMISES ASAP.

(d) What steps does the applicant propose to provide help with, and information about, transport options from the licensed premises?

TAXI'S NUMBER WILL BE DISPLAYED AT AND BEHIND THE BAR. FREE CALLS TO THE TAXI'S STAND WILL BE MADE.

(e) What other steps does the applicant propose to take which are aimed at promoting the responsible consumption of alcohol?

FREE WATER WILL BE AVAILBLE
WATER STATION AVAILBLE NEXT TO THE BAR

(f) What other systems (including training systems for staff) are in place (or are to be in place) for compliance with the Act?

DUTY MANAGER PRESENT ALL TIME
MEETING WITH STAFF EVERY FOSTRIGHT DISCUSSING ANY ISSUES
KEEP VERY CLOSE LOOK ON INTOXICATION, ID CHECKS DONE REGURLY

Please note: The New Zealand Police are required by the Sale and Supply of Alcohol Act 2012 to make enquiries into the suitability of the applicant. This will involve the Police informing the District Licensing Committee of any convictions or concerns involving the applicant. Should there be any concerns the applicant will also be informed.

Dated at Wellington this	08	day of	OCT	20	18
Print name	DEVINDER PAL SINGH	Applicant's signature	Devinder Pal,		
Print name		Applicant's signature			

Notes

1. Within 20 working days after filing this application, the applicant is required to give public notice of the application on the WCC website, in the Dominion Post or Wellingtonian. If you choose to advertise on the WCC website you do not need to advertise in the newspaper.
2. Except in the case of conveyance, within 10 working days after filing this application, the applicant must attach a notice on or adjacent to the site in a place that can be seen easily by members of the public. We will return the notice for display after checking the draft.

Privacy statement

Information contained in your application and any supporting information will be held by Wellington City Council to enable your application to be processed under the Sale and Supply of Alcohol Act 2012. This information will be made available to the public and will be linked to the public notice for your application on the Council's website. The information will be provided to the Wellington District Licensing Committee, the Police, the Medical Officer of Health and the Council's Licensing Inspectors. This information may form part of a public hearing of your application before the Wellington District Licensing Committee and may be used in the Committee's decision for your application. Decisions will be made publicly available.

The Council is required to keep a statutory register of all alcohol licence applications and the District Licensing Committee's decisions on them. The Council is required to report statistics about applications to the Alcohol Regulatory and Licensing Authority. Any member of the public may request access to this information under the Local Government Official Information and Meetings Act 1987. This information may also be used under the Privacy Act 1993. You have the right to see and correct personal information that the Council holds about you.

TURBO BAR KILBIRNIE

12052018

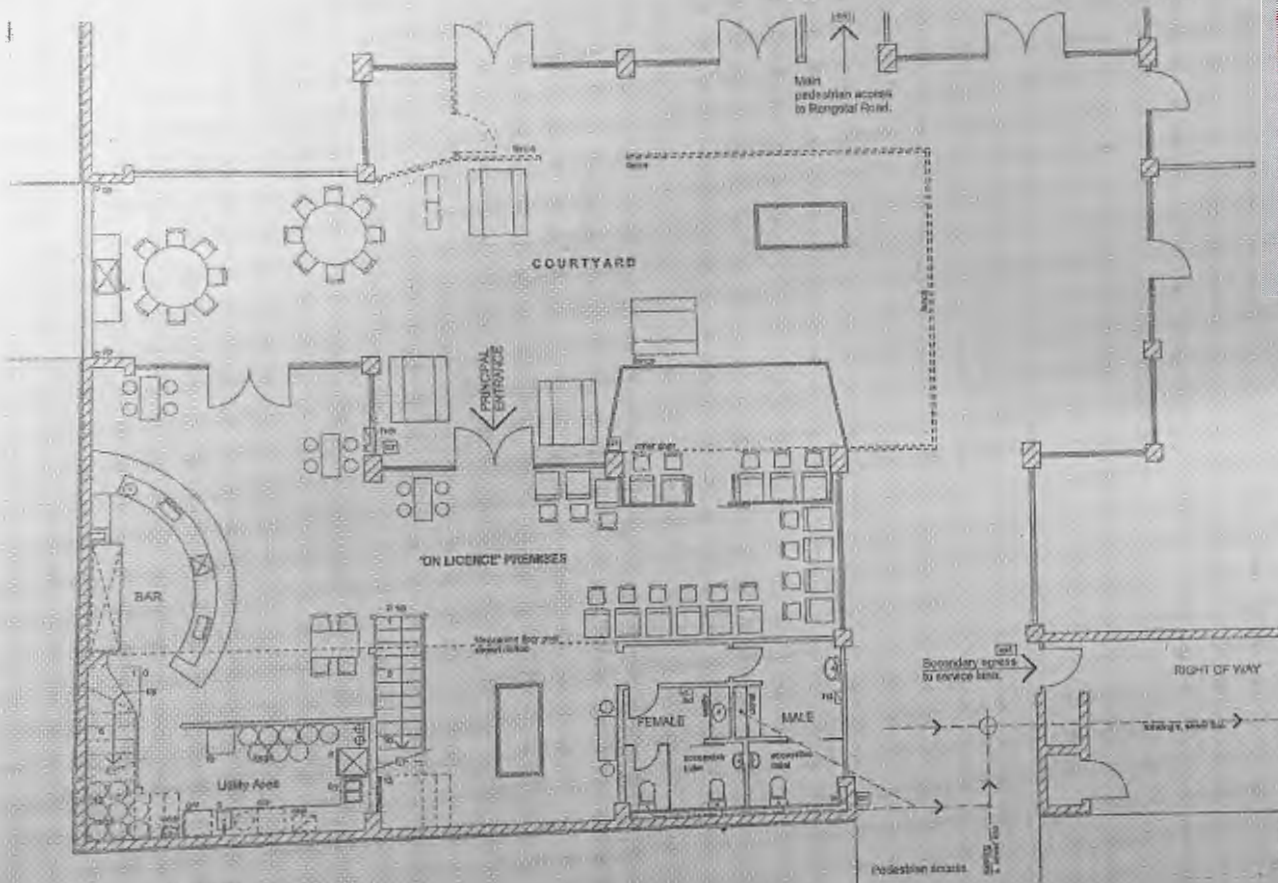

WELLINGTON CITY COUNCIL
 PUBLIC HEALTH
 3 DEC 2018
 RECEIVED
 WAKEFIELD ST., WELLINGTON

- GENERAL NOTES:
1. These drawings are to be used in conjunction with all other relevant documents including specifications.
 2. Contractor to verify all levels and dimensions on site before commencement of work.
 3. Contractor to report any structural discrepancy to the Architect for interpretation prior to the affected work proceeding.
 4. All Barter treatment in accordance with NZS 3902.

REV | COMMENT | DATE
 MARTYN PIERCE
 NZ REGISTERED ARCHITECT

REPRODUCTION OF THE WHOLE OR PART OF THIS DOCUMENT CONSTITUTES AN INFRINGEMENT OF COPYRIGHT RIGHTS. ALL RIGHTS RESERVED.

PIERCE, JRC, MARTY, LTD
 11/1/2018

22 Cambridge Terrace
 P.O. Box 1014 WELLINGTON 6141
 New Zealand
 Tel: (64) (0) 325 3235
 Email: jpc@pijrc.co.nz

PROJECT:
 Shop 5, 7 & 8
 No. 20 Rosedale Road
 KILBIRNIE
 CLIENT:
 KILBIRNIE TAKENI Q&S LTD.
 SHEET TITLE:
 LIQUOR LICENCE
 FLOOR PLAN - AS EXISTING
 JOB No.
 11:47:131
 Date: 11/19/18
 Drawn by: [signature]



FLOOR PLAN - AS EXISTING

INDICATES AREA OF LICENSED PREMISES



BASEMENT FLOOR PLAN - AS EXISTING

INDICATES AREA OF LICENSED PREMISES

ALL AREAS SUPERVISED