

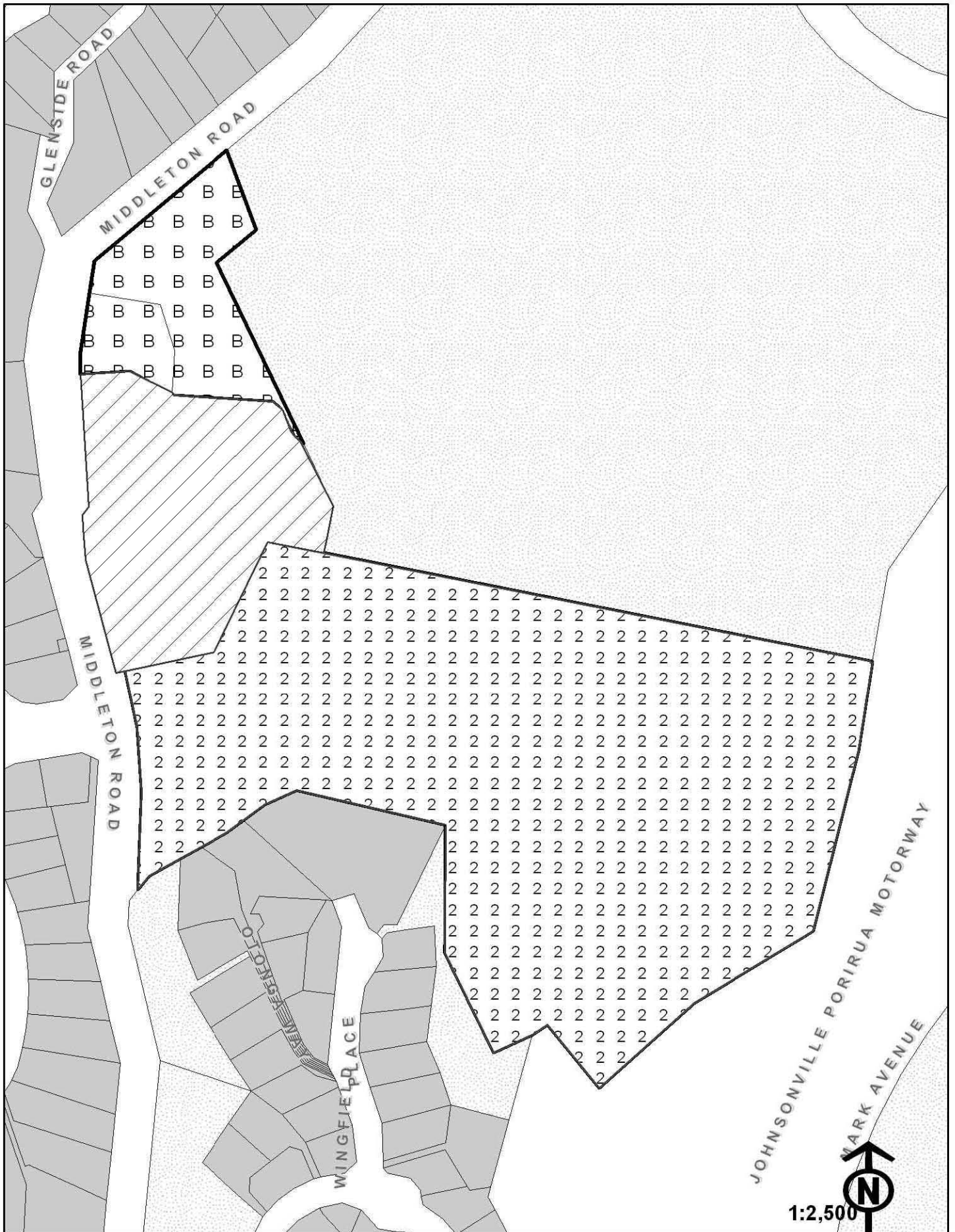





# Glenside



## Proposed Rezoning

-  Suburban Centre to Outer Residential
-  Suburban Centre to Business 1
-  Suburban Centre to Business 2

## Existing Zoning

-  Outer Residential
-  Open Space B

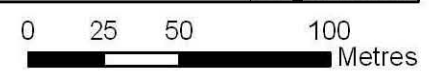

*Note: All sites with existing 'Suburban Centre' zoning will be zoned 'Centre' unless otherwise stipulated.*