

---

**REPORT 2**  
(1215/11/IM)

**Report of the Strategy and Policy Committee**  
**Meeting of Thursday 5 April 2007**

**Members:** Mayor Prendergast, Councillors Armstrong (Chair), Ahipene-Mercer, Cook, Foster, Gill, Goulden, McKinnon, Morrison, Pepperell, Ritchie, Ruben, Shaw, Wade-Brown and Wain.

**THE COMMITTEE RECOMMENDS:**

1. **ITEM 061/07P KHOURI AVENUE RESERVE LAND EXCHANGE**  
(1215/52/IM) (REPORT 2)

*THAT Council:*

1. *Use its delegated powers under section 15 of the Reserves Act 1977 in considering firstly the authorisation of the proposed exchange, and secondly the request for the exchange.*
2. *Approve the exchange of part of the Recreation Reserve at Sec 1 SO 32138 as marked Area A in figure One for part of the fee simple land at Lot 2 DP 52184 as marked Area B in figure One under section 15 of the Reserves Act 1977.*

*See next page for Figure One which is the Reserve Land Exchange areas*

**Alick Shaw**  
**Acting Chair**

# Reserve Land Exchange areas

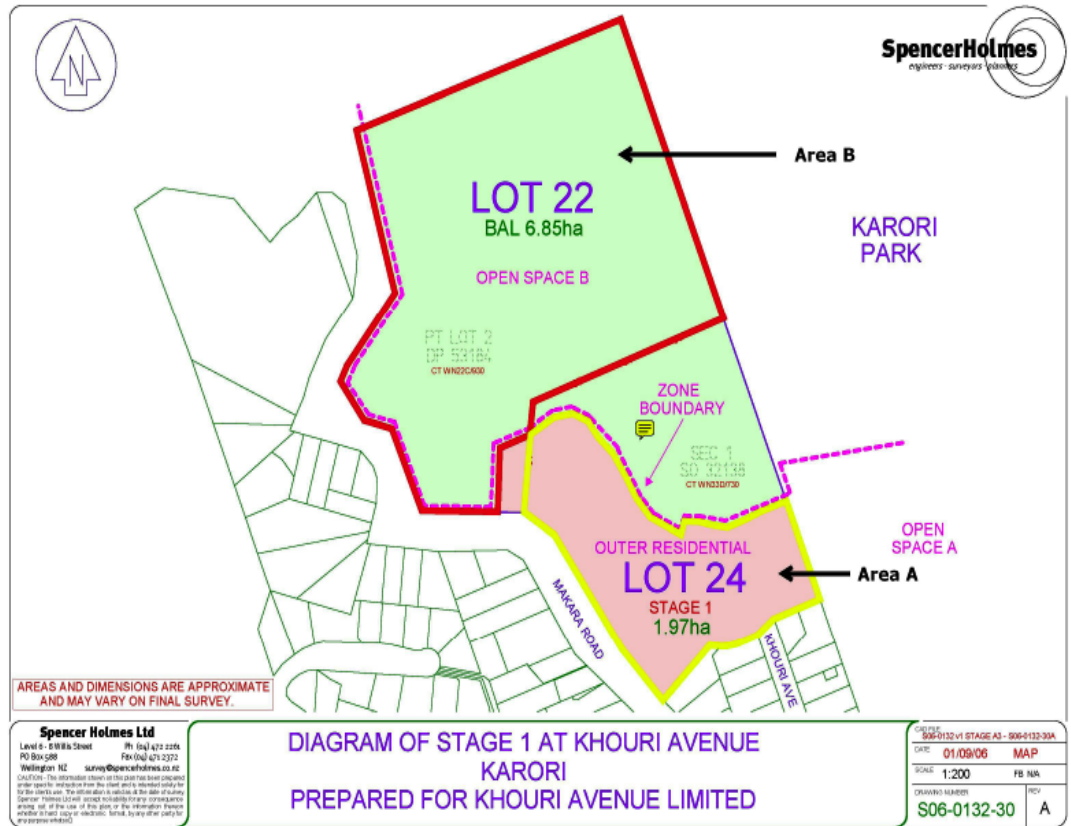

AREAS AND DIMENSIONS ARE APPROXIMATE AND MAY VARY ON FINAL SURVEY.

**Spencer Holmes Ltd**  
 Level 6 - 8 Willis Street    Ph: (64) 477 2226  
 PO Box 508    Fax: (64) 477 2272  
 Wellington NZ    survey@spencerholmes.co.nz

CAUTION - The information shown on this plan has been prepared by the specific professional from the level and is intended only for the use for which it was prepared. The information is intended to be used in conjunction with the relevant legislation and the professional's certificate. Spencer Holmes Ltd will accept no liability for any consequences arising out of the use of this plan or the information shown, whether in hard copy or electronic form, by any other party for any purpose whatsoever.

**DIAGRAM OF STAGE 1 AT KHOURI AVENUE  
 KARORI  
 PREPARED FOR KHOURI AVENUE LIMITED**

Original: S06-0132-V1 STAGE A3 - 006-0132-00A	MAP
DATE: 01/09/06	FB N/A
SCALE: 1:200	REV: A
DRAWING NUMBER: S06-0132-30	