

Land Transfer Office
 Received Plan 29742
 Title Reference 5A/1491
 FOOT FEE \$8
 Referred to L.T. Surveyor 22/7/68

Lots 1 and 2
 H.M. Cook

The Wellington City Council certifies that there is no operative district scheme under the Town and Country Planning Act 1953 which affects the subdivision shown hereon.
 Dated at Wellington this 19th day of July 1968
 Deputy Town Clerk

Deposited this _____ day
 of _____ 19____
 District Land Registrar

29742

Passed to a resolution passed on the 10th day of July 1968, the Wellington City Council, in accordance with Section 201 of the Municipal Corporations Act 1953, do hereby assent to the Subdivision hereon shown subject to the condition that it shall be made subject to the will of L.T. P. 29398/2.
 Dated at Wellington this 11th day of July 1968
 Deputy Town Clerk

PLAN FILE

PLAN OF SUBDIVISION OF
 PI LOT 1 D.P. 28764 BEING PI-SEC 24 OWHIRO DIST

Total Area 4a-1a-135p

Approved as to Survey
 Chief Surveyor
 22/7/68

Appellation Compared
 With K. 4525/1

Approved

Applicant or Registered Owner
 This space reserved for plan number

Received
 Reference plans D.P. 28764, D.P. 28764, D.P. 28764
 Field book 249 (52-154)
 Traverse book 265 (219-220)
 Examined by K. Turner 26/7/68
 Recorded by J. S. J.
 Correct by J. S. J.
 L. T. Surveyor

Comprised in CT 5A/1491 (PI)
 Survey Block & District APORT NICHOLSON
 Land District WELLINGTON Local Body WELLINGTON CITY COUNCIL
 Scale 1 CHAIN TO AN INCH Surveyed by B.P. PLAYER Date JUNE 1968
 Registered Surveyor and holder of an annual practicing certificate, do solemnly and sincerely declare that this plan has been made from surveys executed by me; that both plan and survey were made in accordance with the regulations under the Surveyors Act, 1952.
 And I make this solemn declaration, conscientiously believing the same to be true and by virtue of the Oaths and Declarations Act 1957.
 Declared at Wellington this 21st day of July 1968
 Justice of the Peace (or other person authorized to take a statutory declaration)

29742

Land Transfer Office
 Received this 27th day of February 1968
 Title Reference 29398
 Referred to L. T. Surveyor 22-3-68

LAND DISTRICT OF WELLINGTON
 District Land Registrar

29398 Lot 1

Subsequent Reference	Download Reference	Reverse Volume
Lot 1	Ref 141 R.P. 26398	E.O.W. 16110

Herewith 3 sections passed on the day of February 1968 the Wellington City Council in accordance with Section 211 of the Municipal Corporations Act 1953 and hereby approve the subdivisions shown herein

The Wellington City Council certifies that there is no operative district scheme under the Town and Country Planning Act 1953 which affects the subdivisions shown herein.

Dated at Wellington this 13th day of February 1968

Deputy District Clerk

The Common Seal of the Mayor, Councillors and Citizens of the City of Wellington was hereunto placed at the office of and remained in a visible place of the City Council in the presence of

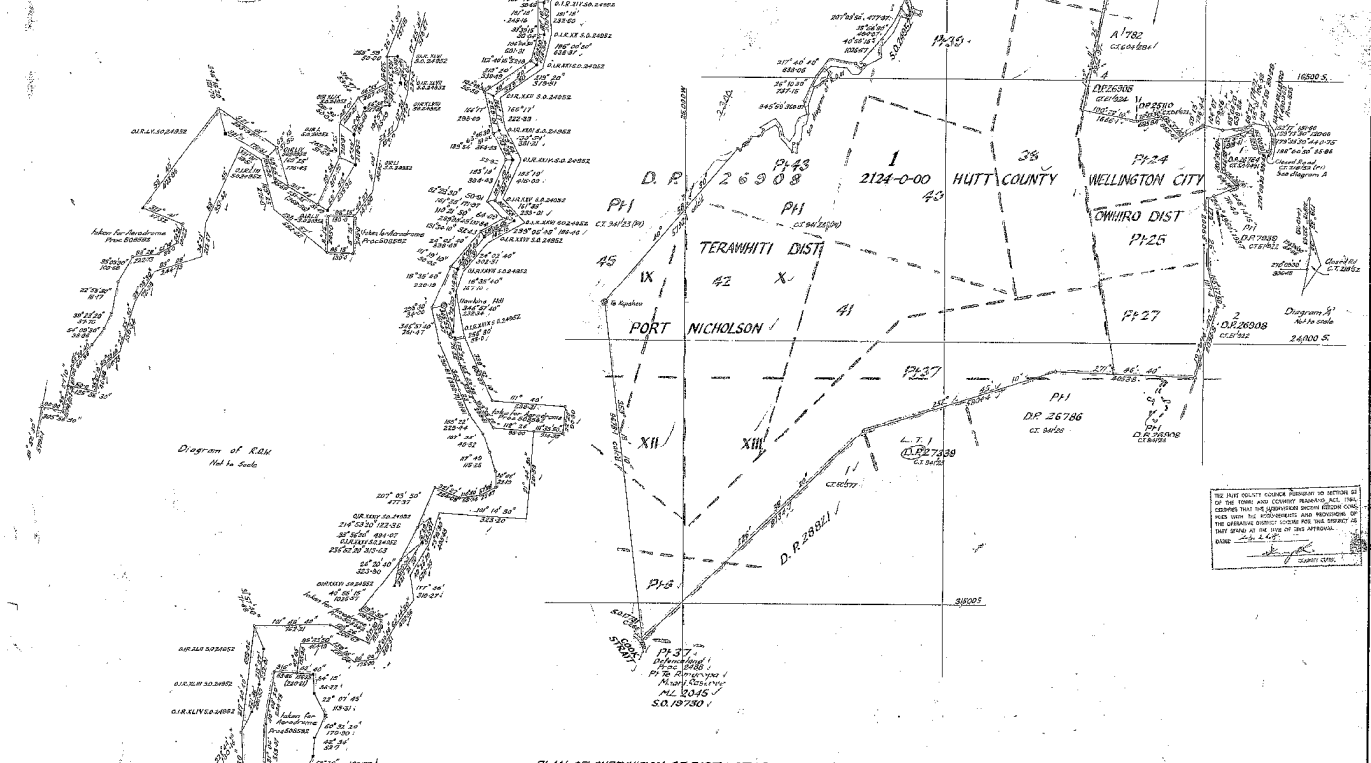

29398

PLAN OF SUBDIVISION OF PART LOT 1 D.P. 26308
 BEING PT SEC 7 UPPER KAWHARANHARA DIST, SECS 38, 40, 41, 42, 43, 44, 45, TERAWHITI DIST
 AND PT SECS 24, 25, 27, OHAIRO DIST
 COMPRISED IN CT 94123 (P1)

Approved as to Survey
 Chief Surveyor

Received
 Reference plan
 Plans
 Field book
 Traverse book
 Examined by
 Received
 Correct

SURVEY BLOCK 6 DISTRICT IX, X, XI & XII PORT NICHOLSON
 LAND DISTRICT WELLINGTON LOCAL BODY HUTT COUNTY & WELLINGTON CITY
 SCALE IS CHAINS TO AN INCH SURVEYED BY B.P. FLAYER DATE JANUARY 1968

Broad Parker Mayor of Wellington Registered Surveyor and holder of an annual practising certificate, solemnly and sincerely declare that this plan has been made from surveys executed by me; that both plan and survey are correct; and have been made in accordance with the Regulations under the Survey Act 1930. And I make this solemn declaration conscientiously believing the same to be true and by virtue of the Oaths and Declarations Act 1957.

Declared at Wellington this 27th day of February 1968
 Before me
 Deputy District Clerk

Approved
 Applicant or Registered Owner
 29398