

**LEGEND**

- Existing walls
- Proposed walls
- 90 x 90mm timber studs @ 400mm c/c.

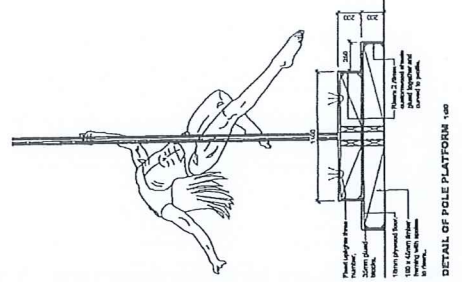
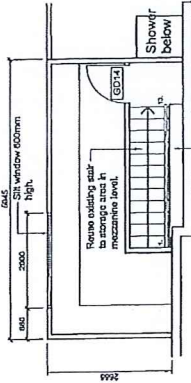

**PROPOSED GROUND FLOOR PLAN**

75 Courteney Place  
Floor Alterations

PROJECT NO. 75 Courteney Place Floor Alterations

DATE 10/10/2022

BY [Signature]

SCALE 1:100

NO. SHEET NUMBER BY DATE

**Wellington City Council**  
Received: 12/04/2023