

Ground floor

Wellington City Council Received:
13/12/2022

Wellington City Council Received:
13/12/2022

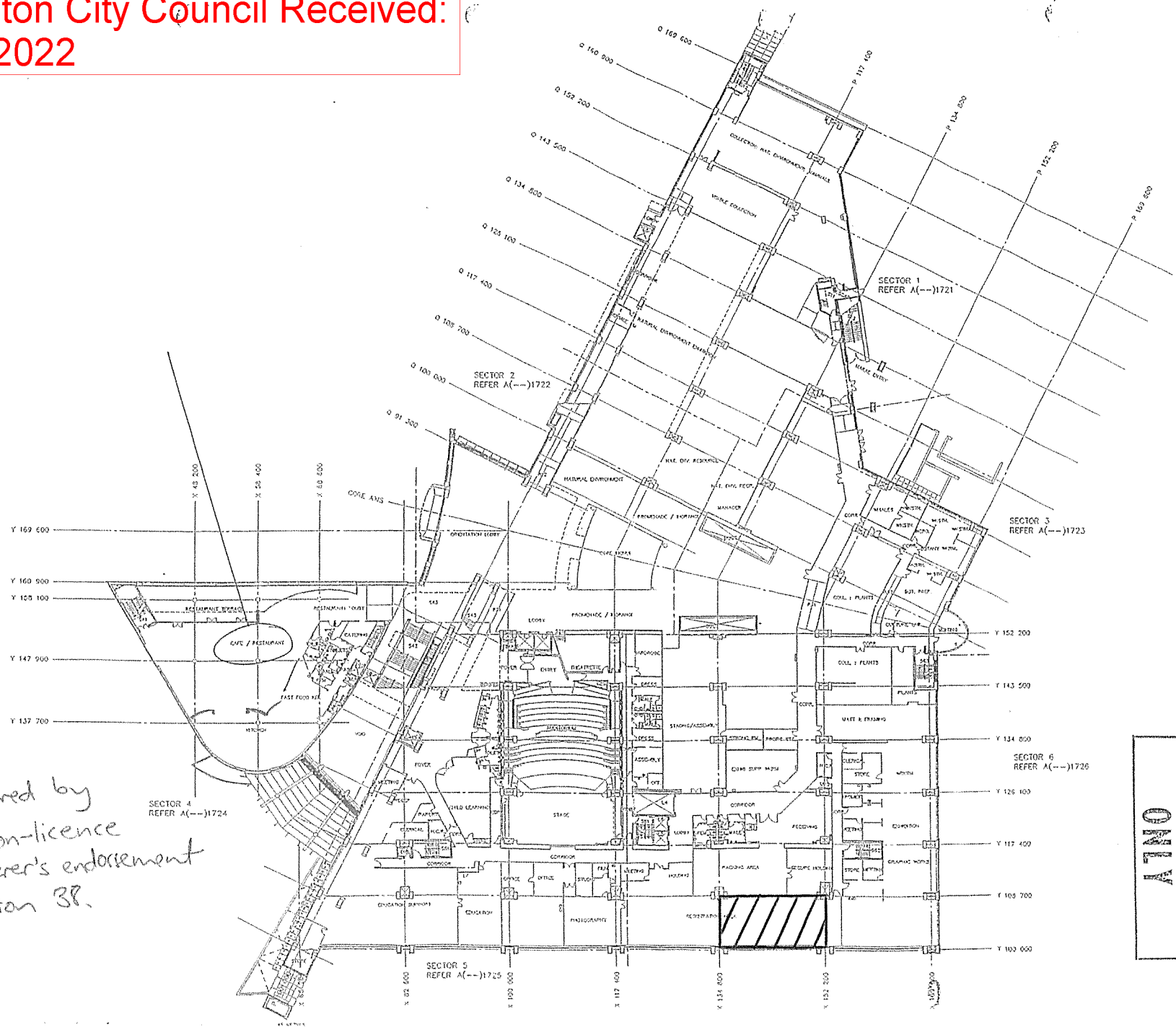

▨ = covered by separate on-licence with caterer's endorsement under section 38.

- NOTES
- FOR DYNAMIC GEOMETRY MATRIX REFER A(--)-1720
 - FOR PLAN ORIENTATION AND SECTOR REF REFER A(--)-1722
 - FOR MASTER SECTION (ORIENTATION) REFER A(--)-1723
 - FOR MASTER DRAWING (ORIENTATION) REFER A(--)-1724
 - FOR MASTER DRAWING (ORIENTATION) REFER A(--)-1725
 - FOR MASTER DRAWING (ORIENTATION) REFER A(--)-1726
 - FOR MASTER DRAWING (ORIENTATION) REFER A(--)-1727
 - FOR MASTER DRAWING (ORIENTATION) REFER A(--)-1728
 - FOR MASTER DRAWING (ORIENTATION) REFER A(--)-1729
 - FOR MASTER DRAWING (ORIENTATION) REFER A(--)-1730
 - FOR MASTER DRAWING (ORIENTATION) REFER A(--)-1731
 - FOR MASTER DRAWING (ORIENTATION) REFER A(--)-1732
 - FOR MASTER DRAWING (ORIENTATION) REFER A(--)-1733
 - FOR MASTER DRAWING (ORIENTATION) REFER A(--)-1734
 - FOR MASTER DRAWING (ORIENTATION) REFER A(--)-1735
 - FOR MASTER DRAWING (ORIENTATION) REFER A(--)-1736
 - FOR MASTER DRAWING (ORIENTATION) REFER A(--)-1737
 - FOR MASTER DRAWING (ORIENTATION) REFER A(--)-1738
 - FOR MASTER DRAWING (ORIENTATION) REFER A(--)-1739
 - FOR MASTER DRAWING (ORIENTATION) REFER A(--)-1740

Level Two

A. ORIGINAL UPDATES FOR THE EXTENSION

JASMAX ARCHITECTS
REGISTERED ARCHITECTS

LEVEL 2
3 FLOOR PLAN
FOR THE JASMAX MUSEUM
EXTENSION
PROJECT NO. JAS-2022-001
DATE: 13/12/2022

Current Site Project Management and Project Manager
William Lloyd Jones, Director
Professional and Civil Engineer
Fergus Dwyer & Young Ltd.
Structural, Geotechnical, Surveying, Soil Remediation and Technical Transportation Engineers

Geotech Report 118
Structural, Geotechnical and Building Information Engineers

Design: Douglas and Thomas Ltd.
Civil Engineers

INFORMATION FOR ONLY

TE PAPA MUSEUM OF NEW ZEALAND

FITOUT FLOOR PLAN
LEVEL 2
R.L. 8 100 / 8 800

SCALE: 1:100

DESIGNER	DATE
ENGINEER	DATE
ARCHITECT	DATE
CONTRACTOR	DATE

ARCHITECTURAL
A(--)-1722 (A)

☐ = CAFE AREA

X = PRINCIPAL ENTRANCE

SHADED AREAS NOT IN CONTRACT

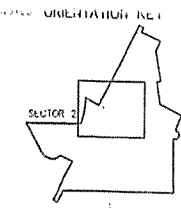
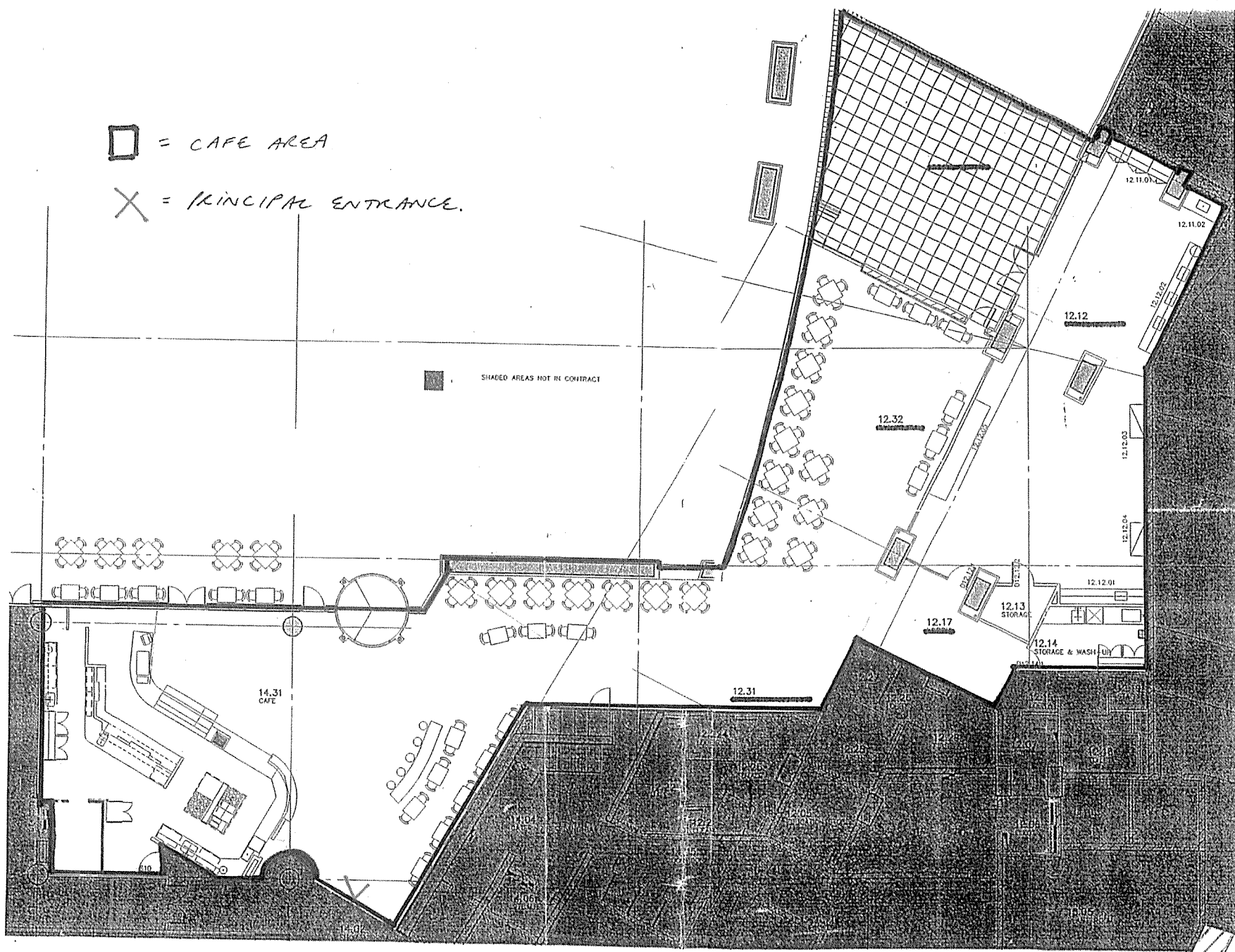

1 INFORMATION
21 AUGUST 97

REVISIONS

JASMAX

Architects
Interior Designers
65 Upper Queen Street
Box 6548 Auckland 1
Tel 64 9 366 9626
Fax 64 9 366 9629
gen@jasmax.co.nz



CONSULTANTS

Ceresia Mills Project Management Ltd.
Project Manager
Helmek Arop John Vanhore
Structural and Civil Engineers
Norman O'Leary & Young Ltd.
Electrical, Communications, Security,
Fire Protection and Vertical
Transportation Engineers
Connet Wager Ltd.
Mechanical, Hydraulics and Building
Automation Engineers
Forsell Drysdale and Thomas Ltd.
Cost Planners



SHEET

CAFE
FLOOR PLAN

LEVEL 1 SECTOR 2
SCALE 1:100

DESIGN	JASMAX
DRAWN	DC
CHECKED	
JOB	90119
DATE	JUL 97
DRAWING STATUS	ISSUE DATE
INFORMATION	21/08/97
CONSENT	
TENDER	
CONSTRUCTION	

ARCHITECTURAL

DWG NO. A(--)-2100 REVISION 1

FILE: G:\MONZ\COMM\CAFE
VIEW: UNITS ORIGIN: 0,0

DO NOT SCALE
CONTRACTOR MUST VERIFY ALL DIMENSIONS
ON SITE BEFORE COMMENCING ANY WORK
COPYRIGHT © JASMAX Limited

Plotted: 20 Oct 1997 @ 5:09pm

INFORMATION

Wellington City Council Received:
13/12/2022

□ = RESTAURANT
 X = PRINCIPAL ENTRANCE

NOTES ORIENTATION KEY

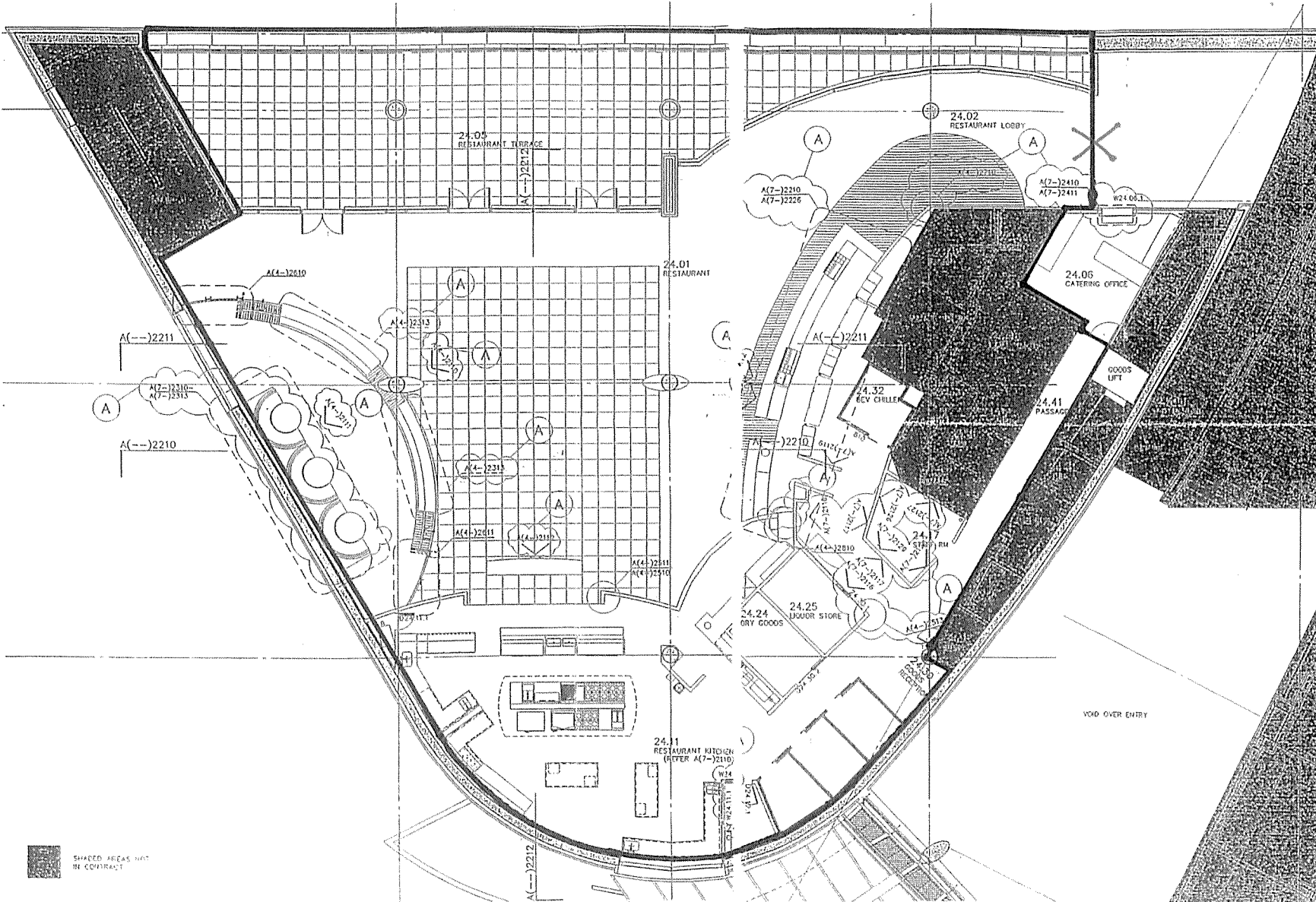
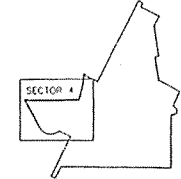

A CONSTRUCTION
 26 AUGUST 97

REVISIONS

JASMAX

Architects
 Interior Designers
 65 Upper Queen Street
 Box 6548 Auckland 1
 Tel 64 9 366 9526
 Fax 64 9 366 9529
 gen@jasmax.co.nz



CONSULTANTS

Casson Bills Project Management Ltd.
 Project Manager
 Hobson Arup John Venables
 Structural and Civil Engineers
 Norman Disney & Young Ltd.
 Electrical, Communications Security,
 Fire Protection and Vertical
 Transportation Engineers
 Conwell Wagner Ltd.
 Mechanical, Hydraulics and Building
 Automation Engineers
 Russell Coyate and Thomas Ltd.
 Cost Estimators



SHEET

RESTAURANT FITOUT
 GENERAL FLOOR PLAN

LEVEL 2 SECTOR 4
 SCALE 1:100

DESIGNER	JASMAX
CREATOR	DC
CHECKED	
DATE	JUN 97
ISSUE DATE	

DRAWING STATUS
 REGAMATEX ✓
 CONSENT ✓
 TENDER ✓
 CONSTRUCTION ✓ 24 JULY 97

ARCHITECTURAL

DWG NO A(---)2110 REVISION (A)

FILE 0 0000002/CLM/REST

NEW LINES ORIGIN 0.0
 DO NOT SCALE
 CONSTRUCTION

Wellington City Council Received:
 13/12/2022

Wellington City Council Received:
13/12/2022

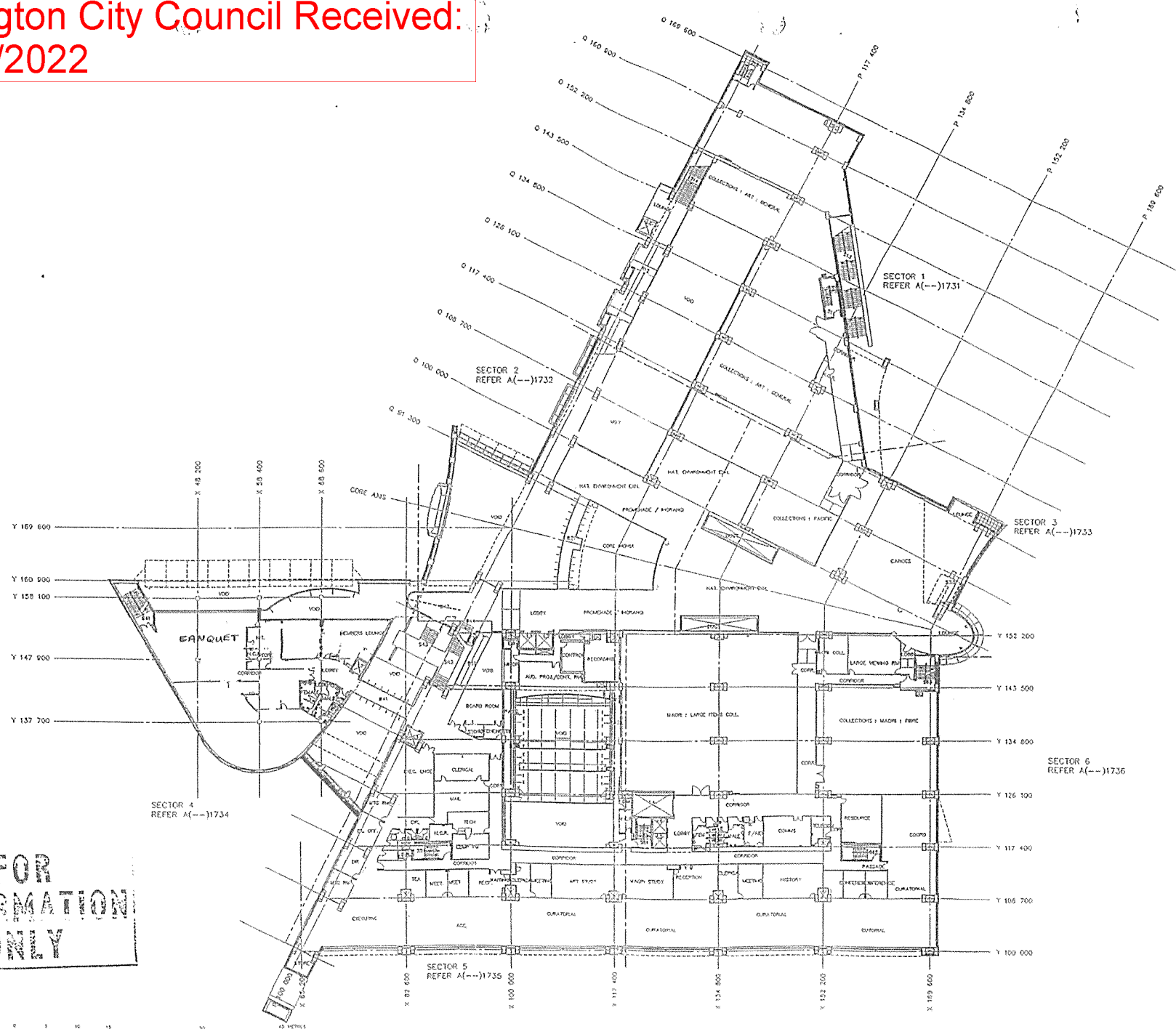

- NOTES
1. FOR DRAWING CATEGORY V&T REFER A(--)-1745
 2. FOR PLAN ORIENTATION AND SECTOR KEY REFER A(--)-1745
 3. FOR MASTER SECTION DRAWING REFER A(--)-1745
 4. FOR MASTER DRAWING APPROVAL SHEET REFER A(--)-1745
 5. FOR MASTER WORKING DRAWING SHEET REFER A(--)-1745
 6. FOR FITOUT FLOOR PLANS REFER A(--)-1739-1744
 7. FOR FITOUT MATERIAL WALLS PLAN REFER A(--)-1739-1744
 8. FOR FITOUT SUSPENDED CEILING PLAN REFER A(--)-1739-1744
 9. FOR FITOUT WALL FINISHES PLAN REFER A(--)-1739-1744
 10. FOR FITOUT WALL FINISHES SECTION REFER A(--)-1739-1744
 11. FOR FITOUT FLOOR FINISHES PLAN REFER A(--)-1739-1744
 12. FOR STAIRS AND RAMP FINISHES AND MATERIALS REFER A(--)-1739-1744
 13. FOR SIGN PANEL LOCATION PLAN REFER A(--)-1739-1744
 14. FOR FINISHES LOCATION PLAN REFER A(--)-1739-1744

A. GENERAL URBAN
AS PER
REVISIONS

JASMAX ARCHITECTS
REGISTERED ARCHITECTS

11 GLEN
8 FULTON PLACE
PO BOX 888 WELLINGTON
TELEPHONE 6-488 8888
FAX 6-488 8888

OUR OFFICE IS WELLINGTON
PO BOX 1148 WELLINGTON
TELEPHONE 6-488 8888
FAX 6-488 8888

CONTRACT NO. 1735

Current Office Project Management & Project Manager:

Richard Arroy, John Venter,
Richard and Gabe Richardson.

Karisma Elmer & Young Ltd.
Structural Consultants, Town
Plan Preparation and Technical
Transportation Engineers.

Client: Mayor E.A.
Ambulatory, Hydration and Refining
Architectural Refinement.

Specialty: Crystal and Thomas Ltd.
Civil Engineers.



PROJECT:
FITOUT FLOOR PLAN
LEVEL 3
R.L. 13 200

SCALE 1:300

DESIGN	2019
REVISED	2020
DATE	13 DEC 22

PROJECT STATUS

DESIGN	4
CONSTRUCTION	1
OPERATION	1
DECOMMISSION	1

ARCHITECTURAL

PROJECT NO. A(--)-1703

FILED: 6 NOVEMBER 2022 10:15 AM
NEW ZEALAND'S PROFESSIONAL ARCHITECTS BOARD

FOR
INFORMATION
ONLY

Wellington City Council Received:
13/12/2022

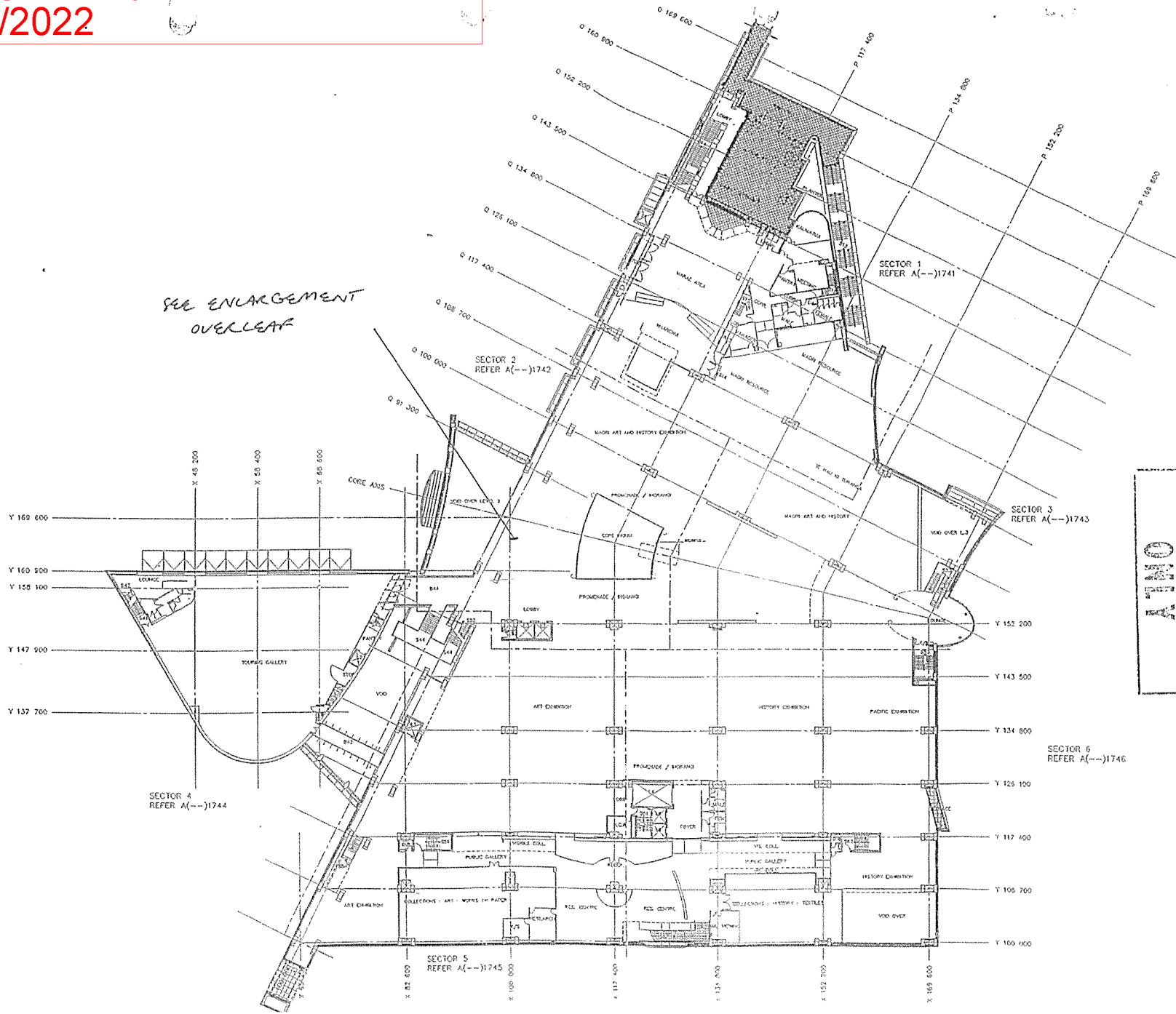

- NOTES
- FOR DRAWING CATEGORY MAPS REFER A(--)-1740
 - FOR PLAN ORIENTATION AND SECTOR KEY REFER A(--)-1740
 - FOR MASTER SECTION ORIENTATION KEY REFER A(--)-1740
 - FOR MASTER DRAWING INFORMATION SHEET REFER A(--)-1740
 - FOR MASTER BUILDING AND SITE SHEET REFER A(--)-1740
 - FOR FITOUT FLOOR PLANS REFER A(--)-1704-706
 - FOR FITOUT PERIOD WALLS PLAN REFER A(23)704-706
 - FOR FITOUT SUPPLIED COLOURS PLAN REFER A(23)704-706
 - FOR FITOUT WALL FINISHES (EXAMINE NOTE A(23)704-706)
 - FOR FITOUT WALL FINISHES (EXAMINE NOTE A(23)704-706)
 - FOR FITOUT FLOOR FINISHES PLAN REFER A(43)704-706
 - FOR STAIRS RAMP FINISHES AND FINISHES 3 LOCK FOR STAIRS REFER A(43)704-706
 - FOR EXIST PAINT LOCATION PLAN REFER A(43)704-706
 - FOR FITOUT LOCATION PLANS REFER A(17)-1704-706

A. GENERAL UPDATES
AS PER 14

JASMAX ARCHITECTS
REGISTERED ARCHITECTS

11 LEVEL 4
4 VICTORIA PLACE
100 RUSSELL SQUARE
TELEPHONE 0-800 848 848
FACSIMILE 0-800 848 848

NEW ZEALAND
CORPORATE & BANKING SERVICES
PO BOX 1444 WELLINGTON 1
TELEPHONE 0-800 848 848
FACSIMILE 0-800 848 848

CONTRACTORS

Greenfield Project Management Ltd
Project Manager

Shelton Group Ltd
Structural and Civil Engineers

McGee & Young Ltd
Electrical, Communications, Security,
Data Protection and Network
Telecommunications Engineers

Connell Wray Ltd
Mechanical, Electrical and Building
Automation Engineers

Samuel Irons and Thomas Ltd
Civil Engineers



TE MANATŪ TAONGA
MUSEUM OF NEW ZEALAND

FITOUT FLOOR PLAN
LEVEL 4
R.L. 17 600

SCALE 1:500

DATE: 18 FEB 11

DESIGNED BY: [Signature]

CHECKED BY: [Signature]

DATE: 18 FEB 11

APPROVED BY: [Signature]

DATE: 18 FEB 11

ARCHITECTURAL

DWG NO: A(--)-1704

PROJECT: [Signature]

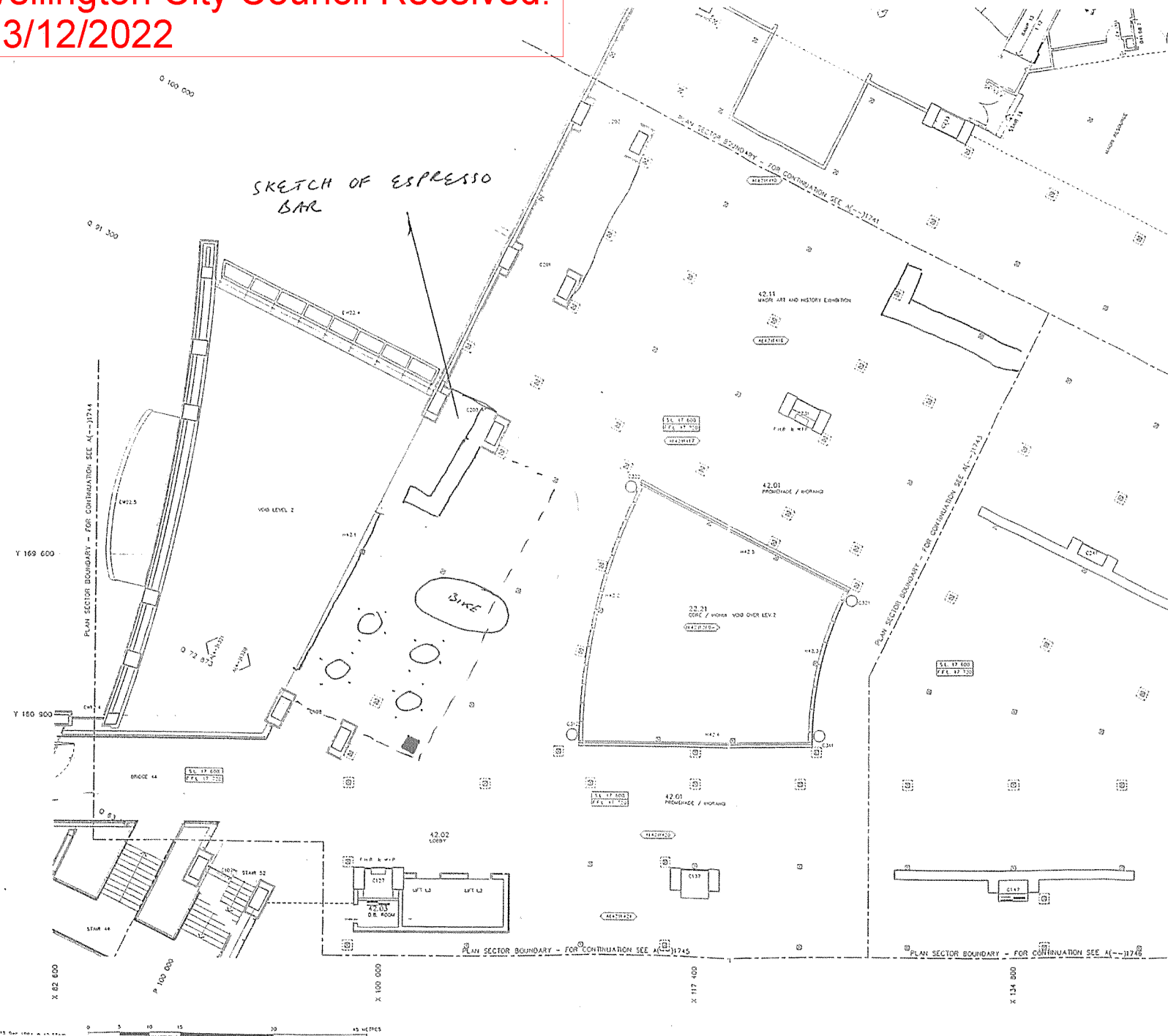

- LEGEND**
IN ACC. 4
CHURCH: C
STANDARD
- 35.43 STATE NUMBER
 - 35.44 LEVEL SECTION SURFACE HIS
 - MANAGER
 - SPACE NAME
 - W.C.R. NORMAL COMMUNICATIONS ROOM
 - U INTERNAL DOOR NUMBER
 - U-SPACE NUMBER/DOOR 11
 - U INTERNAL DOOR E.CPS 3
 - REFER TO BASE BUILDING
 - FLOOR PLANS A(-)-11709 & ELEVATIONS A(-)-11709
 - U-112 INTERNAL WINDOW NUMBER
 - U-SPACE NUMBER/FUNCTION 11
 - U-112 INTERNAL LOUVER NUMBER
 - U-SPACE NUMBER/DOOR 21
 - GLAZING ABOVE 2.00 TO 4.00
 - OF FINISH FLOOR LEVEL
 - FLOORWORK WALLS (E.CPS 3)
 - REFER TO BASE BUILDING
 - FLOOR PLANS A(-)-11709 & ELEVATIONS A(-)-11709
 - C127 COLUMN NUMBER
 - REFER A(-)-11709
 - C127 COLUMN DUCT PANEL
 - FOR LOCATION PLAN
 - REFER A(-)-11709
 - PIPE HOSE REEL
 - ALL PIPES HAVE CON. EXTENSION
 - IN ROOM
 - FIRE MARK WARDEN INSPECTION
 - POINT
 - CONSTRUCTION BOARD
 - REFER A(-)-11709-1100
 - 800 MM CLEARANCE REQUIRED
 - WIDEST OF ALL CB
 - M.S.R. MECHANICAL SERVICES SWITCHBOARD
 - REFER A(-)-11709-1100 AND A(-)-11709



- GENERAL NOTES**
- 1 FOR GRADING CATEGORY WATER
 - REFER A(-)-11703
 - 2 FOR PLAN DIMENSIONS AND
 - SECTION REFER A(-)-11702
 - 3 FOR MASTER SECTION DIMENSIONS
 - REFER A(-)-11702
 - 4 FOR MASTER GRADING DIMENSIONS
 - SHEET REFER A(-)-11702
 - 5 FOR MASTER WALLS AND
 - SECTION REFER A(-)-11701
 - 6 FOR FINISH FLOOR PLANS
 - REFER A(-)-11704-1105
 - 7 FOR FINISH INTERNAL WALLS
 - PLAN REFER A(-)-11704-1105
 - 8 FOR FINISH SURFACE FINISHES
 - PLAN REFER A(-)-11704-1105
 - 9 FOR FINISH WALL FINISHES
 - PLAN REFER A(-)-11704-1105
 - 10 FOR FINISH WALL FINISHES
 - ELEVATIONS REFER A(-)-11704-1105
 - 11 FOR FINISH FLOOR FINISHES
 - PLAN REFER A(-)-11704-1105
 - 12 FOR STAIRS RAILS BRIDES AND
 - HANDRAILS LOCATION SCHEDULE
 - REFER A(-)-11704-1105
 - 13 FOR FINISH PANEL SCHEDULE
 - PLAN REFER A(-)-11704-1105
 - 14 FOR SFT CAR FINISH DRAWINGS
 - REFER A(-)-11704-1105
 - 15 FOR FINISH LOCATION PLANS
 - REFER A(-)-11704-1105

- COMPRESSION OF LEVELS:**
- LEVELS SHOWN ARE IN TERMS OF MESENGTON
CITY NEW ZEALAND
(MEAN SEA LEVEL = 0 000)
- S.L. 3.000 SURFACE LEVEL
 - F.L. 3.000 FINISHED FLOOR LEVEL
 - S.P.L. 3.000 SPOT LEVEL
 - FINISH 1.32 FINISH = 1.32
 - REFER RAIN SCHEDULE A(-)-11702
 - F.L. FINISHED FLOOR LEVEL
 - FOR AREAS WITH CURBS, WALLS, FREE
 - STANDING WATER, FIVE PERCENT TO
 - SURFACE LEVEL, AND RAFT FLOOR
 - FINISHED FLOOR LEVEL = SURFACE LEVEL
 - F.C.L. FINISHED CEILING LEVEL
 - F.G.L. FINISHED GROUND LEVEL
 - S.L. SURFACE LEVEL
 - FOR CONCRETE WORK, SL, INCLUDES
 - ALL CONCRETE FORMING SLABS AND
 - LEVELING SCHEDULES
 - R.L. REFERENCE LEVEL

FOR CONSTRUCTION
18 MAY 1995

JASMAX ARCHITECTS
REGISTERED ARCHITECTS

LEVEL 1
2 PRINCE STREET
PO BOX 1041 WELLINGTON
TELEPHONE 04-489 0000
FACSIMILE 04-489 0000

BUS COURSE
ONE ONE A MARCHED STREET
PO BOX 1041 WELLINGTON
TELEPHONE 04-489 0011
FACSIMILE 04-489 0011

CONSULTANTS

Carroll Hill Property Management Ltd.
Project Manager

Balmer Group Trustee
Structural and Civil Engineers

Berman Design & Young Ltd.
Electrical, Communications, Security,
Fire Protection and Transport
Transportation Engineers

Ground Report Ltd.
Mechanical, Electrical and Plumbing
Installation Engineers

Brown, Dwyer and Thomas Ltd.
Cost Planners



FITOUT FLOOR PLAN
LEVEL 4
PLAN SECTOR 2
R.L. 17 800
SCHIE 1:100

DESIGN A
DRAWN M.J.T.
CHECKED J.P.
JOB 11744
DATE 10 DEC 94

DRAWING STATUS

- INFORMATION 4 15 MAR 95
- CONSTRUCTION 4 05 DEC 94
- CONSTRUCTION

ARCHITECTURAL

DWG NO
A(-)-11742

FILE G:\MUSEUM\CONSTR\11742.DWG
NEW LEV 4R SPACE DWG 00

Wellington City Council Received:
13/12/2022

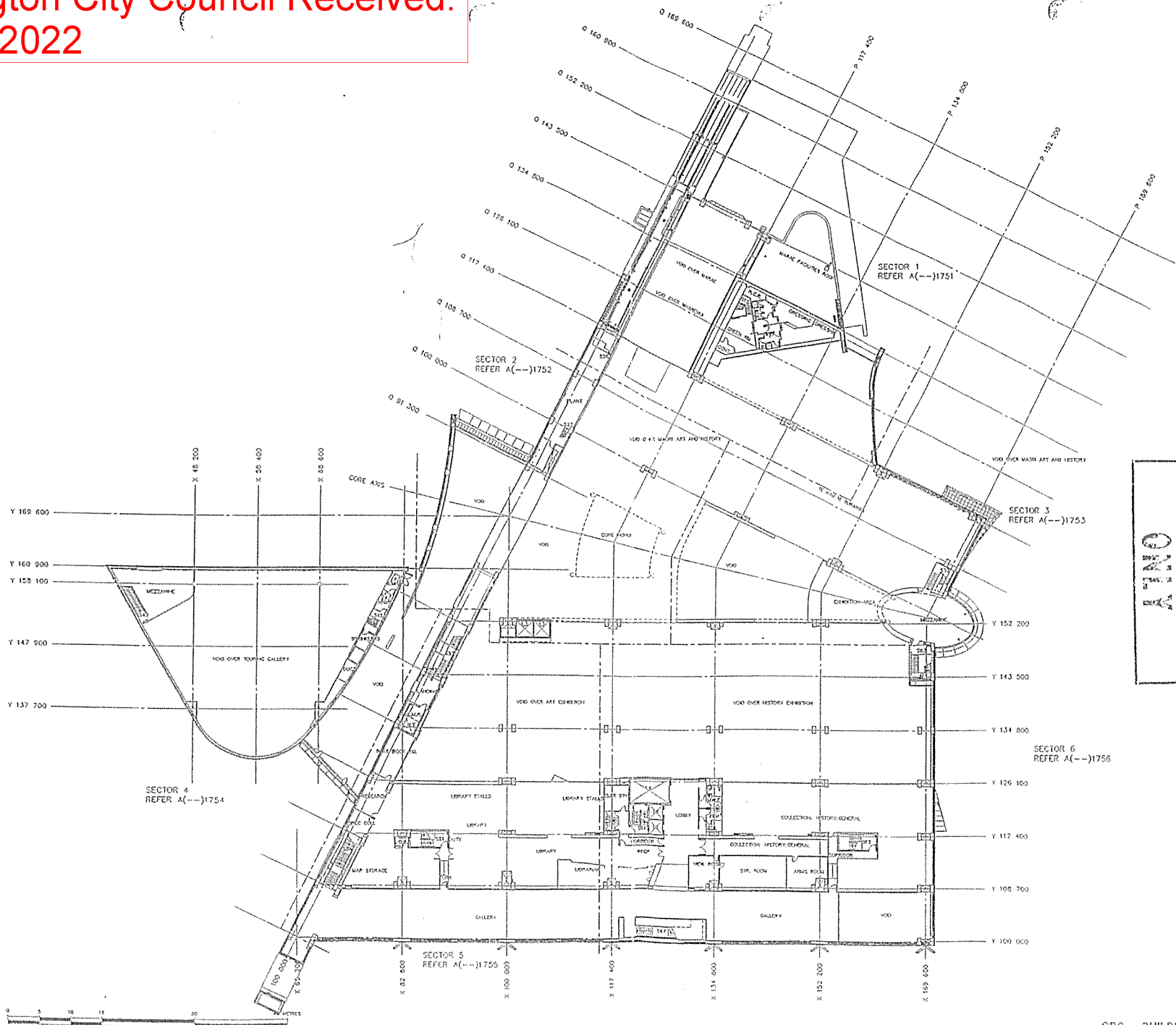

- NOTES
- FOR DRAWING CATEGORY MATRIX REFER A(--)-1185
 - FOR PLAN ORIENTATION AND SECTOR REF. REFER A(--)-1182
 - FOR MASTER SECTION ORIENTATION KEY REFER A(--)-1183
 - FOR MASTER DRAWING INFORMATION SHEET REFER A(--)-1183
 - FOR MASTER BUREAU AND SECTOR SHEET REFER A(--)-1183
 - FOR FITOUT FLOOR PLANS REFER A(--)-1180-1184
 - FOR FITOUT MESHING WALLS PLAN REFER A(--)-1181-1184
 - FOR FITOUT SUSPENDED CEILING PLAN REFER A(--)-1181-1184
 - FOR FITOUT WALL FINISHES ELEVATION REFER A(--)-1181-1184
 - FOR FITOUT FLOOR FINISHES PLAN REFER A(--)-1181-1184
 - FOR STAIRS FINISHES AND MATERIALS ELEVATION, MESHING REFER A(--)-1181-1184
 - FOR FITOUT PANEL LOCATION PLAN REFER A(--)-1181-1184
 - FOR FITOUT LOCATION PLANS REFER A(--)-1181-1184

FOR INFORMATION ONLY



JASMAX ARCHITECTS
REGISTERED ARCHITECTS

LEVEL 1
& FITOUT FLOOR
PLANS AND SECTION 1
TOLERANCE AS PER NZS
PRACTICE STANDARD 4214
RPA CREATION
OFF-CUTS & MATERIALS
AS PER SECTION 1
TOLERANCE AS PER NZS
PRACTICE STANDARD 4214

DISCLAIMER
Jasmax Architects is not responsible for the design or construction of any building or structure shown on this drawing.

GENERAL NOTES
1. All work to be in accordance with the latest edition of the New Zealand Building Code.
2. All work to be in accordance with the latest edition of the New Zealand Building Code.
3. All work to be in accordance with the latest edition of the New Zealand Building Code.



TE PAPA TONGAREWA
MUSEUM OF NEW ZEALAND

FITOUT FLOOR PLAN
LEVEL 5
R.L. 22 000

SCALE: 1:500

DESIGN: [Signature]
CHECKED: [Signature]
DATE: 18 OCT 14

ARCHITECTURAL
SHEET NO. A(--)-1705

NEW ZEALAND BUILDING CODE
NEW ZEALAND BUILDING CODE
NEW ZEALAND BUILDING CODE

Wellington City Council Received:
13/12/2022

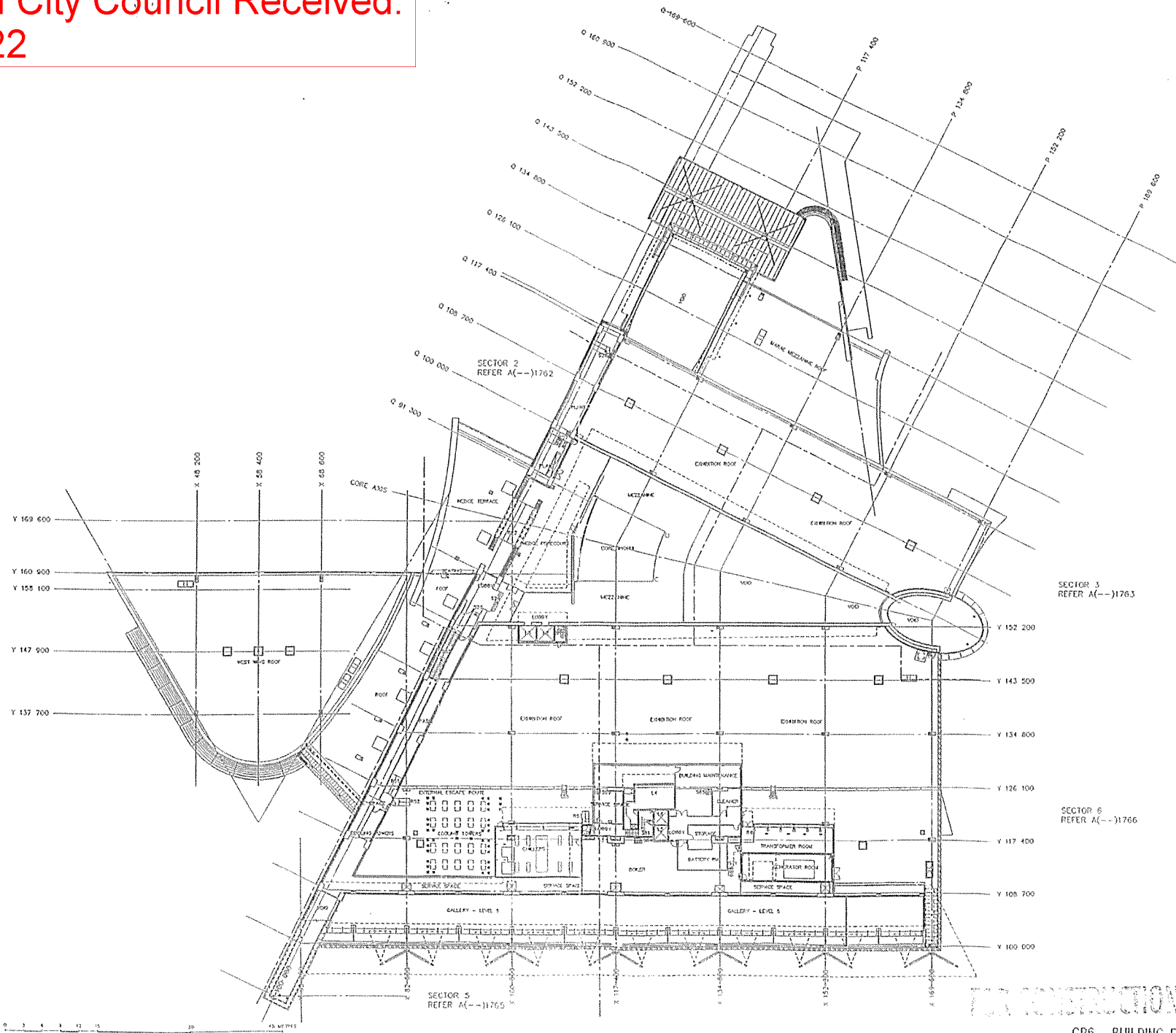

- NOTES**
1. FOR DRAWING CATEGORY MARKED REFER AC-3945
 2. FOR PLAN ORIENTATION AND SECTION KEY REFER AC-3942
 3. FOR MASTER SECTION ORIENTATION REFER AC-3943
 4. FOR MASTER DRAWING INFORMATION SHEET REFER AC-3940
 5. FOR MASTER BUILDING OVERLAP SHEET REFER AC-3941
 6. FOR FITOUT FLOOR PLANS REFER AC-3939-3941
 7. FOR FITOUT MATERIAL WALLS PLAN REFER AC3939-3941
 8. FOR FITOUT SUSPENDED CEILING PLAN REFER AC3939-3941
 9. FOR FITOUT WALL FINISHES PLAN REFER AC-3939-3941
 10. FOR FITOUT WALL FINISHES ELEVATIONS REFER AC3939-3941
 11. FOR FITOUT FLOOR FINISHES PLAN REFER AC3939-3941
 12. FOR FITOUT FLOOR FINISHES AND MATERIALS LOCATION SCHEDULE REFER AC3939-3941
 13. FOR SCALE FLOOR ORIENTATION PLAN REFER AC3-3939
 14. FOR FITOUT LOCATION PLANS REFER AC3-3939-3941

A GENERAL UPDATE AS PER THE KEYWORD



JASMAX ARCHITECTS
REGISTERED ARCHITECTS

LEVEL 6
 A REGISTERED PLAN FOR THE MAIN BUILDING & SECTION 6 AS PER DRAWING NUMBER A-1766-001
 NOT VALID FOR OTHER A REGISTERED PROJECT FOR THE MAIN BUILDING & SECTION 6 AS PER DRAWING NUMBER A-1766-001

- CONSULTANTS**
- Coram Ltd Project Management Ltd Project Manager
 - Robson Arup Ltd Architects, Structural and Civil Engineers
 - Merran Power & Tresty Ltd Electrical, Communications, Security, Fire Protection and Vertical Transportation Systems
 - Control Systems Ltd Mechanical, Electrical and Building Automation Engineers
 - Brownliff Architects and Thomas Ltd Civil Engineers



PROJECT
FITOUT FLOOR PLAN
LEVEL 6
R.L. 26 400

SCALE 1:300

REVISION	DATE	BY	CHKD

DRAWING STATUS: DATE: 18/01/21
 APPROVED: DATE: 18/01/21
 CHECKED: DATE: 18/01/21
 CONSTRUCTION: DATE: 18/01/21

ARCHITECTURAL
 ENG NO: A(--)-1766 (A)

FREE OF CHARGE TO THE CLIENT FOR THE FIRST SET OF DRAWINGS. ANY ADDITIONAL SETS WILL BE CHARGED AT THE RATE OF \$100 PER SET.
 CONTRACTOR TO VERIFY ALL DIMENSIONS ON SITE AND REPORT ANY DISCREPANCIES TO THE ARCHITECT IMMEDIATELY.

FOR CONSTRUCTION

CP6 - BUILDING FITOUT

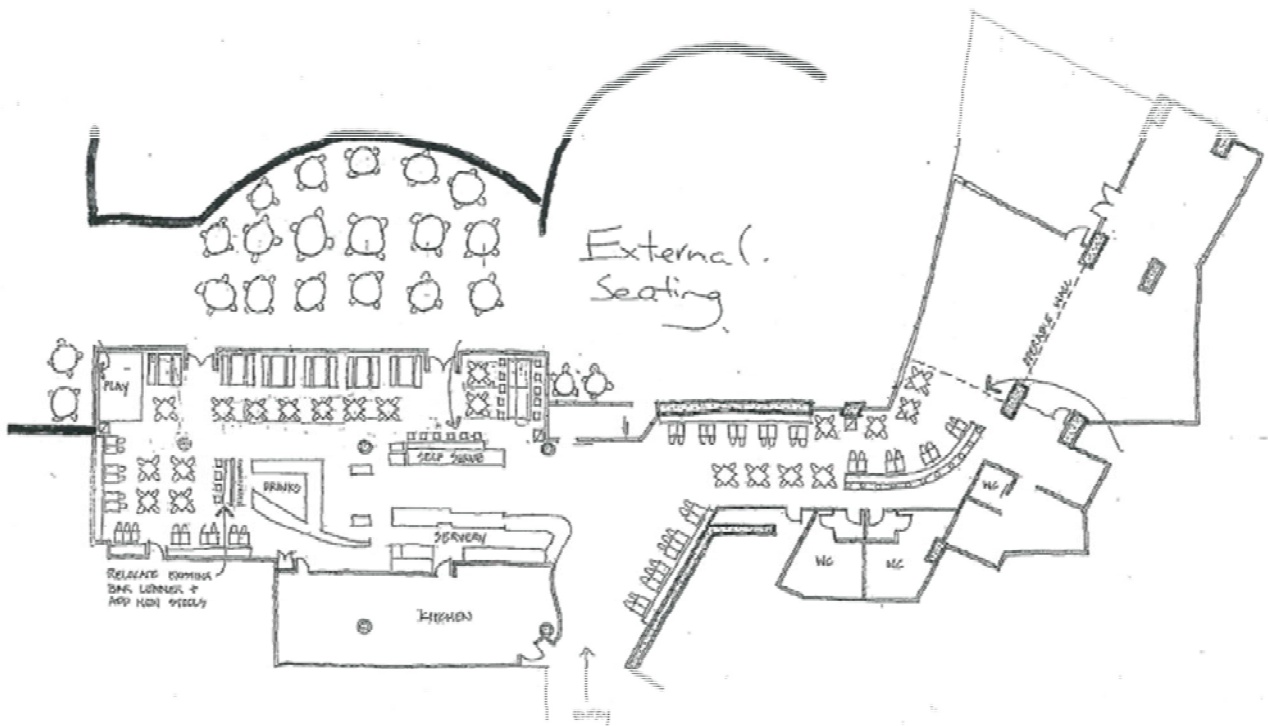

TE PAPA CAFE
FURNITURE PLAN

scale 1:200 @ A3 27th April 2007 207524

Wellington City Council Received:
13/12/2022