

Licensed Area Highlighted in Blue

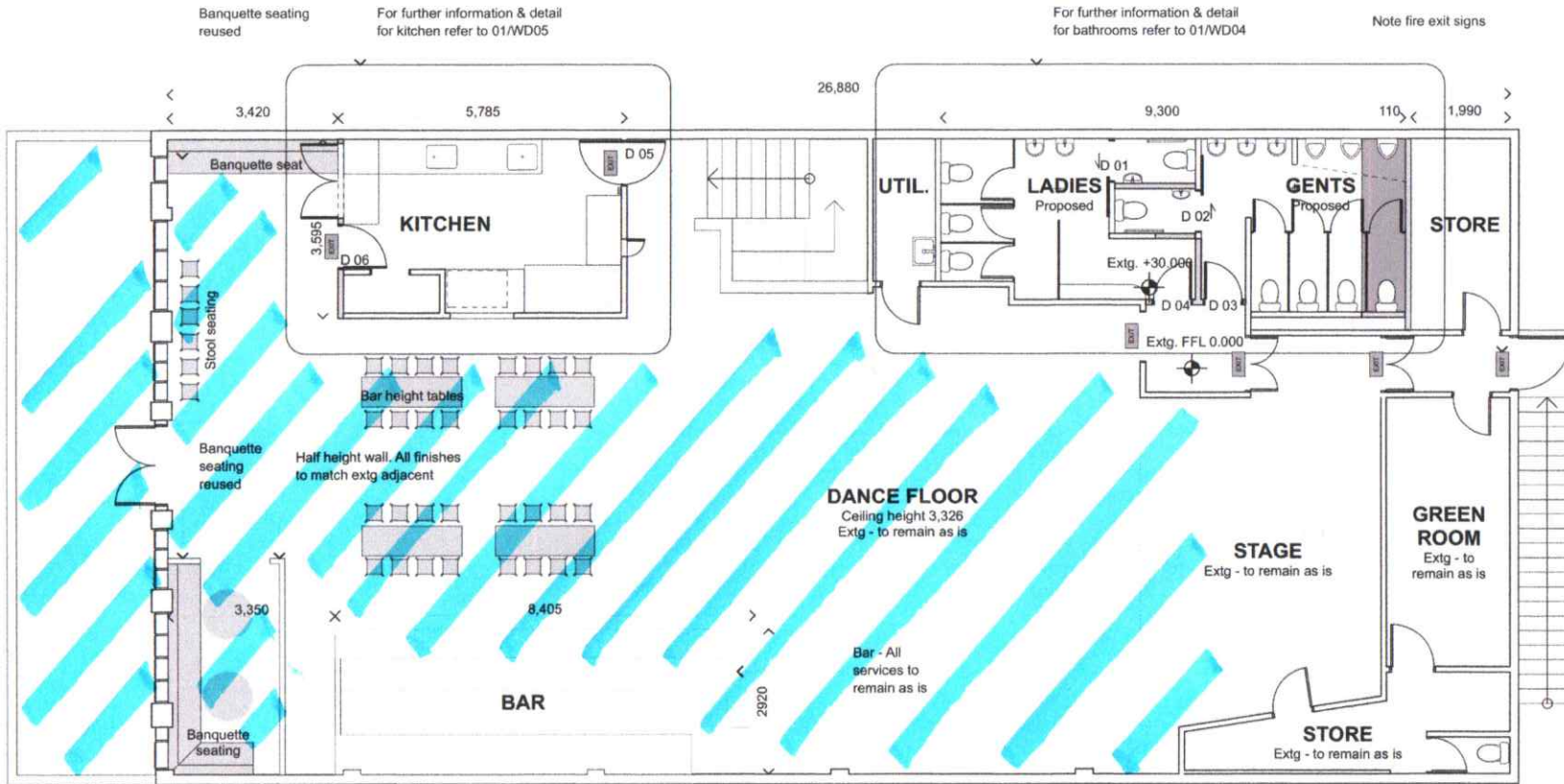

01 SFBH PROPOSED BAR LAYOUT
Scale 1:100 @ A3 original

NOTE:
Refer to fire report by Holmes Fire for all information for compliance with F1-4 of NZBC.

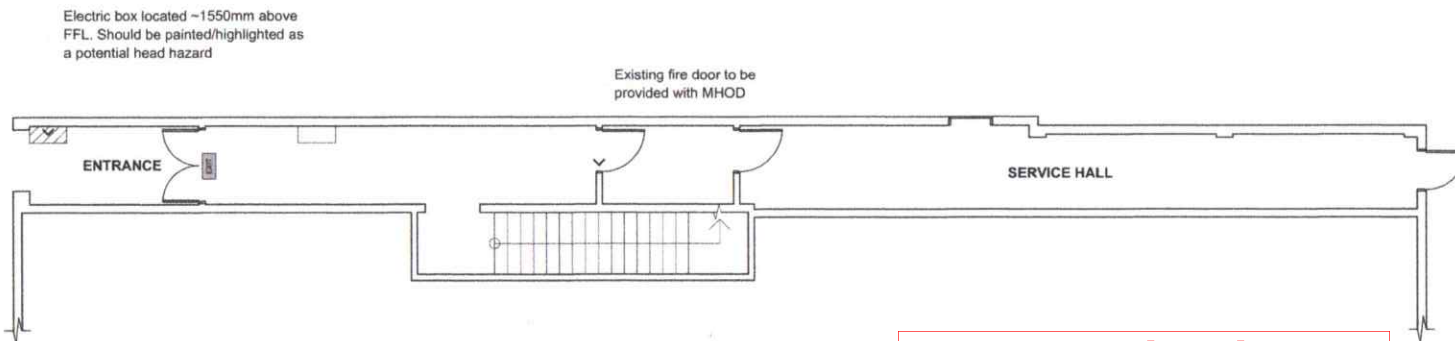

02 SFBH PROPOSED GROUND FLOOR
Scale 1:100 @ A3 original

**Wellington City Council
received: 7/05/2023**

GENERAL NOTES:

All dimensions to be verified by contractor on site before production of shop drawings or commencing fabrication or construction of contract works.

ONLY drawings marked BUILDING CONSENT are to be used for construction of contract works.

All work to be carried out in accordance with and compliant to the New Zealand Building Code 2004 and all standards as specified.

CONSULTANTS:

FIRE STRATEGY:
Holmes Fire
Paul O'Hare:
Phone: 471 1450
Email: wellington@holmesfire.com
Address: Level 2, Tower Center, 50 Customhouse Quay, Wellington

VENTILATION:
Ventilation strategy developed in conjunction with Ductari Ltd.
Andy Miers:
Phone: 021 382 827
Email: ductari.ltd@paradise.net.nz
Address: 180 Melbourne Road, Island Bay, Wellington

FOUNDATION
architecture+interiors studio
P O Box 4080 Marion Square Wellington 6147
8 Marion Street Wellington NEW ZEALAND
P 0964 04 384 8249 F 0064 04 384 8248

project

**SFBH TOILET BLOCK
ALTERATIONS, Cuba St,
Wellington**

client
San Fran Ltd

2	Issued for final coordination	13/05/14
1	Client & consultant. Issued for review.	11/03/14
REV.	DESCRIPTION.	DATE.

Proposed Plans

scale: varies original size: @a3
drawn: SR checked:

drawing no. job no. **14-233**

WD 03 rev. **2**

Copyright of this drawing remains vested with **FOUNDATION Architecture Ltd**