

Note: whole of the area to be Restricted (R18)

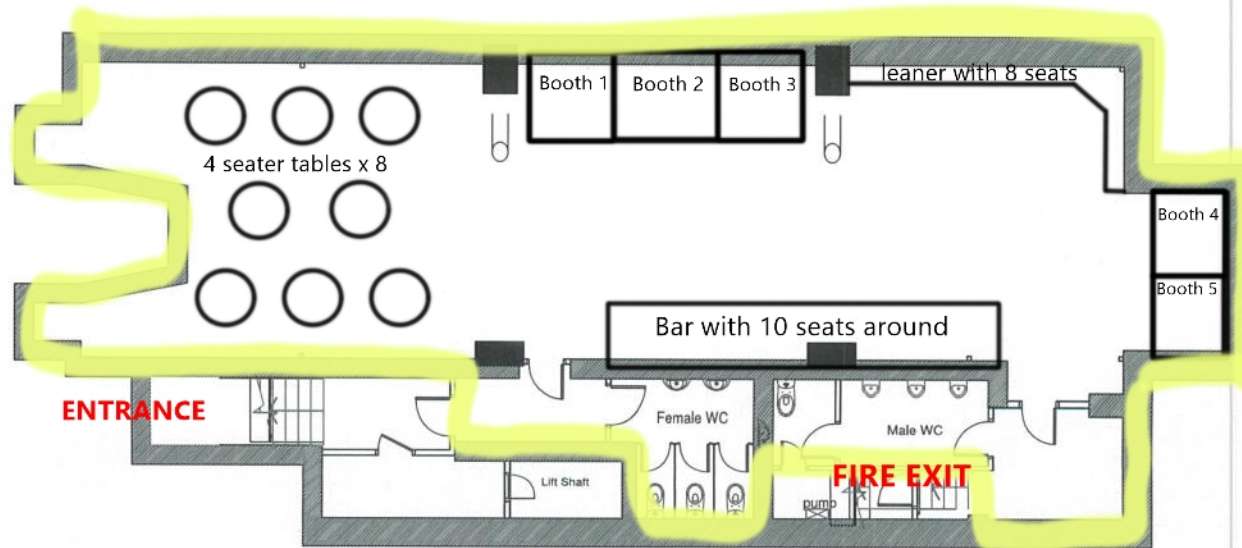

1:100 @ A3 20 Proposed Basement Plan

GOODWIN BUILDING SEISMIC UPGRADE

Project
 Location 126 Cuba Street, Te Aro, Wellington
 Client 126 Cuba Street Body Corporate

Rev.	Date	Description
1	11/08/2021	ISSUED FOR CONSTRUCTION
2	06/11/2021	ISSUED FOR ELECTRICAL CONSTRUCTION
3	18/02/2022	ISSUED FOR SEISMIC ENGINEER



www.revearchitecture.co.nz
 T. 021 900 982
 e. enquiries@revearchitecture.co.nz
 P.O. Box 2741, Wellington 6141, NZ

Issued for:
CONSTRUCTION

Sheet Title
PROPOSED BASEMENT FLOOR PLAN CLEAN

Sheet No. **A-1.25** Rev No. **C**

Job No. 1510
 Scale 1:50 @ A1; 1:100 @ A3

NOTES
 1. See all other drawings. Use figured dimensions only.
 2. Contributor to verify all dimensions on site before commencing work.
 3. Contributor to report any discrepancy for interpretation to the Architect prior to affected work proceeding.
 A. © COPYRIGHT ON THIS DRAWING IS RESERVED.



Wellington City Council received: 05/12/2022