

02132019

WELLINGTON CITY COUNCIL  
PUBLIC HEALTH  
4 FEB 2019  
RECEIVED  
WAKEFIELD ST., WELLINGTON

Plan 1  
Wellington City Council  
21 December 2021

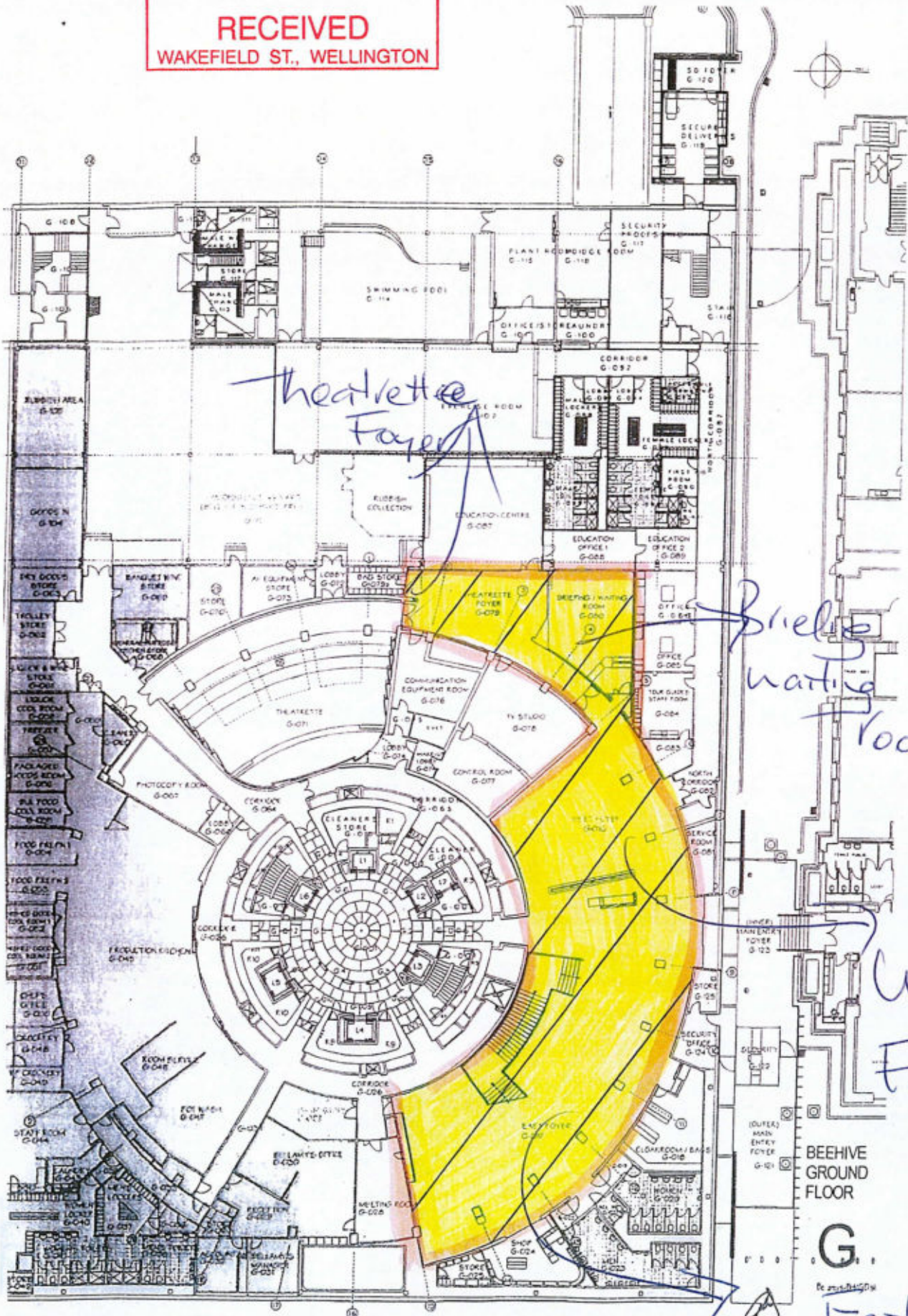

*Treatette Foyer*

*Shelter waiting room*

*West Foyer*

*East Foyer*



02132019

WELLINGTON CITY COUNCIL  
PUBLIC HEALTH  
4 FEB 2019  
RECEIVED  
WAKEFIELD ST., WELLINGTON

Plan 2

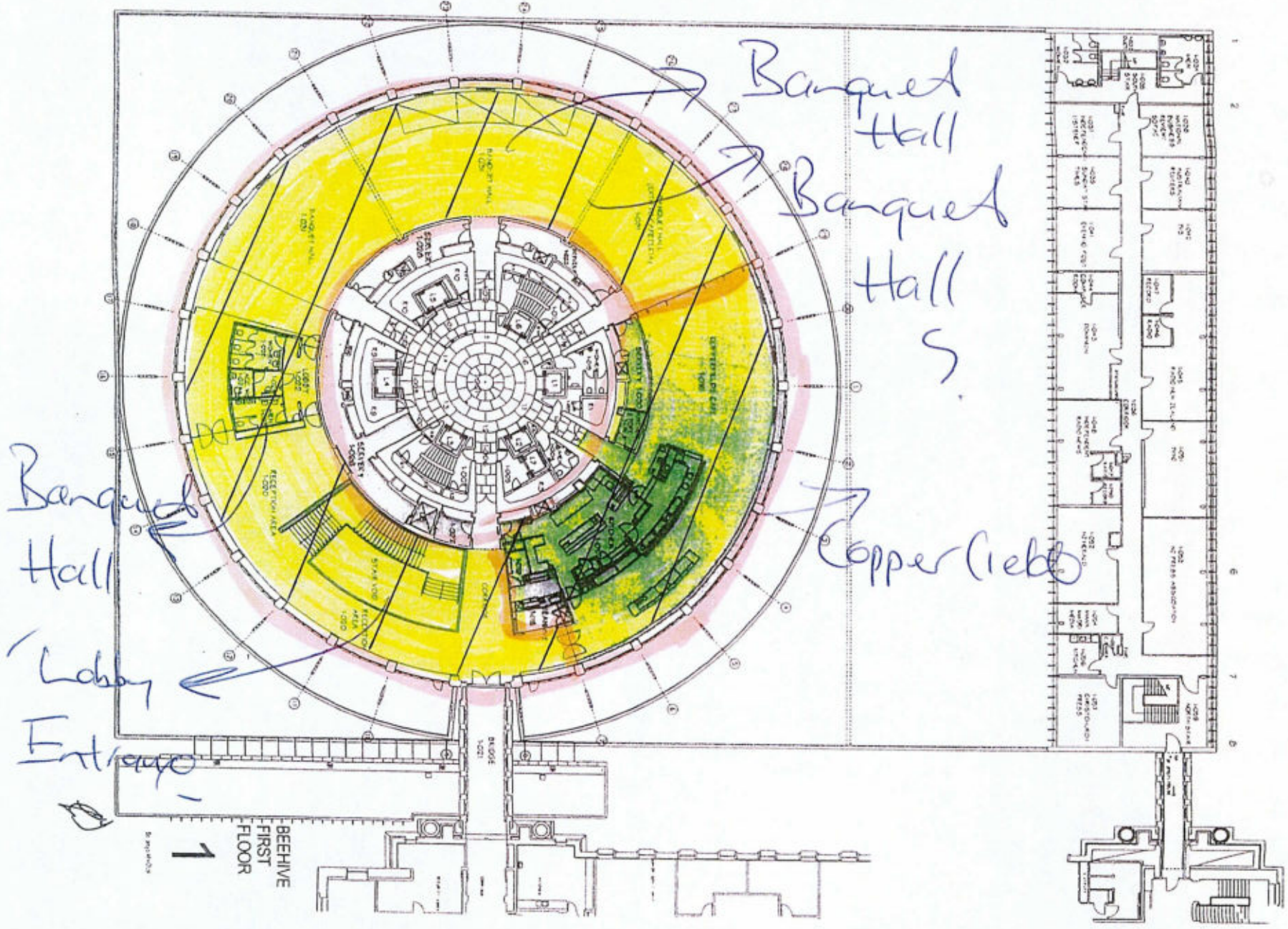



02132019

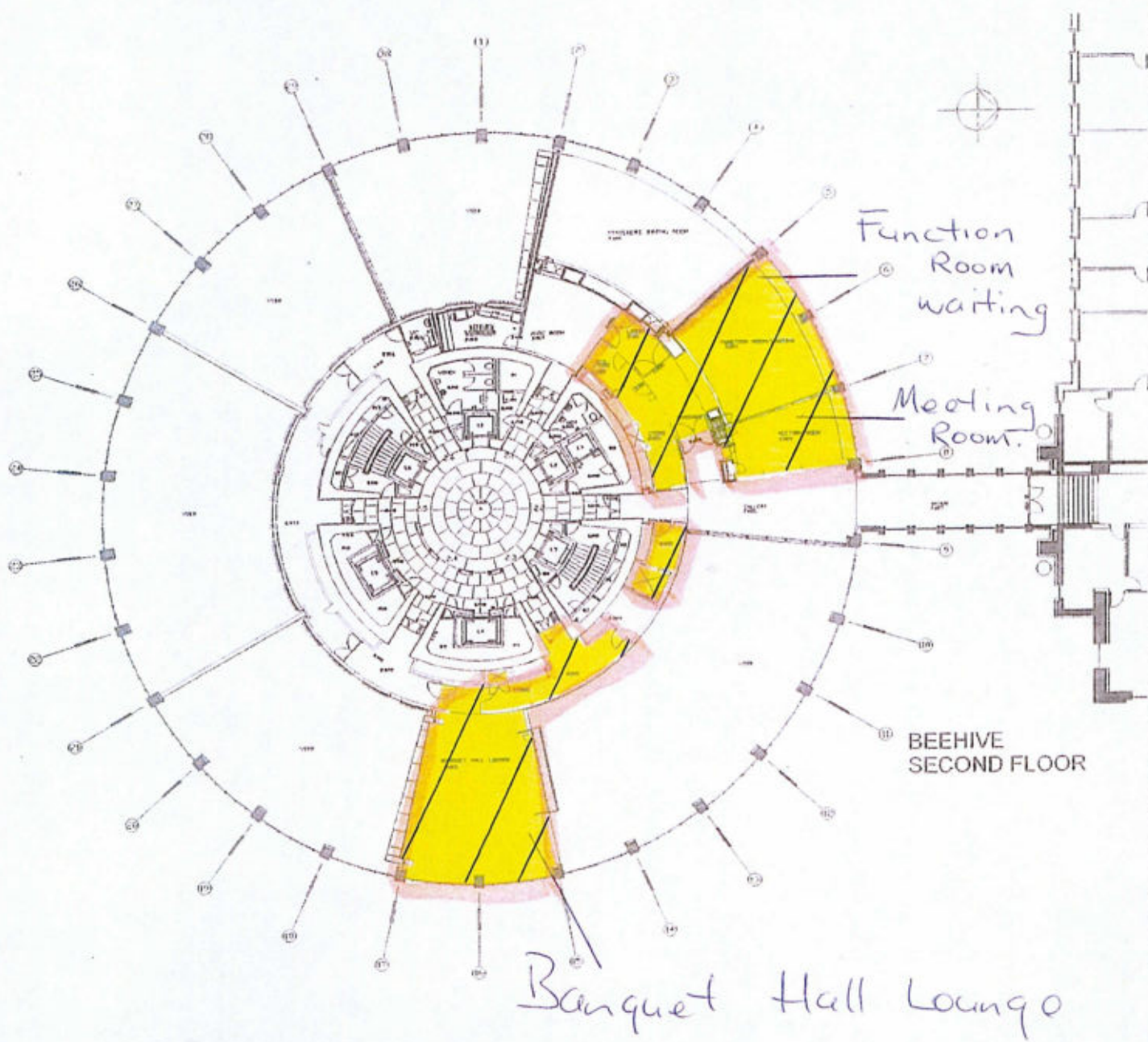

<p>General Note: All dimensions to be verified on site before producing shop drawings or commencing any work</p> <p>Revised:</p>	
<p>Consultant:</p>	
<p> <b>Building Projects Branch Parliamentary Service</b> Parliament House Private Bag 1804 Wellington 6160 New Zealand</p>	
Job No:	Bellamys Floor Plan
Sheet No:	Executive Wing - Level 2
Drawn by:	John Selby
Date:	September 2014
Scale:	Not to Scale
Job No:	
Drawings No:	EW2-01
Revision:	

WELLINGTON CITY COUNCIL  
PUBLIC HEALTH  
4 FEB 2019  
**RECEIVED**  
WAKEFIELD ST. WELLINGTON

Plan 3



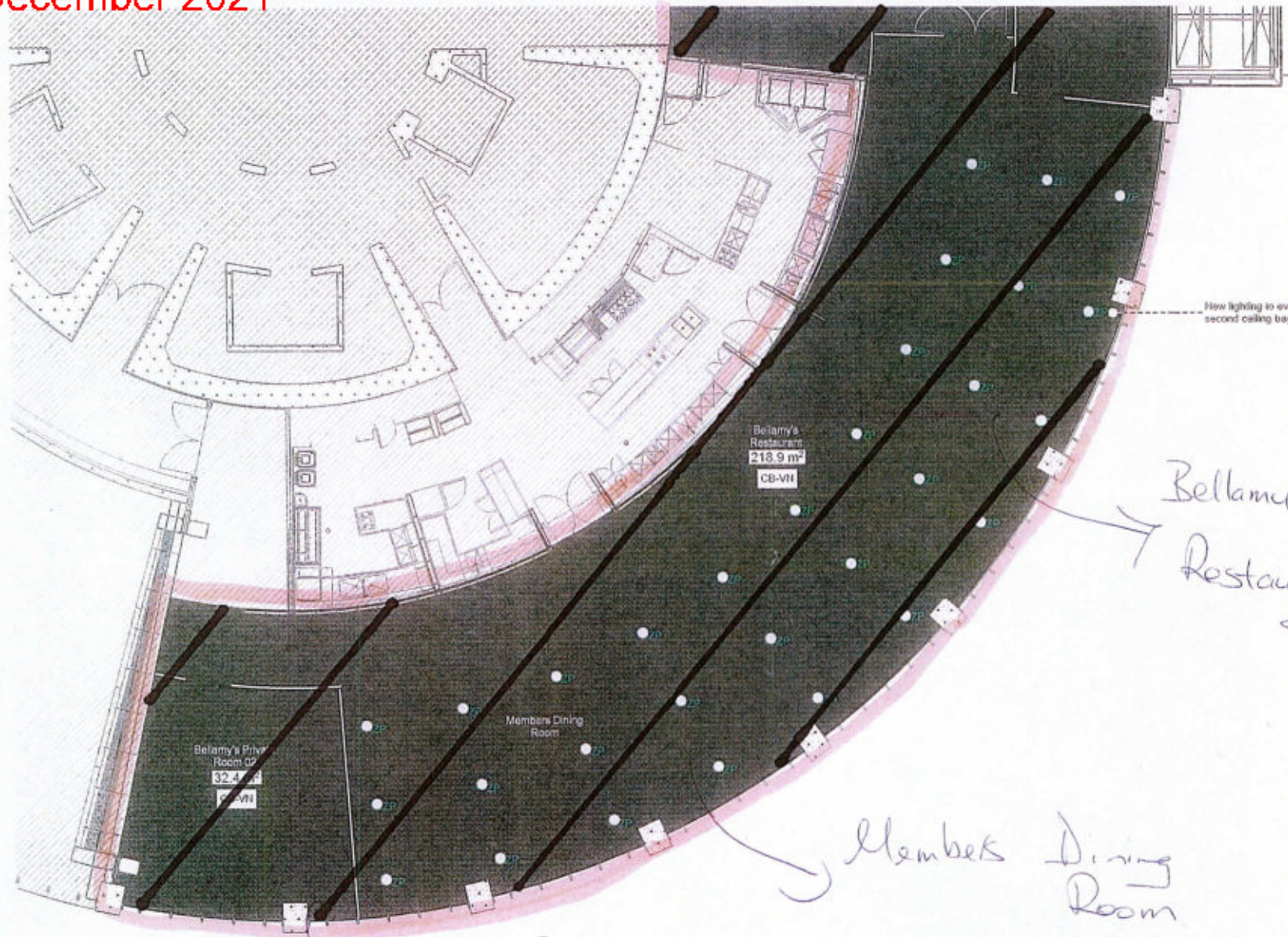

- General Key**
- No work required to this area
  - New full height timber screen
- Floor Finishes Key**
- CT-CM** Carpet Tiles: Charcoal  
Brand: Interface  
Supplier: Inzide  
Product: Colour Me  
Colour: Charcoal  
Pattern: Quarter Turn
  - CB-VII** Carpet Broadloom: Nocturne  
Supplier: Cavalier Bremworth  
Product: Velluto  
Colour: Nocturne
  - VF-SE** Vinyl Flooring: Black  
Brand: Forbo  
Supplier: Inside  
Product: Sphera Element  
Colour: Black 50001
- Lighting Key**
- Pendant Light: PL-1**  
Brand: Resident  
Supplier: Simon James  
Product: Hex 500  
Colour: Black  
Size: 150 x 150 x 180mm
  - Pendant Light: PL-2**  
Brand: ID  
Supplier: Simon James  
Product: Pariah  
Colour: Gold  
Size: 150 x 150 x 200mm
  - Pendant Light: PL-3**  
Brand: ID  
Supplier: Simon James  
Product: Daria  
Colour: Gold  
Size: 150 x 150 x 200mm
  - LED Uplight: U**  
Brand: Modulo  
Product: Dial Fresco 14 recessed into top of pew for wall
  - Pendant Light**  
Brand: Core Lighting  
Supplier: Simon James  
Product: Log Pendant  
Colour: Matt White and Bronze

WELLINGTON CITY COUNCIL  
 PUBLIC HEALTH  
 4 FEB 2019  
 RECEIVE FROM  
 WIREFIELD STATION

Bellamy's  
Private Room

Members Dining Room

Bellamy's Restaurant

Plan 4.

<p><b>General Notes:</b> All dimensions to be checked on site. Copyright in all drawings, specifications and other documents and in the work executed hereon remains the property of Studio of Pacific Architects Ltd. © Studio of Pacific Architects Limited 2017</p>	<p>Rev: Project Stage: 01/11/2018</p>	<p>Date: 20/12/2021</p>	<p>Consultants:</p>	<p><b>studlo Pacific architecture</b> Architects Urban Designers Interior Designers Landscape Architects Level 2 74 Cuba St P.O. Box 11-617 Wellington, NZ TEL: 64 4 982 8844 FAX: 64 4 982 8848 www.studlo.com.nz info@studlo.com.nz</p>	<p>Project Title: <b>Executive Wing F&amp;B Upgrade</b> Parliamentary Service at Museum Street, Wellington for Her Majesty the Queen</p>	<p><b>CONFIDENTIAL</b> Concept Design Draft For Information</p>	<p><b>Level 03 Bellamy's Finishes and Lighting Plan</b></p>
	<p>Scale: 1:100 Drawing No: <b>14-03</b></p>	<p>Orig. Size: A3 Job No: 2333 Revision: A</p>					



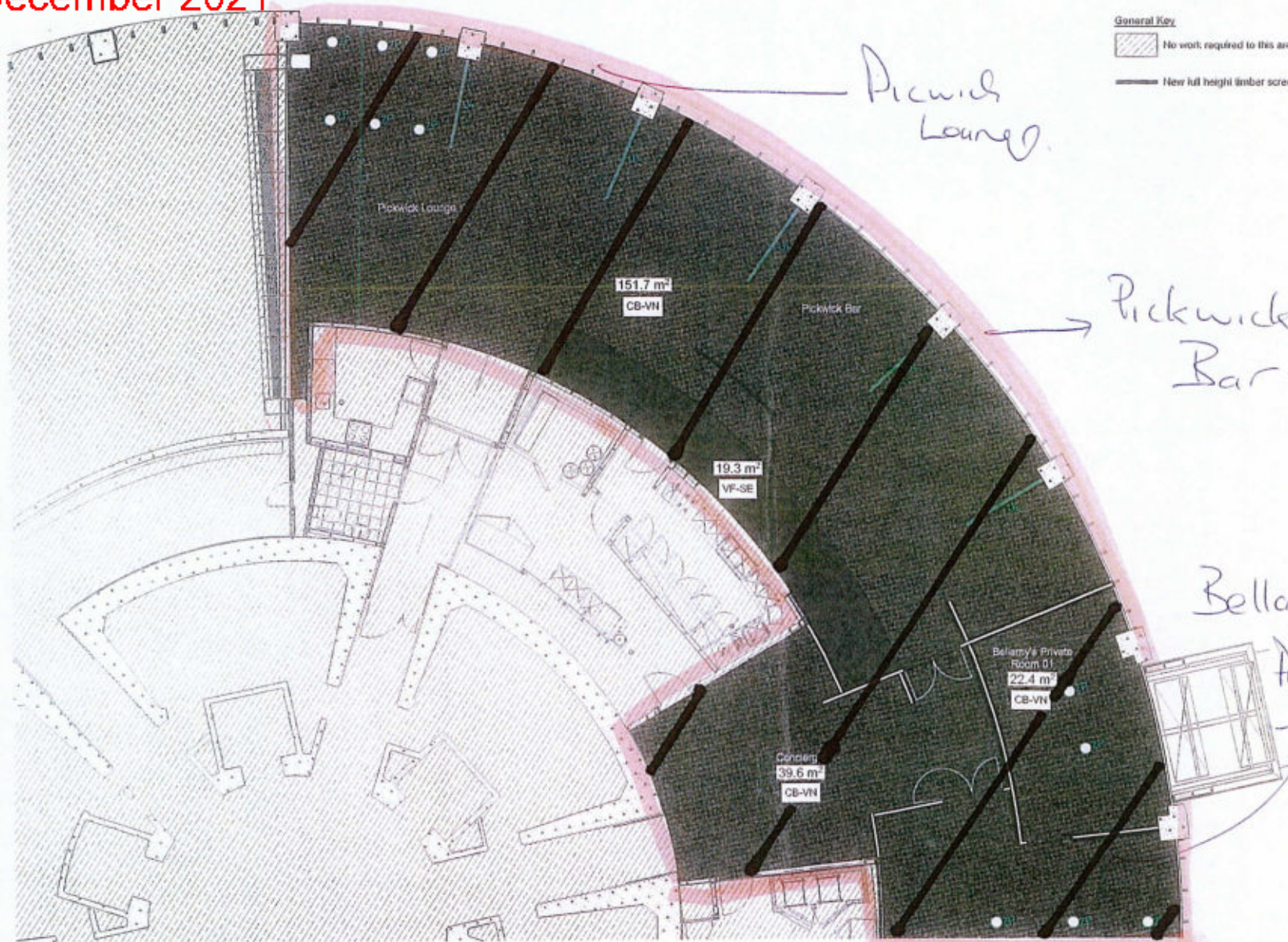

**General Key**  
 No work required to this area  
 New full height timber screen

**Floor Finishes Key**  
**CT-CM** Carpet Tiles: Charcoal  
 Brand: Interface  
 Supplier: Inside  
 Product: Colour Me  
 Colour: Charcoal  
 Pattern: Quarter Turn  
**CB-VN** Carpet Broadloom: Nocturne  
 Supplier: Cavalier Broomworth  
 Product: Velluto  
 Colour: Nocturne  
**VF-SE** Vinyl Flooring: Black  
 Brand: Forbo  
 Supplier: Inside  
 Product: Sphera Element  
 Colour: Black 50001

**Lighting Key**  
**Pendant Light: PL-1**  
 Brand: Resilient  
 Supplier: Simon James  
 Product: Max 500  
 Colour: Black  
 Size: L470 x W550 x H600mm  
**Pendant Light: PL-2**  
 Brand: EOO  
 Supplier: Simon James  
 Product: Branch  
 Colour: Black  
 Size: DIA 270 x H270mm  
**Pendant Light: PL-3**  
 Brand: EOO  
 Supplier: Simon James  
 Product: Branch  
 Colour: Gold  
 Size: DIA 270 x H270mm

**RECEIVED**  
**1 FEB 2019**  
**WATERLOO ST., WELLINGTON**  
**WELLINGTON CITY COUNCIL**  
**PUBLIC HEALTH**

General Note: All dimensions to be checked on site. Copyright in all drawings, specifications and other documents and in the work executed, both then remains the property of Studio of Pacific Architecture Ltd. © Studio of Pacific Architecture Limited 2017

Rev	Project Stage	Date	Comments
1	Concept Design	28/12/2017	Client For Information



**studiopacificarchitecture**  
 Architects  
 Urban Designers  
 Interior Designers  
 Landscape Architects  
 Level 2  
 71 Grafton St.  
 P.O. Box 11-517  
 Wellington, N.Z.  
 Tel: 64 4 292 8424  
 Fax: 64 4 292 8426  
 www.studiopacific.co.nz  
 info@studiopacific.co.nz

**Project Title**  
**Executive Wing F&B Upgrade**  
**Parliamentary Service**  
 At  
 Moterua Street, Wellington  
 507  
 Not Mapping the Coast

<b>CONFIDENTIAL</b>	
<b>Concept Design</b>	
<b>Draft For Information</b>	
<b>Level 03 Pickwicks Finishes and Lighting Plan</b>	
Scale: 1:100	Orig. Size: A1
Drawing No: <b>14-02</b>	Job No: 2333
Revision: <b>A</b>	

Plan 5



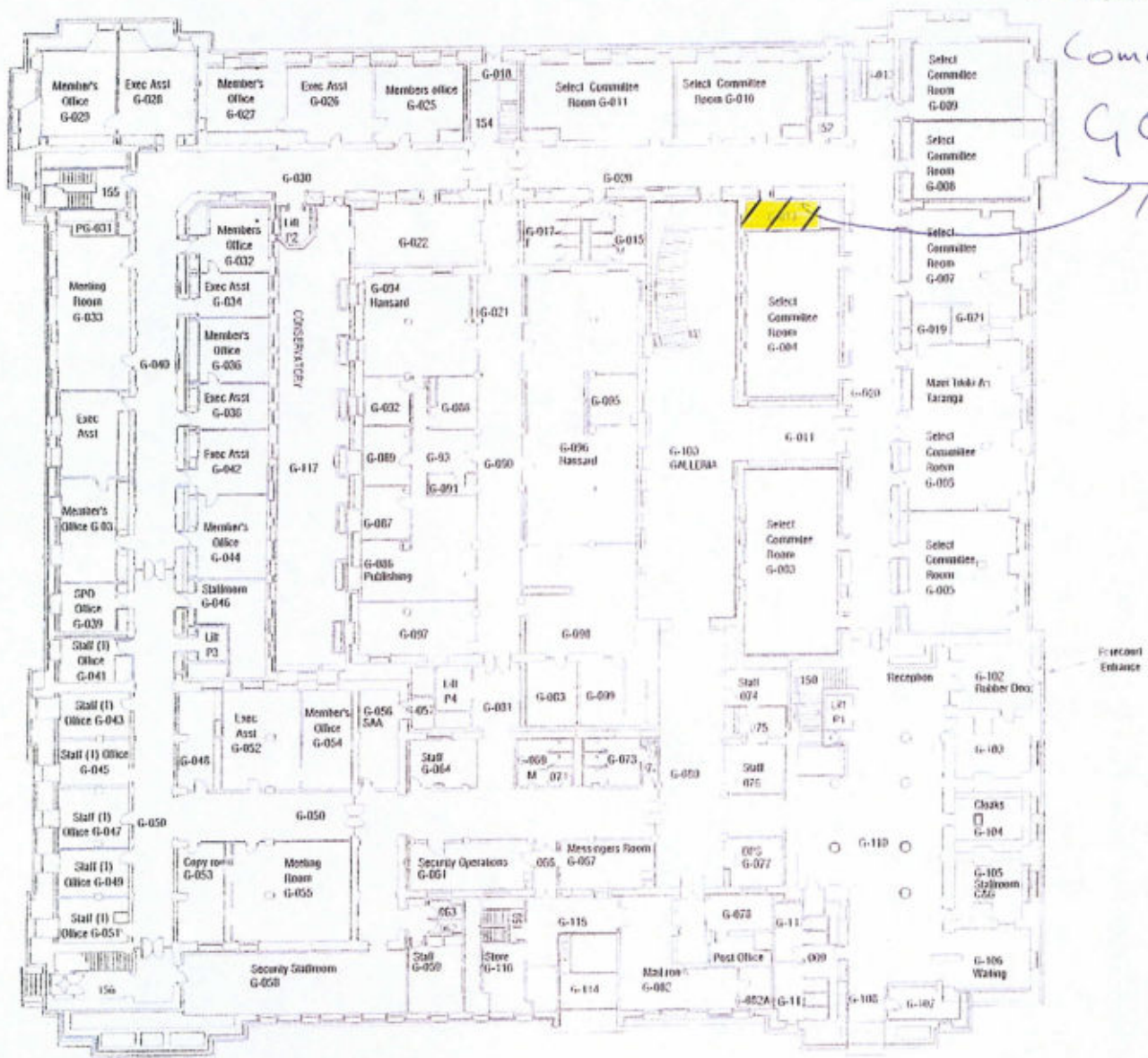

Select  
Committee  
G013

WELLINGTON CITY COUNCIL  
PUBLIC HEALTH  
4 FEB 2019  
RECEIVED  
WAKEFIELD ST., WELLINGTON

General Notes:	
Contributors:	
 <b>Building Projects Branch Parliamentary Service</b> Parliament House Private Bag 1804 Wellington 6160 New Zealand	
Job Title:	Bellamys Floor Plan
Sheet Title:	Parliament House - Ground Floor
Drawn by:	John Selby
Date:	September 2014
Scale:	Not To Scale
File No:	
Job No:	
Drawing No.:	PHG-01
Revision:	

Plan 6

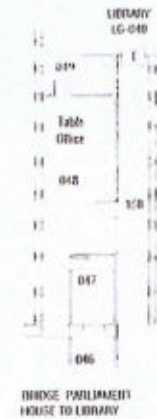
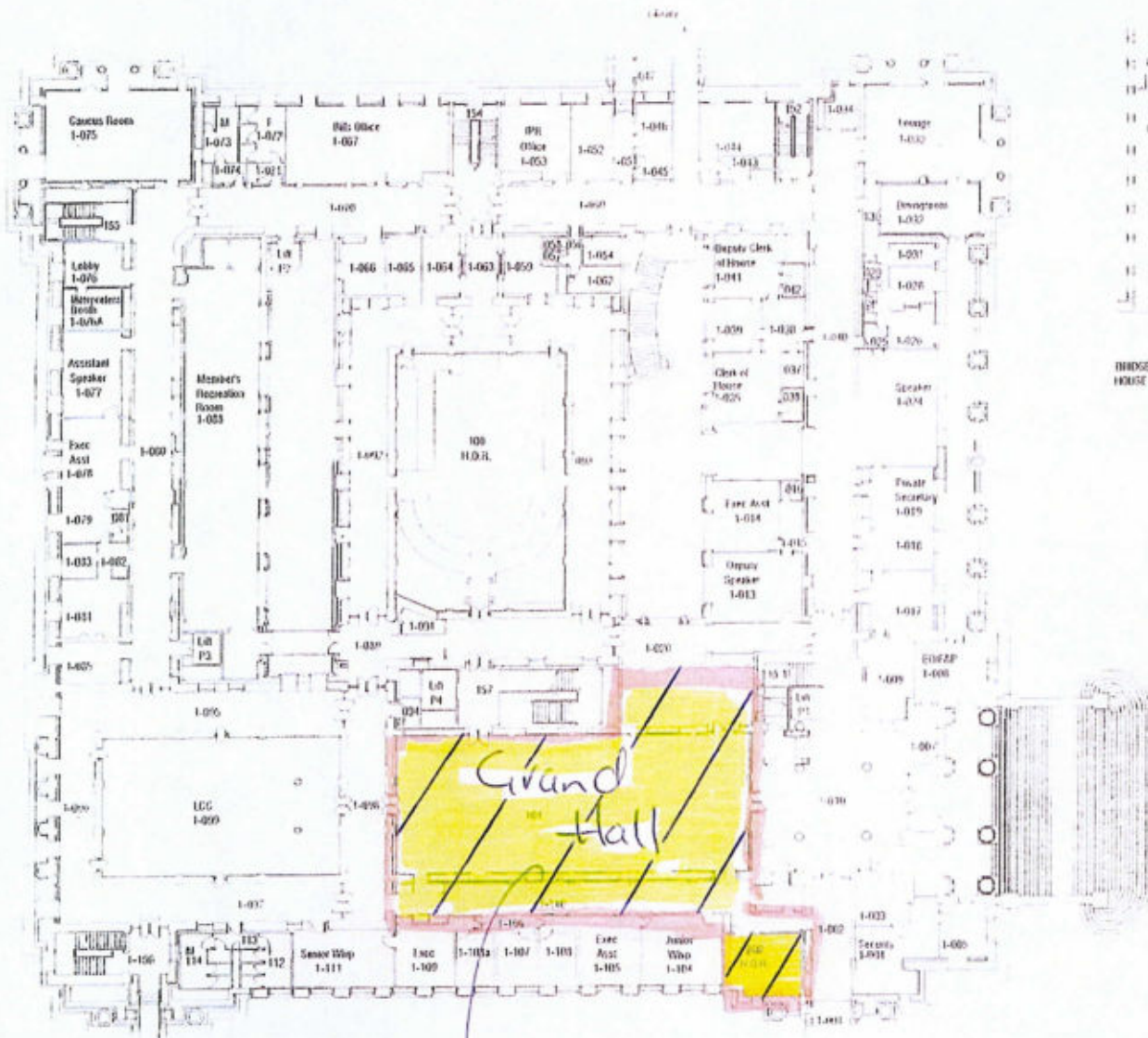

WELLINGTON CITY COUNCIL  
 PUBLIC HEALTH  
 4 FEB 2019  
 RECEIVED  
 WAKEFIELD ST., WELLINGTON

General Notes:	
Consultants:	
 <b>Building Projects Branch Parliamentary Service</b> Parliament House Private Bag 1004 Wellington 6160 New Zealand	
Job Title:	Bellany's Floor Plan
Sheet Title:	Parliament House - Level 1
Drawn by:	John Selby
Date:	September 2014
Scale:	Not To Scale
File No:	
Job No:	
Drawing No.	PHB-01
Revision:	

Grand Hall  
Parliament House

Plan 7