

Copyright of this document belongs to Archaus Architects Limited.
 All dimensions are in millimetres unless otherwise noted.
 Check and verify all dimensions and levels on site prior to work commencing.
 All work to comply with NZBC, NZS-3604 and Local Territorial Authority regulations.
 Drawings to be read in conjunction with all other relevant documentation.
 Do not scale off drawings.

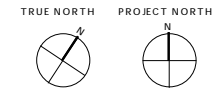

LYALL BAY
SURF & LIFE SAVING CLUB

SITE FEATURES

WIND
THE BASIC WIND PRESSURES ARE TO AS/NZS 1170.2
 SLS 47.0 m/s
 ULS 49.2 m/s

DURABILITY
SEA SPRAY (EXPOSURE ZONE)

SEISMIC
ZONE 3 (EARTHQUAKE ZONE)

WALL TYPES
REFER TO SHEET 12.00 FOR WALL TYPES LEGEND

FLOOR AREA
TRAINING LEVEL INCLUDING PATROL ROOM
 FLOOR AREA 252m²

REV	DATE	INITIAL	AMENDMENT
6	20/09/16	CS	AMENDMENT TO BUILDING CONSENT
5	15/07/13		ISSUED FOR BUILDING CONSENT
4	20/06/13	FK	RE ISSUED FOR TENDER
3	11/02/13	FK	REVISED BUILDING CONSENT
2	28/01/13	FK	ISSUED FOR TENDER
1	10/12/12	FK	ISSUED FOR BUILDING CONSENT

Revisions

Detailed Design

CLIENT
Lyall Bay Surf & Life Saving Club

PROJECT
Proposed New Clubhouse
Lyall Parade, Lyall Bay, Wellington 6022

SHEET TITLE
TRAINING & PATROL FLOOR PLAN

DESIGN	DRAWN	ISSUE DATE
CB	FK	02/28/12

SCALE AT A1 (half scale if printed at A3)
As indicated

PROJECT No. **07072**

SHEET No. **02.02** REVISION **6**

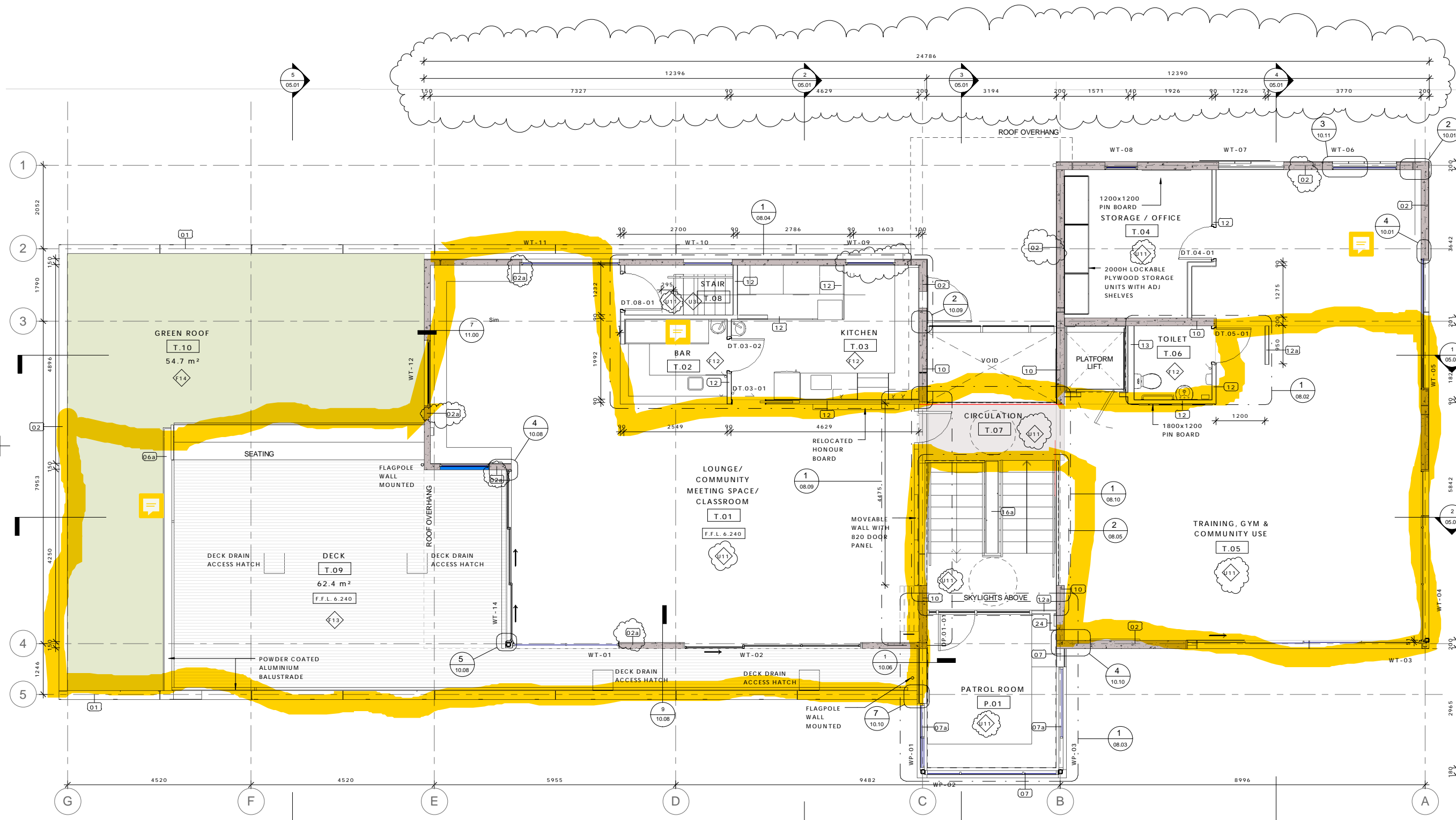

01 Training
SCALE: 1:50

Received
Wellington City Council
1/11/2022

FLOOR FINISHES LEGEND

- U2 CONCRETE FLOATED FINISH SEALED
- U5 CONCRETE SOFT BRUSH FINISH
- U11 CONCRETE GROUND FINISH SEALED
- F10 WATERPROOF LIQUID MEMBRANE
- ~~F11 COMMON OAK TO GUM TIMBER SEALED~~
- F12 SAFETY VINYL
- F13 32mm PINE MERCH GRADE TIMBER DECKING
- F14 GREEN ROOF

archaus

(09) 309 8931 (04) 802 5630 (03) 353 0570
 Auckland Wellington Christchurch
 www.archaus.co.nz