

# Current plans

GENERAL NOTES:

092018

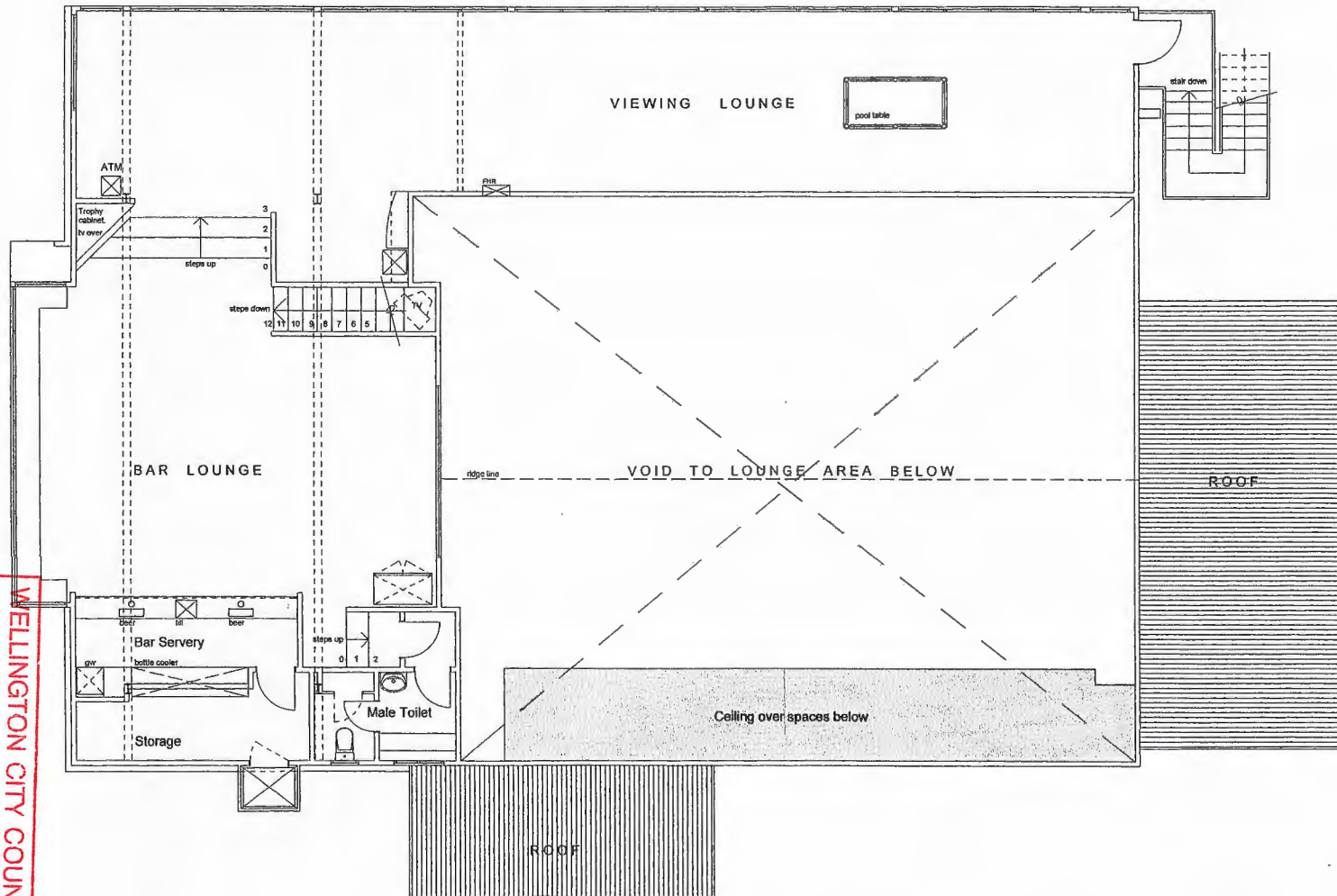

**RECEIVED**  
 WAKEFIELD ST., WELLINGTON  
 7 NOV 2018  
 WELLINGTON CITY COUNCIL  
 PUBLIC HEALTH

## FIRST FLOOR PLAN - AS EXISTING

scale - approx 1 : 100 @ A3  
 [ scan drawing from archived plans ]

REV COMMENT DA

REPRODUCTION OF THE WHOLE OR PART OF THIS DOCUMENT CONSTITUTE AN INFRINGEMENT OF COPYRIGHT WHERE APPROPRIATE PERMITS SHOULD BE OBTAINED. ALL RIGHTS RESERVED.



HERNIM GROUP ARCHITECTS  
 PARTNERS

62 Cambridge T  
 P.O Box 9550 WELLING

New Zealand  
 tel / fax (04) 388 1111  
 Email: pga.ltd@hug

PROJECT:  
 Site Definition  
 Victoria Bowling Club at  
 No. 125 Pirie Street, WELLING

CLIENT:  
 VICTORIA BOWLING CLUB.

SHEET TITLE:  
 As Existing -  
 FIRST FLOOR PLAN.

JOB No.  
**10 : 16 : 1.02**

Date: 02 Dec. 2010 Scale: Approx. 1:100@A3 mmp

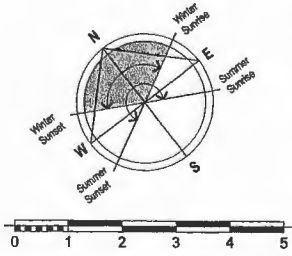

BOWLING GREEN

GENERAL NOTES:

11092018

### Current plans

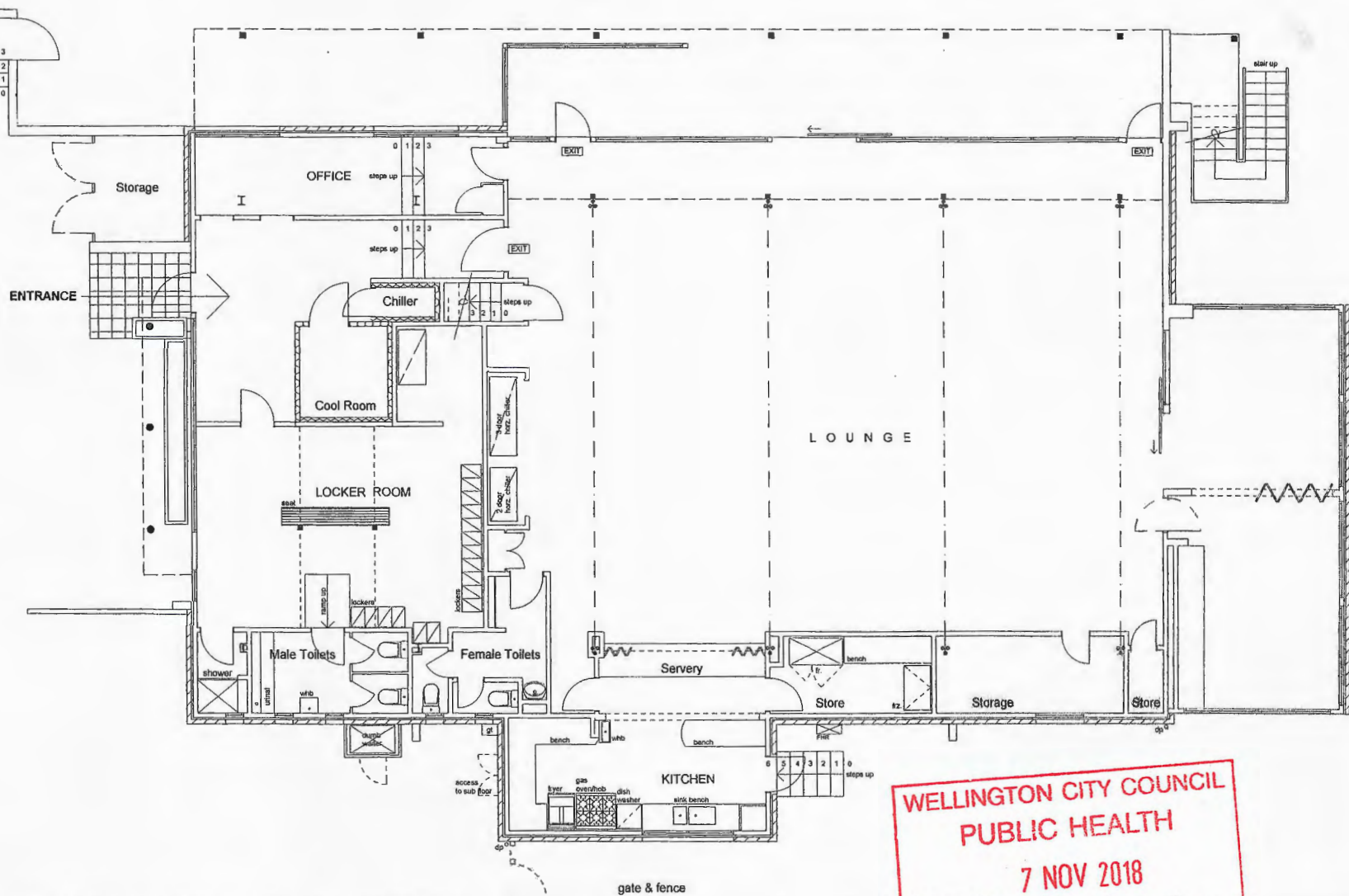

REV	COMMENT	DATE

REPRODUCTION OF THE WHOLE OR PART OF THIS DOCUMENT CONSTITUTES AN INFRINGEMENT OF COPYRIGHT WITHOUT APPROPRIATE PERMISSION. ALL RIGHTS RESERVED.



**PIERCE GROUP ARCHITECTS LIMITED**

62 Cambridge Terrace  
P.O. Box 9550 WELLINGTON.  
6141  
New Zealand  
tel / fax (04) 385.9295  
Email: pga.ltd@hug.co.nz

### GROUND FLOOR PLAN - AS EXISTING

scale - approx 1 : 100 @ A3  
[ scan drawing from archived plans ]

**WELLINGTON CITY COUNCIL  
PUBLIC HEALTH  
7 NOV 2018  
RECEIVED  
WAKEFIELD ST., WELLINGTON**

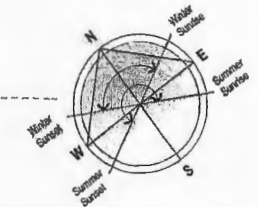

**PROJECT:**  
Site Definition  
Victoria Bowling Club at  
No. 125 Pirie Street, WELLINGTON.  
**CLIENT:**  
VICTORIA BOWLING CLUB.

**SHEET TITLE:**  
As Existing -  
GROUND FLOOR PLAN.

**JOB No.**  
**10 : 16 : 1.01**  
Date: 02 Dec. 2010    Scale: Approx. 1:100@A3 nvp    Drawn By:

# Updated plans showing proposed outdoor areas



**VICTORIA BOWLING CLUB**  
EST. 1896

First Floor Plan

Wellington City Council  
10th of November 2021

Received via email upon  
request

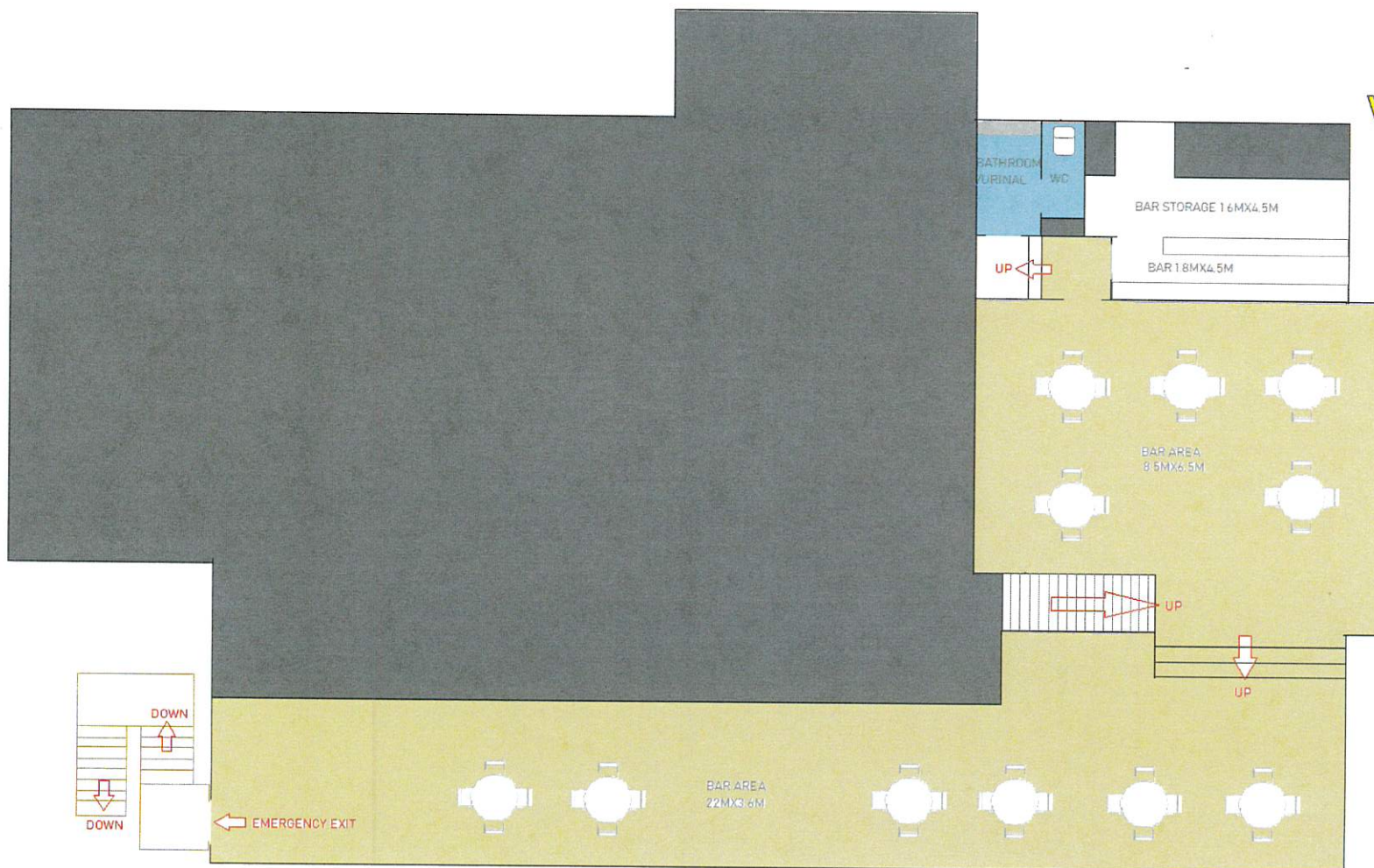

 Licensed Bar Area

# Updated plans showing proposed outdoor areas



## VICTORIA BOWLING CLUB

ESTD. 1896



Ground Floor Plan

Wellington City Council  
10th of November 2021

Received via email upon  
request

Updated plans showing proposed outdoor areas



VICTORIA BOWLING CLUB  
EST. 1935

SITE PLAN

PROPOSED ADDITIONAL LICENSED AREAS SHOWN SHADED

Received  
Wellington City Council  
13/01/2022

