

2 Proposed Ground Floor
1 : 100

Confirmed via email dated
3/11/2022

Floor area 229 m²

Wellington
City Council
Received:
13/10/2022

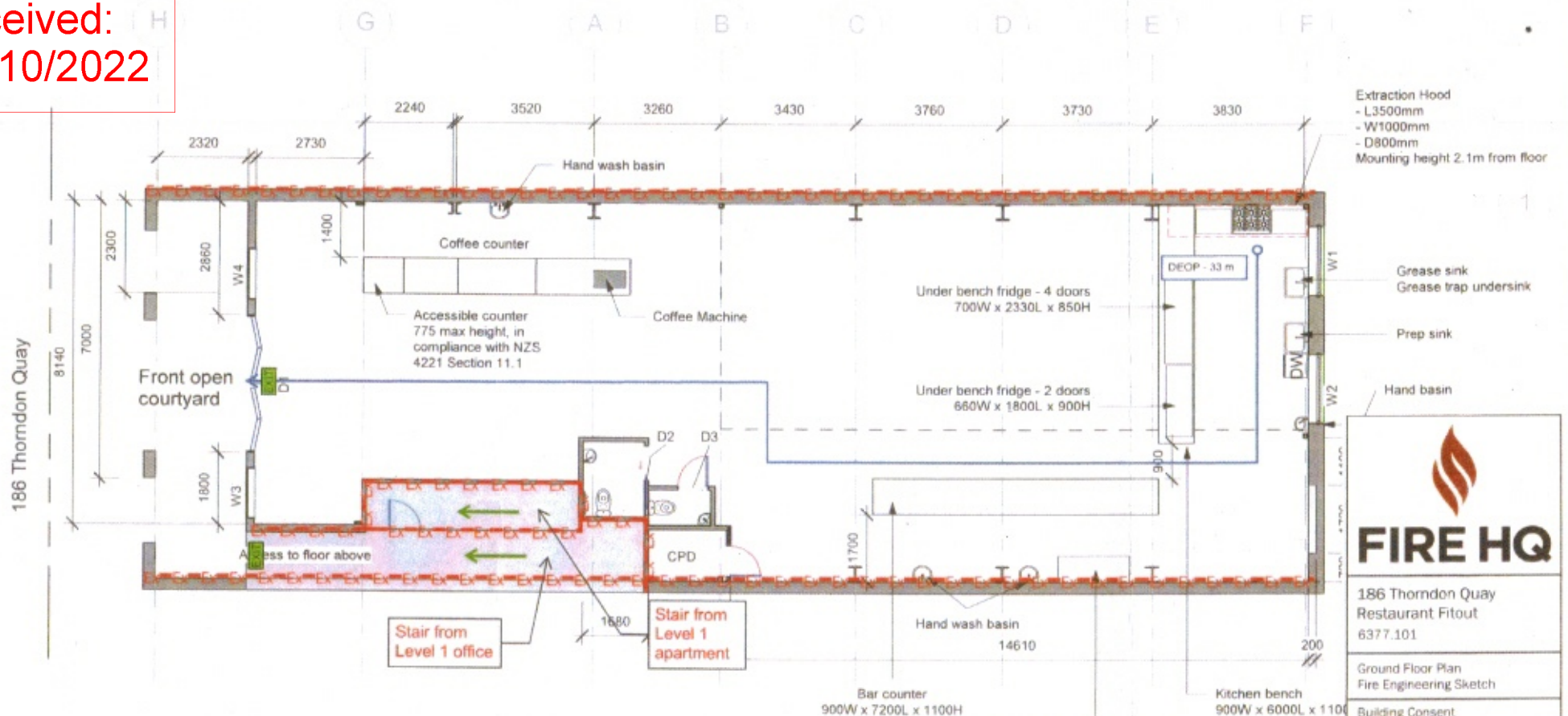

2 Proposed Ground Floor
1 : 100

Floor area 229 m²

LEGENDS
 Existing walls
 New walls

Extraction Hood
 - L3500mm
 - W1000mm
 - D800mm
 Mounting height 2.1m from floor

Grease sink
 Grease trap undersink
 Prep sink
 Hand basin



186 Thorndon Quay
 Restaurant Fitout
 6377.101

Ground Floor Plan
 Fire Engineering Sketch

Building Consent
 Revision A
 Dwg: FES-01 Date: 02/10/17

Legend
 Indicative exit sign location
 Egress route
 Travel distance
 Existing fire rating to be maintained

Notes Refer to SR243975 for Structural Plans	Status Building Consent	Project 186 Thorndon Quay Client: Justin Chang	Address 186 Thorndon Quay LOT 9 DP 1000	Drawing: PROPOSED FLOOR PLAN	Drawn By: AN	Date 17/06/17
					Checked By: -	Sheet No: 1.03
						Drawn Scale: 1 : 100