

GENERAL NOTES

All works shown or implied to be carried out in strict accordance with the New Zealand Building Code.

All public safety orientated fixtures and fittings, including fire detection and suppression devices, signage, lighting, egress ways to remain fully operational throughout the duration of the fit out. Refer to Spencer Holmes Fire Report.

All electrical work to be carried out in accordance with the NZBC and Local Body requirements.

All dimensions to be checked on site prior to any work commencing.

These drawings are to be read in conjunction with the Scope Of Works Document, Specifications and Consultant's Packages.

WALL LEGEND

Typically 90x45 H1.2 treated timber framing at 400mm crs for any new partitions. 2/90x45 at 300mm crs for extended walls along front of bathrooms as per the drawings. Top and bottom plates to be fixed into existing structure in accordance with NZ Standards. DPC under bottom plate if directly installed on concrete slab. Additional timber blocking in walls where joinery fixtures are to be mounted. Trims and skirtings are to be as per Detail Documentation and Notes.

Autex Acoustic insulation to be installed into walls around the toilet block. Refer Specification.

All walls to have 13mm Gib Noiseline (dry areas) / Aqualine (wet areas) plasterboard stopped to an F4 Finish. Refer to Finishes Plans for Decorating or any feature panel requirements.

SERVICES LEGEND

Power outlet.
E = existing
N = new
x = number of power outlets.

Data outlet.
E = existing
N = new
x = number of outlets.

Alarm Panel. Refer to SOW Document for Security Requirements.

Electrical Board. To be upgraded based on Electrician assessment of existing board against imposed electrical load.

Any unrequired outlets are to be decommissioned accordingly.

Lighting circuits and associated switching is to be as per the RCPs.

Cameras / Security System to be designed by security sub-contractor. To be coordinated in AFC Documentation. Refer SOW Document for more information.

Technology and any other equipment is to be arranged directly by Client. Contractor to allow to coordinate as required.

FURNITURE / JOINERY LEGEND

- [F-BAR] Front Bar Joinery Unit. Refer to Detailed Drawings.
- [B-BAR] Back Bar Joinery Unit. Refer to Detailed Drawings.
- [PREP.] Preparation Benches. Refer to Detailed Drawings.
- [FU.01] Inbuilt upholstered bench seats. Refer to Detailed Drawings.
- [FU.02] 600mm dia acrylic laminated 25mm table top on powder coated steel round base. Refer to SOW Document.
- [FU.03] Upholstered dining chair 'A' with powder coated legs. Refer to SOW Document.
- [FU.04] 1800 x 600 acrylic laminated 25mm table top on powder coated steel leaner substructure. Refer to SOW Document.
- [FU.05] Upholstered bar stool 'A' with powder coated legs. Refer to SOW Document.
- [FU.06] 1250 x 600 acrylic laminated 25mm table top on powder coated steel leaner substructure. Refer to SOW Document.
- [FU.07] Upholstered bar stool 'B' with powder coated legs. Refer to SOW Document.
- [FU.08] 900mm dia acrylic laminated 25mm table top on powder coated steel round base. Refer to SOW Document.
- [FU.09] Upholstered dining chair 'B' with powder coated legs. Refer to SOW Document.
- [FU.11] Staff Workstation and Task Chair. Refer to SOW Document.
- [FU.12] Staff Lockers. Refer to SOW Document.



PO Box 27 517, Marlon Square
Level 1, 85 The Terrace, Wellington, NZ
T 04 801 7134
interact@interactarchitects.co.nz

All dimensions to be checked on site before commencing work

Rev #	Description
0	ISSUED FOR BUILDING CONSENT
A	ISSUED FOR BUILDING CONSENT R1 - ACCESSIBLE COUNTER REVISED

Project
KUIKUI GIN BAR

TENANCY 6,
118 VICTORIA ST,
WELLINGTON.

Title:
**PROPOSED
GROUND
GENERAL ARR.
PLAN**

Folder: 202071
Design:
Drawn:
Date: JANUARY 2021
Scale: 1:50
Drawing No: Rev:

A-102 A

01 PROPOSED GROUND G.A PLAN 1:50

**Wellington City Council
28 May 2021**

GENERAL NOTES

All works shown or implied to be carried out in strict accordance with the New Zealand Building Code.

All public safety orientated fixtures and fittings, including fire detection and suppression devices, signage, lighting, egress ways to remain fully operational throughout the duration of the fit out. Refer to Spencer Holmes Fire Report.

All electrical work to be carried out in accordance with the NZBC and Local Body requirements.

All dimensions to be checked on site prior to any work commencing.

These drawings are to be read in conjunction with the Scope of Works Document, Specifications and Consultant's Packages.

WALL LEGEND

Typically 90x45 H1.2 treated timber framing at 400mm crs for any new partitions. 2/90x45 at 300mm crs for extended walls along front of bathrooms as per the drawings. Top and bottom plates to be fixed into existing structure in accordance with NZ Standards. DPC under bottom plate if directly installed on concrete slab. Additional timber blocking in walls where joinery fixtures are to be mounted. Trims and skirtings are to be as per Detail Documentation and Notes.

Autex Acoustic insulation to be installed into walls around the toilet block. Refer Specification.

All walls to have 13mm Gib Noiseline (dry areas) / Aqualine (wet areas) plasterboard stopped to an F4 Finish. Refer to Finishes Plans for Decorating or any feature panel requirements.

SERVICES LEGEND

Power outlet.
 E = existing
 N = new
 x = number of power outlets.

Data outlet.
 E = existing
 N = new
 x = number of outlets.

Alarm Panel. Refer to SOW Document for Security Requirements.

Electrical Board. To be upgraded based on Electrician assessment of existing board against imposed electrical load.

Any unrequired outlets are to be decommissioned accordingly.

Lighting circuits and associated switching is to be as per the RCPs.

Cameras / Security System to be designed by security sub-contractor. To be coordinated in AFC Documentation. Refer SOW Document for more information.

Technology and any other equipment is to be arranged directly by Client. Contractor to allow to coordinate as required.

All dimensions to be checked on site before commencing work

Date 22.01.21

Rev # Description
 0 ISSUED FOR BUILDING CONSENT

Project
KUIKUI GIN BAR
 TENANCY 6,
 118 VICTORIA ST,
 WELLINGTON.

Title:
**PROPOSED
 MEZZANINE
 GENERAL ARR.
 PLAN**

Folder: 202071
 Design:
 Drawn:
 Date: JANUARY 2021
 Scale: 1:50 ©A3
 Drawing No: Rev:

A-103 0

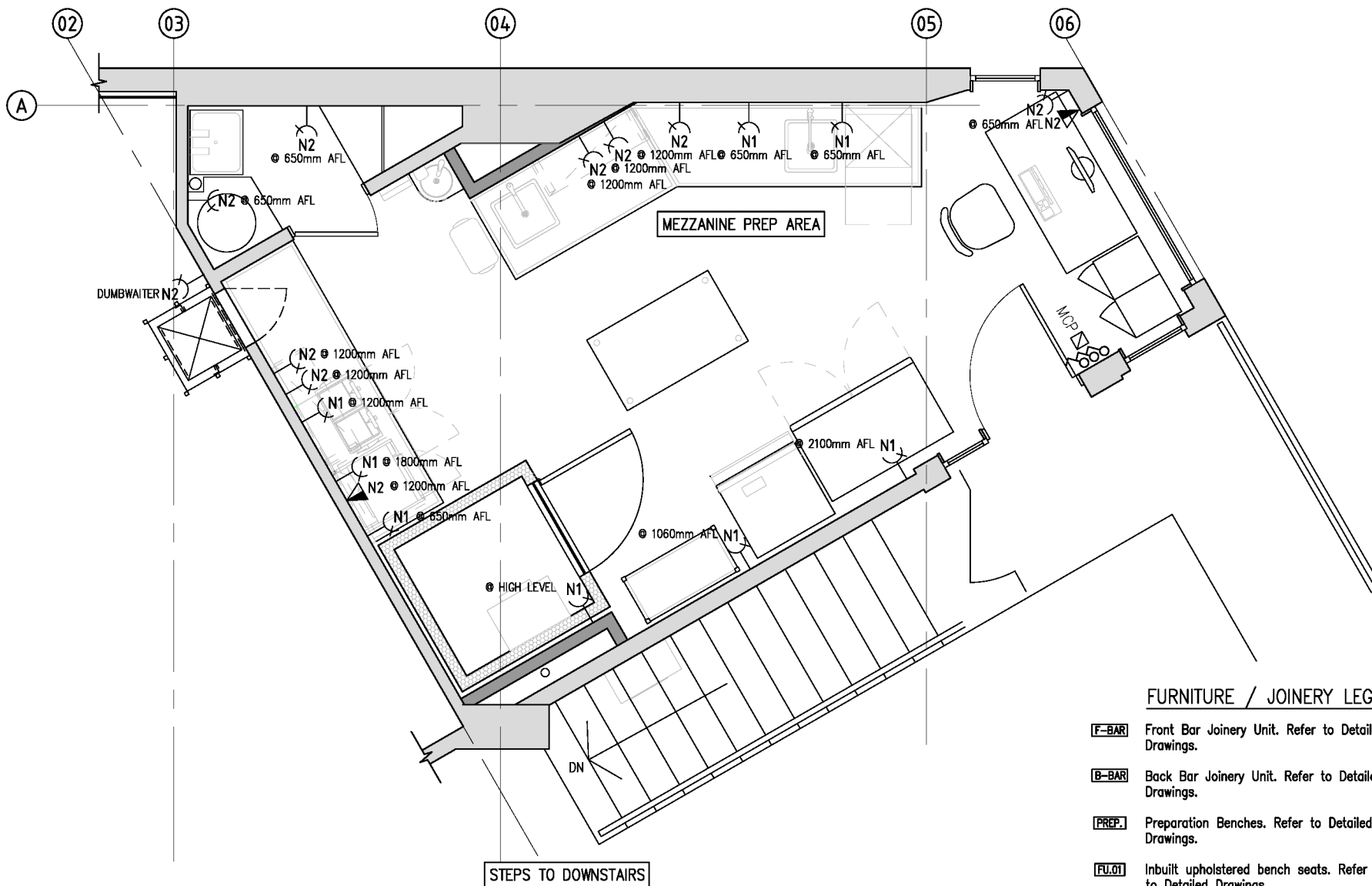

FURNITURE / JOINERY LEGEND

- [F-BAR]** Front Bar Joinery Unit. Refer to Detailed Drawings.
- [B-BAR]** Back Bar Joinery Unit. Refer to Detailed Drawings.
- [PREP.]** Preparation Benches. Refer to Detailed Drawings.
- [FU.01]** Inbuilt upholstered bench seats. Refer to Detailed Drawings.
- [FU.02]** 600mm dia acrylic laminated 25mm table top on powder coated steel round base. Refer to SOW Document.
- [FU.03]** Upholstered dining chair 'A' with powder coated legs. Refer to SOW Document.
- [FU.04]** 1800 x 600 acrylic laminated 25mm table top on powder coated steel leaner substructure. Refer to SOW Document.
- [FU.05]** Upholstered bar stool 'A' with powder coated legs. Refer to SOW Document.
- [FU.06]** 1250 x 600 acrylic laminated 25mm table top on powder coated steel leaner substructure. Refer to SOW Document.
- [FU.07]** Upholstered bar stool 'B' with powder coated legs. Refer to SOW Document.
- [FU.08]** 900mm dia acrylic laminated 25mm table top on powder coated steel round base. Refer to SOW Document.
- [FU.09]** Upholstered dining chair 'B' with powder coated legs. Refer to SOW Document.
- [FU.11]** Staff Workstation and Task Chair. Refer to SOW Document.
- [FU.12]** Staff Lockers. Refer to SOW Document.

01 PROPOSED MEZZ. G.A PLAN
 1:50



Wellington City Council
 28 May 2021